

**AR5001D EXPLODED VIEW**

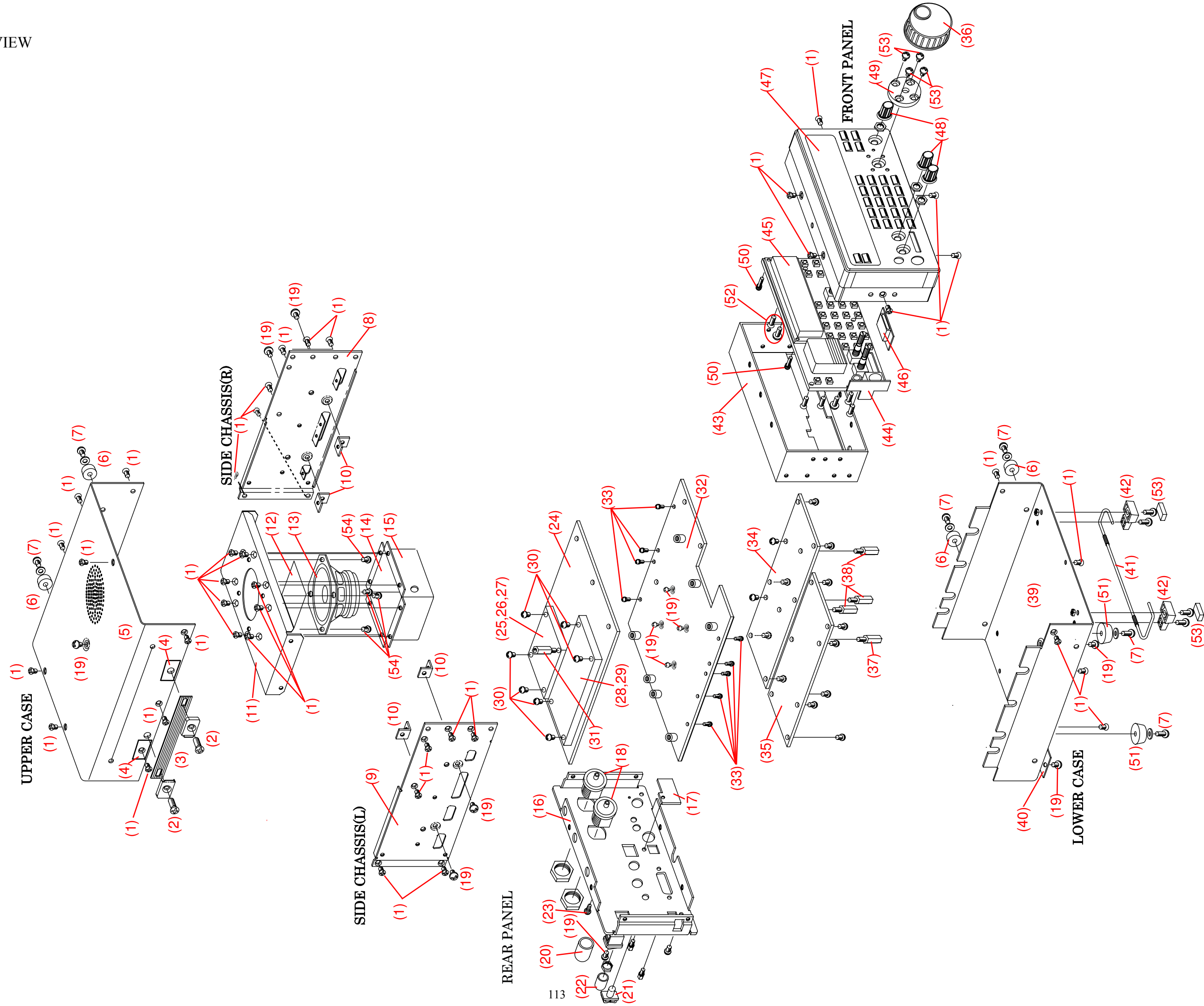

## 6-1 Mechanical Parts List

Mechanical Parts (See exploded view.)

Ref.	Parts	Description	Qty.
1	M2.6 x 5 Flat head screw	FF-2605EB	40
2	M4x 12 Flat head screw	FF-0412N	2
3	Handle	THA-318-1	1
4	Protective sheet	BMA-B-M1-AR5001D-HANDLE-SH	2
5	Upper cover	BMA-B-M1-AR5001D-UP-CASE	1
6	Rubber foot	A-P2	4
7	M3 x 10 Binding head screw	F0310N-P2	6
8	Sub-chassis / Right side	BMA-B-M1-AR5001D-SIDE-CHAS(R)	1
9	Sub-chassis / Left side	BMA-B-M1-AR5001D-SIDE-CHAS(L)	1
10	Stay	BSA-B-M1-AR2300-STAY	2
11	Speaker Mounting Plate	BMA-B-M1-AR5001D-SPSTAY	1
12	Nonwovens sheet	BMA-B-M1-AR5001D-HIMELON	1
13	Speaker unit	F66A52-5	1
14	Acoustic sound absorber		1
15	Speaker holder	BMA-B-M1-AR5001D-SPHOLDER	1
16	Rear panel assembly	BMA-B-M1-AR5001D-REARAssy	1
17	Cover plate - SW	BSA-B-M1-AR2300-HIDEPANEL	1
18	Antenna connector cable assembly	CAM002DHAACK0007-A	2
19	M3 x 4 Binding crew	FB-0304EB	13
20	Dustcover - BNC	VCP-9-04	1
21	Cable holder	PL-20B	1
22	Dustcover - SMA	VCP-6-04	1
23	M3 x 8 P-Tight screw	FPP-0308EB	1
24	RFU main circuit board		1
25	2R5 Circuit board		1
26	FR4 Circuit board		1
27	RFU High Front, shield sheet	BSA-B-M1-AR2300-RFU-HF-SH	1
28	Filter circuit board		1
29	Shield plate for RFU FILTER circuit board	BSA-B-M1-AR2300-RFU-FI-SH	1
30	M3 x 5 S1 Set screw	F-0305E-S1	22
31	M3 x 34 Spacer	BSB-334E	1
32	Mother circuit board		1
33	M2.6 x 5 S1 Set screw	F-2605E-S1	12
34	Decoder circuit board		1
35	Controller circuit board		1
36	Main dial knob	BMA-B-E1-AR5001D-MAIN-KNOB	1
37	M3 x 19 Spacer	BSB-319E	1
38	M3 x 14 Spacer	BSB-314E	3
39	Bottom Cover	BMA-B-M1-AR5001D-UND-CASE	1
40	Cover plate - SW	BMA-B-M1-AR5001D-SWHIDE	1
41	Stand-bar	L=190	1
42	Stand-bar mounting foot	Foot for CT-bar	2
43	Frame	BMA-B-M1-AR5001D-SEPCASE	1
44	Sub-circuit board assembly		1
45	Panel circuit board		1
46	SD Card circuit board		1
47	Escathion	BMA-B-M1-AR5001D-FRONTES	1
48	Sub-Dial knob	BMA-B-E1-AR5001D-SUB-KNOB	1
49	Shaft pillow block	BMA-B-M1-AR5001D-SHAFTGUIDE	1
50	M x 12 S1 Set screw	F-0212E-S1	2
51	Rubber Foot	A-P5	2
52	M3 x 8 S1 Set screw	F-0308E-S1	7
53	M3 x 8 Binding screw	FB0308ED	8
54	M3 x 4 S2 Set screw	F-0304E-S2	4