

SABER/SIGMA/S200 SOFTWARE UPDATE

Document: TYPE 1 Documentation sheets
Ref: DKAP0168.WPS

11/1/93

Please check the contents of this update Pack. You should have:

An EPROM (SABER/SIGMA/S200, V4.03),
Installation instructions (attached to this document).

If you do not have these parts then please inform your supplier.

The installation of the new EPROM can easily be carried out by a non technical person. If for any reason you do not feel confident about undertaking the work, then call your supplier's technical support line, they will be able to offer further assistance.

Mention of 'S200' series consoles refers to three products: The ACE, The SABER 8, and the SPECTRUM. If you have one of these then sections marked 'S200' are for your attention.

NB. ALWAYS - Before removing the old EPROM check the orientation with the supplied installation instructions to ensure full understanding.

The following pages detail the differences in the new software and the installation procedures for the three models: SABER, SIGMA, & S200's.

V4.03 SOFTWARE details

1. The update software improves on the existing Note on/Note off MIDI implementation. A mute press will transmit only note on codes. A message pair is sent using running status:

9n,cc,ss,cc,00

where n is the MIDI channel number

cc is the console channel number and,

ss is the state of the mute -

(1-3F = mute off, 40-7F = mute on)

2. The console now powers up in mode 6 - MIDI off, auto-increment off.
3. Various timing problems with regard to chasing have been tightened up.

SABER EPROM Installation

The new software is totally backwardly compatible with your current version. The installation process will destroy any patches or songs you have in memory. If these are required make sure you dump them to an external system before you start the installation.

The SABER Micro is located behind the master panel (M350). Slide off the write on strip. Remove the M350 module and at least four other modules to the left. This should allow enough room to give reasonable access to the inside back panel. The EPROM is housed in position IC2 (see PCB overlay drawing).

Note the orientation of the existing EPROM (see overlay). Remove with a screw driver or similar and replace with the new.

The most common problems are bent pins and misaligned pins.

When the M350 master module is back in place, power on the console whilst holding down the clear key. This will typically require two people. Turning on the system in this way initiates a total reset and removes any evidence of the previous version.

The display should show a single, non flashing zero. try a couple of mutes and patch recalls. The console powers up in mode 6, do not expect the display to auto-increment.

**A&H**

A&H SOFTWARE, BIRMINGHAM, U.K.

MANUFACTURERS

A&H SOFTWARE, 100, BRISTOL ROAD, BIRMINGHAM, B2 4JG, U.K.

TELEPHONE: 0121 712 1111 FAX: 0121 712 1112

E-MAIL: SALES@A&H.CO.UK

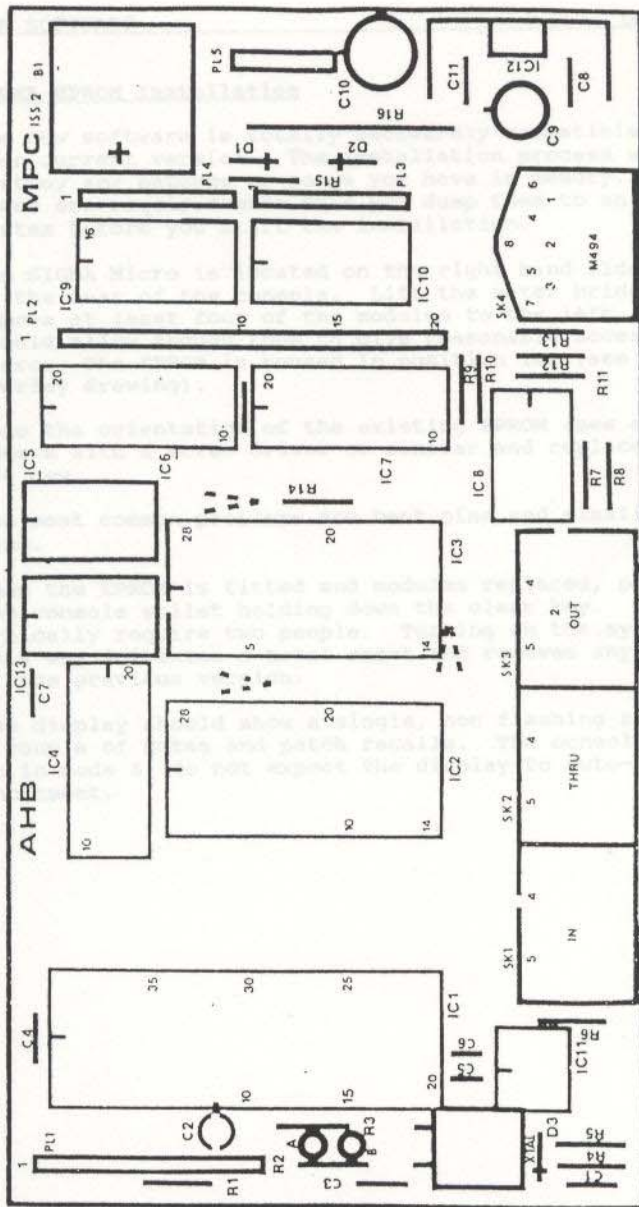

AHB

ALLEN & HEATH BRENELL LTD

PROFESSIONAL AUDIO EQUIPMENT
MANUFACTURERS

DESIGN DEPT 69 SHIP STREET, BRIGHTON BN1 1AE Tel 02733 2628
FACTORY KENNICK INDUSTRIAL EST PENRYN CORNWALL Tel 03261 72070

DRAWING No.

Issue

MUTE PROCESSOR COMPUTER PCB ASSEMBLY

SERIES 200 EPROM Installation

This guide covers all the following products:

SABER 8
SPECTRUM
ACE

The new software is totally backwardly compatible with your current version. The installation process will destroy any patches or songs you have in memory. If these are required make sure you dump them to an external system before you start the installation.

The S200 Micro is located on the underneath of the master panel(M250). Remove the write on strip. Remove the M250 module and turn the module up-side down. The Micro is then clearly visible and the position of the EPROM (IC2, see PCB overlay drawing).

Note the orientation of the existing EPROM (see overlay). Remove with a screw driver or similar and replace with the new.

The most common problems are bent pins and misaligned pins.

When the M250 master module is back in place, power on the console whilst holding down the clear key. This will typically require two people. Turning on the system in this way initiates a total reset and removes any evidence of the previous version.

The display should show a single, non flashing zero. try a couple of mutes and patch recalls. The console powers up in mode 6, do not expect the display to auto-increment.

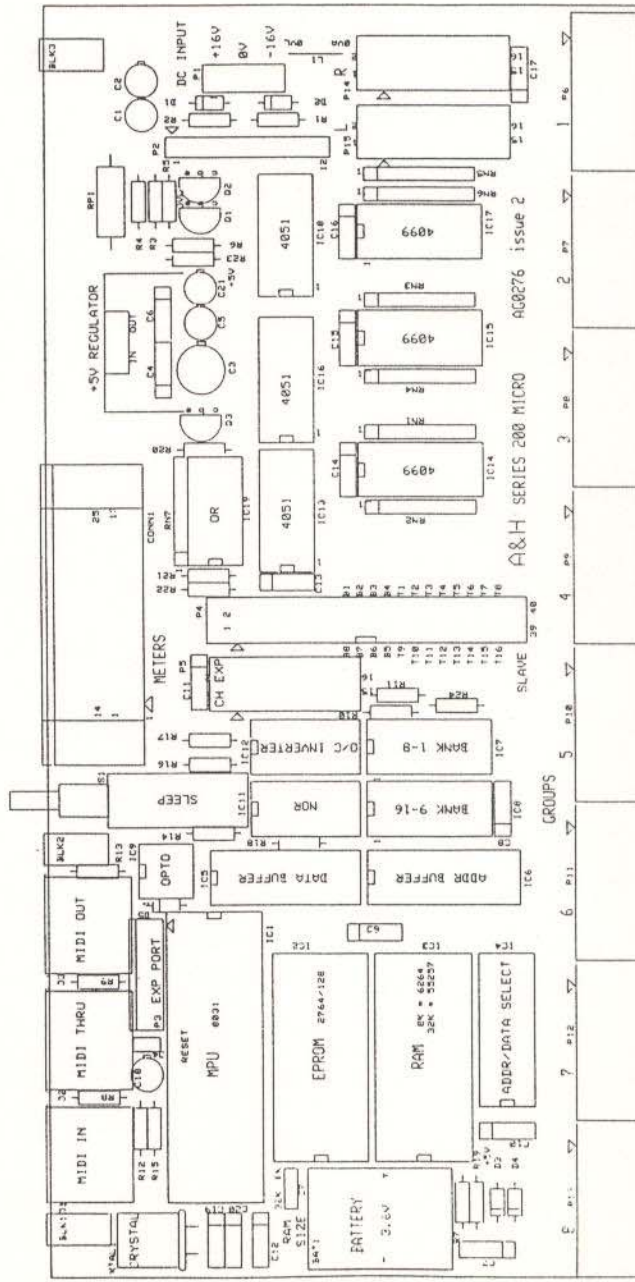

F40290 COMPONENT PRINT BY CD 5-12-90 A&H 0326 72878

GROUPS 1 2 3 4 5 6 7