

CH/GAIN SEL
 REVERB
 GAIN SELECT
 CH SWITCH

NOTES
 1) CAUTION: SHOCK HAZARD!
 THIS UNIT CONTAINS HAZARDOUS VOLTAGE. DISCONNECT POWER AND BE SURE POWER SUPPLY IS DISCHARGED BEFORE TOUCHING INTERNAL PARTS.
 2) UNLESS NOTED, RESISTOR VALUES IN OHMS, 1/4W-5% TOL. CAPACITOR VALUES IN MICROFARADS, 50V-10% TOL.
 3) VOLTAGES ARE MEASURED WITH 1 MEGOHM OSCILLOSCOPE AND 10 MEGOHM DIGITAL VOLT METER.
 4) CHASSIS GROUND SIGNAL GROUND CIRCUIT GROUND

CAUTION:
 THIS SCHEMATIC IS PROVIDED FOR USE BY QUALIFIED PERSONNEL TO AVOID RISK OF ELECTRICAL SHOCK. REFER SERVICING TO QUALIFIED SERVICE PERSONNEL. DO NOT PERFORM ANY SERVICING BEYOND THAT IN THE OPERATING INSTRUCTIONS.

REV	DATE	BY	CHK'D	DESCRIPTION
1	10/11/96	REM	OK	CHG'D J35, J40, TO 17-984-01 PER E360318
2	12/06/96	REM	OK	CHG'D J35, J40, TO 17-984-01 PER E360318
3	02/26/97	REM	OK	VALUES CHG ADD CIRCUIT PER E370097-7/8
4	07/30/97	SWR	OK	ADDED J35, J37, R33A, R33B, R33C, R33D, R33E, R33F, R33G, R33H, R33I, R33J, R33K, R33L, R33M, R33N, R33O, R33P, R33Q, R33R, R33S, R33T, R33U, R33V, R33W, R33X, R33Y, R33Z, R33AA, R33AB, R33AC, R33AD, R33AE, R33AF, R33AG, R33AH, R33AI, R33AJ, R33AK, R33AL, R33AM, R33AN, R33AO, R33AP, R33AQ, R33AR, R33AS, R33AT, R33AU, R33AV, R33AW, R33AX, R33AY, R33AZ, R33BA, R33BB, R33BC, R33BD, R33BE, R33BF, R33BG, R33BH, R33BI, R33BJ, R33BK, R33BL, R33BM, R33BN, R33BO, R33BP, R33BQ, R33BR, R33BS, R33BT, R33BU, R33BV, R33BW, R33BX, R33BY, R33BZ, R33CA, R33CB, R33CC, R33CD, R33CE, R33CF, R33CG, R33CH, R33CI, R33CJ, R33CK, R33CL, R33CM, R33CN, R33CO, R33CP, R33CQ, R33CR, R33CS, R33CT, R33CU, R33CV, R33CW, R33CX, R33CY, R33CZ, R33DA, R33DB, R33DC, R33DD, R33DE, R33DF, R33DG, R33DH, R33DI, R33DJ, R33DK, R33DL, R33DM, R33DN, R33DO, R33DP, R33DQ, R33DR, R33DS, R33DT, R33DU, R33DV, R33DW, R33DX, R33DY, R33DZ, R33EA, R33EB, R33EC, R33ED, R33EE, R33EF, R33EG, R33EH, R33EI, R33EJ, R33EK, R33EL, R33EM, R33EN, R33EO, R33EP, R33EQ, R33ER, R33ES, R33ET, R33EU, R33EV, R33EW, R33EX, R33EY, R33EZ, R33FA, R33FB, R33FC, R33FD, R33FE, R33FF, R33FG, R33FH, R33FI, R33FJ, R33FK, R33FL, R33FM, R33FN, R33FO, R33FP, R33FQ, R33FR, R33FS, R33FT, R33FU, R33FV, R33FW, R33FX, R33FY, R33FZ, R33GA, R33GB, R33GC, R33GD, R33GE, R33GF, R33GG, R33GH, R33GI, R33GJ, R33GK, R33GL, R33GM, R33GN, R33GO, R33GP, R33GQ, R33GR, R33GS, R33GT, R33GU, R33GV, R33GW, R33GX, R33GY, R33GZ, R33HA, R33HB, R33HC, R33HD, R33HE, R33HF, R33HG, R33HH, R33HI, R33HJ, R33HK, R33HL, R33HM, R33HN, R33HO, R33HP, R33HQ, R33HR, R33HS, R33HT, R33HU, R33HV, R33HW, R33HX, R33HY, R33HZ, R33IA, R33IB, R33IC, R33ID, R33IE, R33IF, R33IG, R33IH, R33II, R33IJ, R33IK, R33IL, R33IM, R33IN, R33IO, R33IP, R33IQ, R33IR, R33IS, R33IT, R33IU, R33IV, R33IW, R33IX, R33IY, R33IZ, R33JA, R33JB, R33JC, R33JD, R33JE, R33JF, R33JG, R33JH, R33JI, R33JJ, R33JK, R33JL, R33JM, R33JN, R33JO, R33JP, R33JQ, R33JR, R33JS, R33JT, R33JU, R33JV, R33JW, R33JX, R33JY, R33JZ, R33KA, R33KB, R33KC, R33KD, R33KE, R33KF, R33KG, R33KH, R33KI, R33KJ, R33KL, R33KM, R33KN, R33KO, R33KP, R33KQ, R33KR, R33KS, R33KT, R33KU, R33KV, R33KW, R33KX, R33KY, R33KZ, R33LA, R33LB, R33LC, R33LD, R33LE, R33LF, R33LG, R33LH, R33LI, R33LJ, R33LK, R33LL, R33LM, R33LN, R33LO, R33LP, R33LQ, R33LR, R33LS, R33LT, R33LU, R33LV, R33LW, R33LX, R33LY, R33LZ, R33MA, R33MB, R33MC, R33MD, R33ME, R33MF, R33MG, R33MH, R33MI, R33MJ, R33MK, R33ML, R33MM, R33MN, R33MO, R33MP, R33MQ, R33MR, R33MS, R33MT, R33MU, R33MV, R33MW, R33MX, R33MY, R33MZ, R33NA, R33NB, R33NC, R33ND, R33NE, R33NF, R33NG, R33NH, R33NI, R33NJ, R33NK, R33NL, R33NM, R33NN, R33NO, R33NP, R33NQ, R33NR, R33NS, R33NT, R33NU, R33NV, R33NW, R33NX, R33NY, R33NZ, R33OA, R33OB, R33OC, R33OD, R33OE, R33OF, R33OG, R33OH, R33OI, R33OJ, R33OK, R33OL, R33OM, R33ON, R33OO, R33OP, R33OQ, R33OR, R33OS, R33OT, R33OU, R33OV, R33OW, R33OX, R33OY, R33OZ, R33PA, R33PB, R33PC, R33PD, R33PE, R33PF, R33PG, R33PH, R33PI, R33PJ, R33PK, R33PL, R33PM, R33PN, R33PO, R33PP, R33PQ, R33PR, R33PS, R33PT, R33PU, R33PV, R33PW, R33PX, R33PY, R33PZ, R33QA, R33QB, R33QC, R33QD, R33QE, R33QF, R33QG, R33QH, R33QI, R33QJ, R33QK, R33QL, R33QM, R33QN, R33QO, R33QP, R33QQ, R33QR, R33QS, R33QT, R33QU, R33QV, R33QW, R33QX, R33QY, R33QZ, R33RA, R33RB, R33RC, R33RD, R33RE, R33RF, R33RG, R33RH, R33RI, R33RJ, R33RK, R33RL, R33RM, R33RN, R33RO, R33RP, R33RQ, R33RR, R33RS, R33RT, R33RU, R33RV, R33RW, R33RX, R33RY, R33RZ, R33SA, R33SB, R33SC, R33SD, R33SE, R33SF, R33SG, R33SH, R33SI, R33SJ, R33SK, R33SL, R33SM, R33SN, R33SO, R33SP, R33SQ, R33SR, R33SS, R33ST, R33SU, R33SV, R33SW, R33SX, R33SY, R33SZ, R33TA, R33TB, R33TC, R33TD, R33TE, R33TF, R33TG, R33TH, R33TI, R33TJ, R33TK, R33TL, R33TM, R33TN, R33TO, R33TP, R33TQ, R33TR, R33TS, R33TT, R33TU, R33TV, R33TW, R33TX, R33TY, R33TZ, R33UA, R33UB, R33UC, R33UD, R33UE, R33UF, R33UG, R33UH, R33UI, R33UJ, R33UK, R33UL, R33UM, R33UN, R33UO, R33UP, R33UQ, R33UR, R33US, R33UT, R33UU, R33UV, R33UW, R33UX, R33UY, R33UZ, R33VA, R33VB, R33VC, R33VD, R33VE, R33VF, R33VG, R33VH, R33VI, R33VJ, R33VK, R33VL, R33VM, R33VN, R33VO, R33VP, R33VQ, R33VR, R33VS, R33VT, R33VU, R33VV, R33VW, R33VX, R33VY, R33VZ, R33WA, R33WB, R33WC, R33WD, R33WE, R33WF, R33WG, R33WH, R33WI, R33WJ, R33WK, R33WL, R33WM, R33WN, R33WO, R33WP, R33WQ, R33WR, R33WS, R33WT, R33WU, R33WV, R33WW, R33WX, R33WY, R33WZ, R33XA, R33XB, R33XC, R33XD, R33XE, R33XF, R33XG, R33XH, R33XI, R33XJ, R33XK, R33XL, R33XM, R33XN, R33XO, R33XP, R33XQ, R33XR, R33XS, R33XT, R33XU, R33XV, R33XW, R33XX, R33XY, R33XZ, R33YA, R33YB, R33YC, R33YD, R33YE, R33YF, R33YG, R33YH, R33YI, R33YJ, R33YK, R33YL, R33YM, R33YN, R33YO, R33YP, R33YQ, R33YR, R33YS, R33YT, R33YU, R33YV, R33YW, R33YX, R33YY, R33YZ, R33ZA, R33ZB, R33ZC, R33ZD, R33ZE, R33ZF, R33ZG, R33ZH, R33ZI, R33ZJ, R33ZK, R33ZL, R33ZM, R33ZN, R33ZO, R33ZP, R33ZQ, R33ZR, R33ZS, R33ZT, R33ZU, R33ZV, R33ZW, R33ZX, R33ZY, R33ZZ

TP	AC VOLTS	FORM	DC VOLTS
TP1	38Vrms	()	150VDC
TP2	11Vrms	()	155VDC
TP3	6Vrms	()	158VDC
TP4	25Vrms	()	150VDC
TP5	5Vrms	()	150VDC
TP6	4.5Vrms	()	150VDC
TP7	4.5Vrms	()	150VDC
TP8	4.5Vrms	()	150VDC
TP9	4.5Vrms	()	150VDC
TP10	4.5Vrms	()	150VDC
TP11	4.5Vrms	()	150VDC
TP12	4.5Vrms	()	150VDC
TP13	4.5Vrms	()	150VDC
TP14	4.5Vrms	()	150VDC
TP15	4.5Vrms	()	150VDC
TP16	4.5Vrms	()	150VDC

LAST USED: R133 C82 D35 J40 Q27
 NOT USED: R15, R65, D16-D18, D22
 R60, R62, R63, C76, C79
 D25, J5, J8, J21

APPROVED BY
 8/25/97

TP	AC VOLTS	FORM	WAVE
TP17	DIRTY 7V P-P		---
TP18	CLEAN 18V P-P		33.6VDC
TP19	DIRTY 88V P-P		5SVDC
TP20	DIRTY 88V P-P		-53VDC
TP21	DIRTY 88V P-P		36.5VDC
TP22	DIRTY 88V P-P		-60VDC
TP23	CLEAN 12mv		31VDC
TP24	CLEAN 12mv		-31VDC
TP25	CLEAN 17VDC		17VDC
TP26	CLEAN 16.4VDC		16.4VDC
TP29	CLEAN 16.8VDC		16.8VDC
TP30	CLEAN 16.8VDC		-16.8VDC

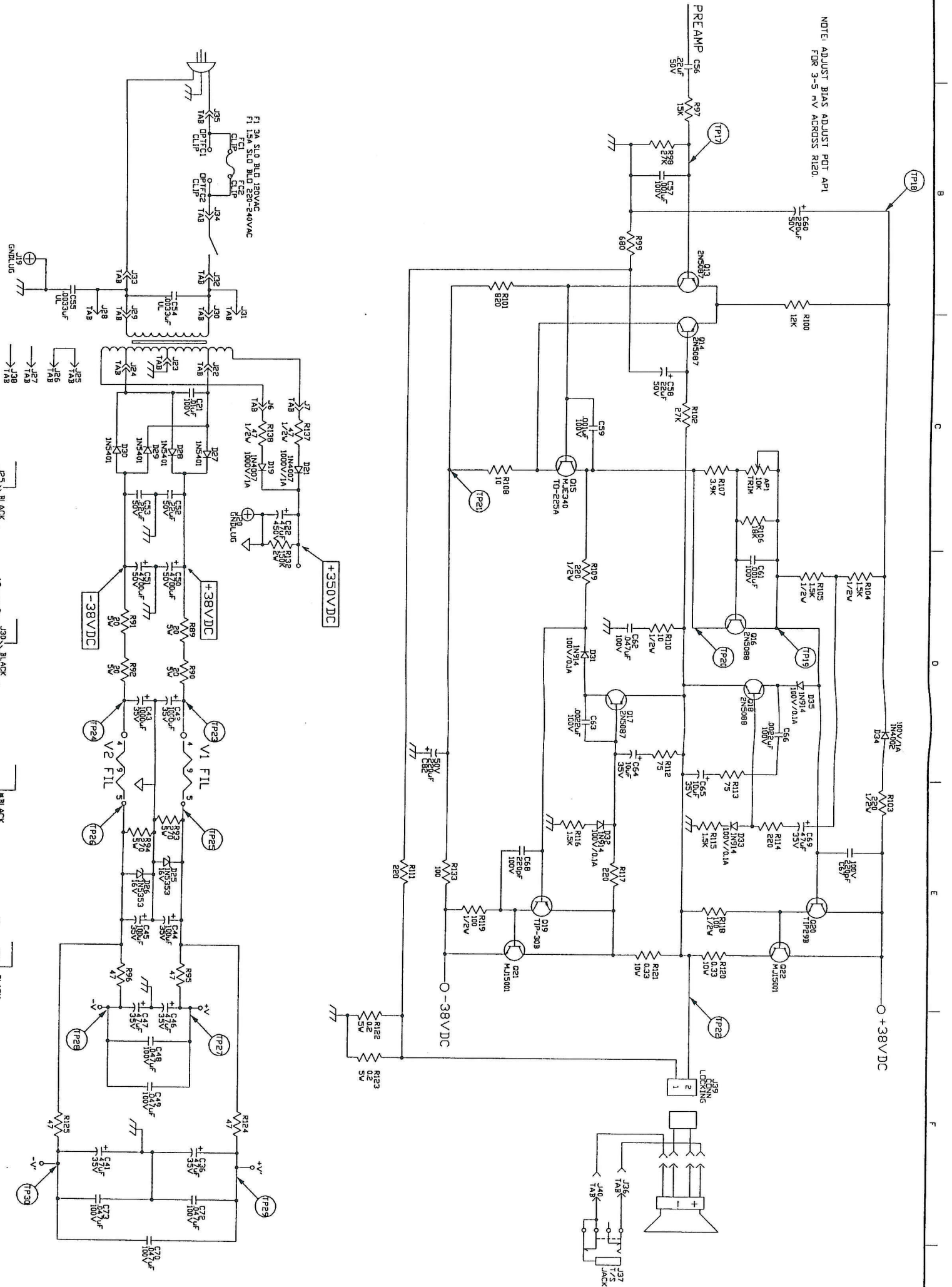

NOTE: ADJUST BIAS ADJUST POT APT1 FOR 3-5 mV ACROSS R120.

NOTES:
 1) CAUTION: SHOCK HAZARD!
 THIS UNIT CONTAINS HAZARDOUS VOLTAGE. DISCONNECT POWER AND BE SURE POWER SUPPLY IS DISCHARGED BEFORE TOUCHING INTERNAL PARTS.
 2) UNLESS NOTED, RESISTOR VALUES IN OHMS, 1/4W-5% TOL. CAPACITOR VALUES IN MICROFARADS, 50V-10% TOL.
 3) VOLTAGES ARE MEASURED WITH 1 MEGOHM OSCILLOSCOPE AND 10 MEGOHM DIGITAL VOLTMETER.
 4) CHASSIS GROUND ∇ CIRCUIT GROUND \neq

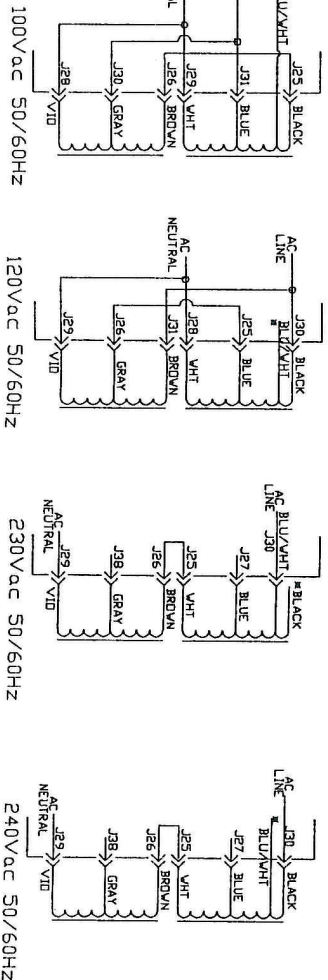

EXPORT WIRING

CAUTION: THIS SCHEMATIC IS PROVIDED FOR USE BY QUALIFIED PERSONNEL TO AVOID RISK OF ELECTRICAL SHOCK. REFER TO QUALIFIED SERVICE PERSONNEL. DO NOT PERFORM ANY SERVICING BEYOND THAT IN THE OPERATING INSTRUCTIONS.

SEE SHEET 1 OF 2 FOR REVISION HISTORY

SIGNATURES:	DATE:	PROJECT NAME:
OK	09/28/96	GXT-100 GUITAR AMP
OK	09/25/96	SCHEMATIC
OK	09/25/96	
OK	08/04/97	
OK	11/09/14	

DRAWING NO. 07S250-01 SCALE: 1:1 SHEET: 2 OF 2

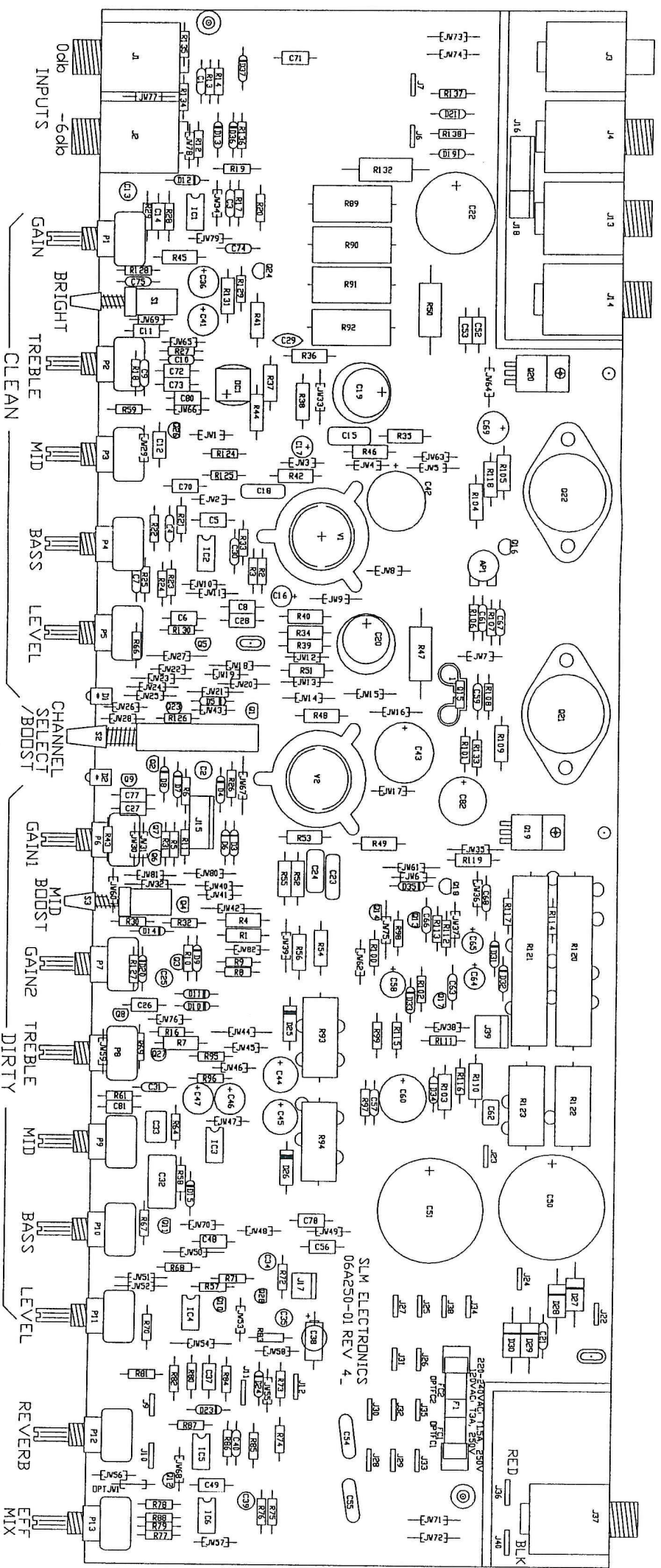

Approved By
 P.M.
 8/25/97

REV	DATE	BY	CHK'D	DESCRIPTION
1	12/13/96	REM		CHANGED C22, S1 & S3. PER ECO #E960439
2	12/13/96	REM		CHANGED J36, R40 TO 17-894-01 PER E960518. ART & DRILL TO REV 2
3	02/26/97	REM		ART & DRILL TO REV 3 PER E960090 & E970076. CHANGED VALUES & ADDED CIRCUITRY
4	07/25/97	SWR		ADDED D36, D37, R134 thru R138, JW77-JW83, & Q28 PER ECO'S #970158 & 970389. (REDONE IN AUTOCAD)
5				
6				

SIGNATURES:		DATE:
DRAWN: REM		09/17/96
CHK'D: OK		09/17/96
APP'D: OK		09/17/96
ORIGINAL ISSUED:		09/17/96
PROJECT NAME: GXT-100 GUITAR AMP		
DRAWING NAME: PICTORIAL DRAWING		
PLOT DATE:	08/04/97	
PLOT TIME:	11:00:21	
FILE NAME:	25001p4	
SCALE:	1:1	SHEET: 1 OF 4

11880 BOPMAN DR.
 ST. LOUIS, MISSOURI
 63146

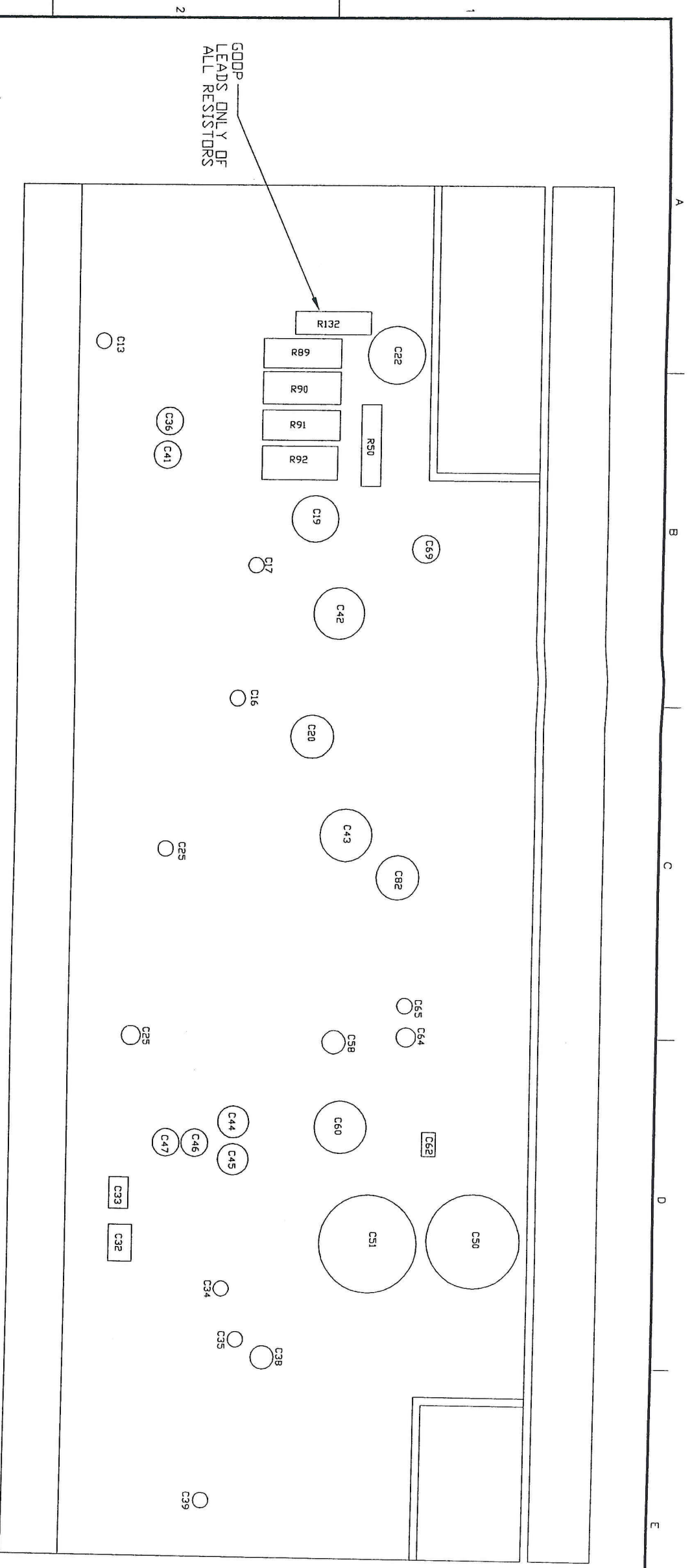

GOODP PER STANDARD PRACTICE

SEE SHEET 1 OF 4 FOR REVISION HISTORY

SIGNATURES:	DATE:	PROJECT NAME:
DRAWN: REM	09/17/96	GXT-100 GUITAR AMP
CHK'D: OK	09/17/96	
APP'D: OK	09/17/96	DRAWING NAME:
ORIGINAL ISSUED:	09/17/96	HEATSINK ASSEMBLY DWG.
PLOT DATE:	08/04/97	DRAWING NO.:
PLOT TIME:	11:00:21	07P250-01
FILE NAME:	25001p4-	SCALE: 1:1
		SHEET: 3 OF 4

ITEM No.	PART NUMBER	DESCRIPTION	QTY.
1	30-408-52	4-40 x 1/2" PPH M/S W/INTERNAL LOCKWASHER	4
2	30-442-52	4-40 A.F. HEX KEPNUT ASSEMBLY	4
3	30-639-52	6-32 x 9/16" PPH M/S W/INTERNAL LOCKWASHER	4
4	30-700-01	6-32 HEX KEPNUT ASSEMBLY	4
5	33-116-51	HEATSINK	1
6	35-003-02	BERGQUIST INSULATOR	2
7	35-043-01	NYLON BUSHING, NATURAL	2
8	35-579-01	BG 90058 INSULATOR	2
9	51-232-01	BX-100 TRANSISTOR BRACKET	1
10	96-029-01	TIP29B TRANSISTOR	1
11	96-030-01	TIP-30B TRANSISTOR	1
12	96-101-01	MJ15001 TRANSISTOR	2
13	96-588-01	2N5088 TRNASTOR	1

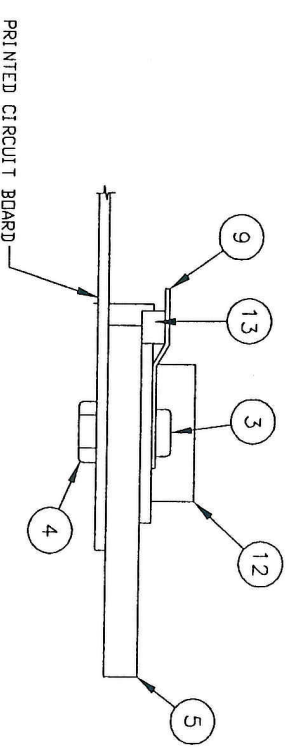
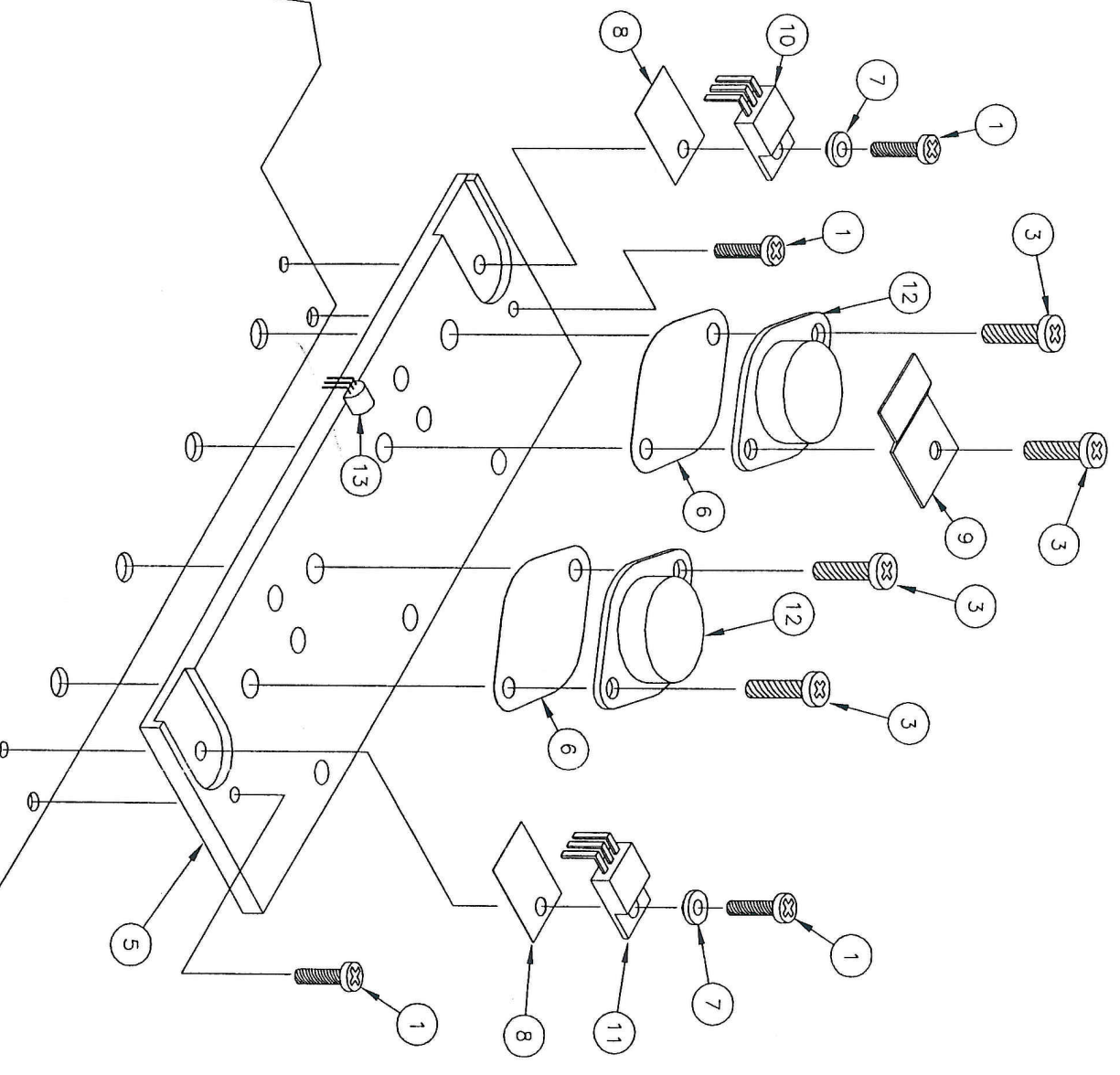

NOTE: ASSEMBLE TRANSISTOR BRACKET (ITEM #9) TO TRAP BIAS TRANSISTOR (ITEM #13) TO HEATSINK AS SHOWN.

DETAIL "A"

PRINTED CIRCUIT BOARD
(07A250-01)

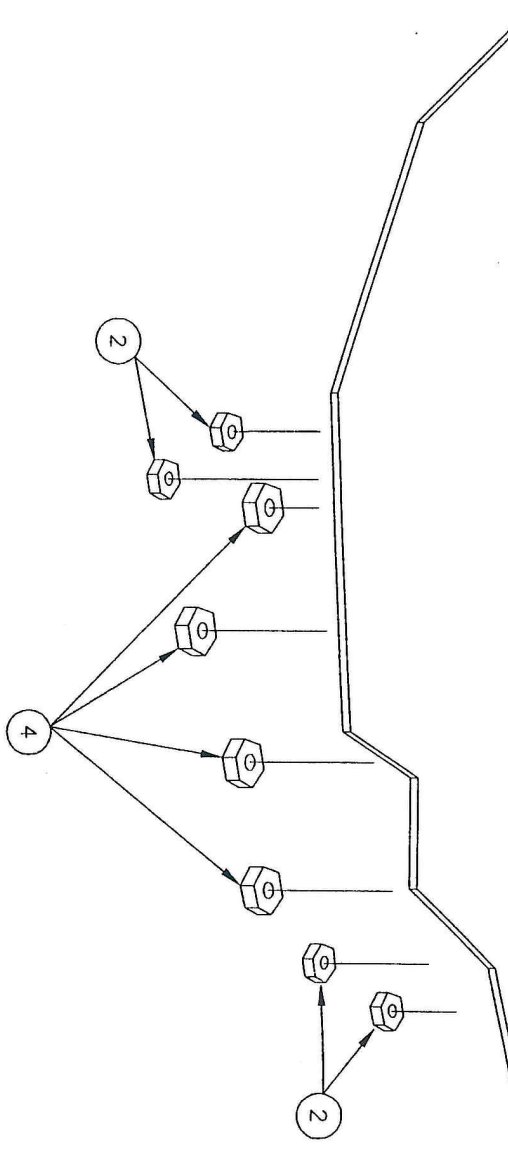

SEE SHEET 1 OF 4 FOR REVISION HISTORY

SIGNATURES:		DATE:	
DRAWN: REM		09/17/96	
CHK'D: OK		09/17/96	
APP'D: OK		09/17/96	
ORIGINAL ISSUED:		09/17/96	
PLOT DATE:	08/04/97	DRAWING NAME:	GXT-100 GUITAR AMP
PLOT TIME:	11:00:21	DRAWING NO.:	HEATSINK ASSEMBLY DWG.
FILE NAME:	25001p4	SCALE:	1:1
		SHEET:	4 OF 4

1880 BORGAN DR.
ST. LOUIS, MISSOURI
63149