



# Yorkville Sound Parts Catalogue

February 9, 2009

Quality & Innovation Since 1963

Volume 12 • Issue 3



<b>Warranty Claim Policy</b>	
• English	
<b>01 Kits etc.</b>	
01A	Kits
01B	Tubes etc.
01C	Footswitches
01D	Reverbs
<b>02 Amplifier Filters/Fans/Guards</b>	
02A	Amplifier Filters
02B	Fans & Fan Guards
<b>03 Hardware</b>	
Diagram - Cabinet Parts	
Diagram - Connectors	
Diagram - Knobs	
03A	Hardware (various)
03B	Connectors
03C	Screws
03D	Plastic Parts (misc)
03E	Crossover Dishes
03F	Knobs
03G	Line Cords
03H	Cable / Cords
<b>04 Handles / Lexan / Logos</b>	
04A	Handles
04B	Logos
04C	Clips
<b>05 Speaker Components</b>	
05A	Speakers / Drivers
05B	Recone Kits
05C	Diaphragms
05E	Horns
05D	Speaker Hardware
<b>06 Fuses/ HOLDERS/Breakers/Bulbs</b>	
06A	Fuse Holders
06B	Fuses
06C	Circuit Breakers
06D	Bulbs / Lamps etc.
<b>07 Capacitors</b>	
Diagram - Color Chart	
07A	Capacitors

08	08A	Coils
09	09A	Diodes
	09B	LED Hardware
	09C	LEDS
<b>10 Potentiometers</b>		
Diagram		
	10A	Potentiometers (Pots)
	10B	Trim Pots
	10C	Totary Encoders
	10D	L-Pads
<b>11 Resistors/Jumpers etc.</b>		
Diagram - Color Chart		
	11A	Resistor Hardware / Jumpers
	11B	Resistors
	11C	Resistors (Fusible)
	11D	Resistors (Flame Proof)
<b>12 Transistors</b>		
Diagram		
	12A	Transistors
	12B	Transistors (Darlington)
	12C	Transistors (Mofet)
	12D	Pads
<b>13 Thermistors/Bridges</b>		
Diagram		
	13A	Thernistors, Surgistors
	13B	Bridges
<b>14 14A Voltage Regulators</b>		
<b>15 Ics/Sockets etc.</b>		
	15A	ICS
	15B	Sockets
	15C	Crystals / Sockets
<b>16 16A Spacers</b>		
<b>17 17A Triacs / Diacs etc.</b>		
<b>18 18A Opto-Couplers</b>		
<b>19 Switches/Relays</b>		
Diagram		
	19A	Switches
	19B	Relays
<b>20 20A Transformers</b>		
<b>21 21A Miscellaneous</b>		
Pot and Knob Reference Charts		
Speaker Component Chart		

### Web Access

To access this document online, go to <http://www.yorkville.com> and Choose RESOURCES in the upper menu bar, then choose SERVICE/REFERENCE DOCUMENTS on the side menu. Select OTHER DOCUMENTS to access the dropdown menu and select the Yorkville Parts Catalogue.

### Web parts search

If you choose COMPONENT SEARCH in the RESOURCES/SERVICE REFERENCE DOCS, side menu, you can search for specific parts online.

Prices are subject to change without notice



Printed in Canada

# Yorkville Sound

550 Granite Court, Pickering, Ontario, Canada L1W 3Y8  
905.837.8777 Fax 905.839.5776

## Yorkville Warranty Claim Details

February 2007

Yorkville Sound has two basic types of warranty. The Group A 2/10-year, unlimited warranty (10 years on wooden cabinet structure – repairs performed by Yorkville) covers the majority of items that Yorkville manufactures. **Group B** items are covered by variations on the Limited warranty theme.

### Group A Warranty Covers:

- YX, Performance, Pulse, Elite, NX & Unity Series Loudspeakers & subwoofers
- Yorkville Audiopro and Micromix Series power amplifiers and mixer/amplifiers
- Yorkville LP Series Lighting systems
- Yorkville Instrument amplifiers and speakers
- Traynor Instrument amplifiers and speakers

### Allowed

A1) All parts, except tubes & par bulbs, at dealer cost from Yorkville, i.e. packing slip prices less B. Note; cone drivers must be returned for credit - we assume horn drivers will be re-diaphragmed (no need to return old diaphragms), otherwise if replaced they too must be returned

A2) Labor at \$40.00/hr for electronic repairs where labor time is shown

A3) A flat labor rate of \$10.00 for each speaker, horn, tweeter or diaphragm replacement

A4) Yorkville pays freight one-way for items under warranty needing service

### Not Allowed

a1) Claims without complete information – i.e. model & serial no & details of the repair including problem, repair operations, parts used and time spent

a2) Parts or labor for tube or par bulb replacement

a3) Parts that are not listed on the claim (eg. "Parts - \$25.00" would be n/a)

a4) Speakers not returned with complete claim documentation – eg. model & serial no.'s

a5) "Shop supplies"

a6) Labor for fuse replacement (fuses themselves are covered)

a7) Labor without time specified (we may estimate time & credit per 2 & 3 above)

a8) Labor time which exceeds the norm for a given type of repair (we may adjust)

a9) Freight either way on all parts including speakers

a10) Repairs for cosmetic damages, weather damage, damage as a result of improper use or installation, damages as a result of exposure to extreme humidity, accident or disaster

a11) Claims for incidental or consequential damages

a12) Claims for repairs to correct malfunctions directly or indirectly resulting from modifications not specified by Yorkville

a13) Claims for repairs already performed by Yorkville under warranty

a14) Claims for units more than 2 years old per the serial number & not accompanied by a bill-of-sale copy or other document to verify new sale or first rental within the warranty period

[date code - 1st digit = last digit of the year (eg "6" = 2006), 2nd & 3rd are the month (eg. "02" = Feb)]

Cont'd...2

**Group B Warranty Covers:**

- TX Series loudspeakers, monitors and subwoofer enclosures & processors for two years
- YSM Series active and passive studio monitors for two years
- Coliseum Series Installation loudspeakers & monitors for two years
- Traynor International Series guitar and bass amplifiers for two years
- Gallien-Krueger amplifiers for one year on electronic components, 90 days on speakers
- Gibson and Epiphone guitar amplifiers and extension cabinets for two years
- Gibson, Epiphone, Dobro, Kramer & Valley Arts musical instruments for one year
- ART signal processors & EQs for three years
- ARTcessories for one year
- Apex microphones, solution boxes, and signal processing for one year
- Apex cables and connectors for ten years (non-transferable)
- Apex speaker stands, microphone stands and booms for one year
- Alto mixers, amplifiers, speakers and signal processing for one year
- Yorkville patch, microphone & speaker cables and snakes for five years (nontransferable)
- Yorkville Guitar & Bass Cases for one year
- Ritter bags & cases for one year
- Raw drivers for 90 days.
- Raw Tubes for 30 days

**Allowed**

- B1) All returned parts at dealer cost from Yorkville (packing slip prices less B) except strings  
B2) Labor at \$40.00/hr where labor time is shown  
B3) A flat labor rate of \$10.00 for each defective speaker, horn, tweeter or diaphragm replacement  
B4) Yorkville pays freight one-way for items under warranty needing service

**Not Allowed**

- b1) Claims without complete information – i.e. model & serial number, bill of sale or packing slip copy & details of the repair including problem, repair operations, parts used and time spent  
b2) Claims for replacing or repairing broken parts unless they arrive broken on a new product (the Group B warranty covers mfg defects, not accidents)  
b3) Extra costs for parts other than those distributed by Yorkville  
b4) More than the normal amount of repair time (we may estimate and adjust as needed)  
b5) Claims for replacing “blown” speakers, horns or tweeters (blown = not mfg. defect)  
b6) Claims without point-of-purchase data or bill of sale for consumer-owned products  
b7) Claims for store stock without Yorkville packing slips, invoices or stocking dates  
b8) Claims for instrument “setups” including adjusting the neck, bridge or pickups, fret jobs & polishing, oiling fretboards, setting action or intonation, changing strings, cleaning & polishing.  
B9) Freight charges for parts  
b10) “Shop supplies”  
b11) Claims for repairs already performed by Yorkville under warranty  
b12) Modifications not specified by Yorkville  
b13) Parts credits where the parts were not returned or picked up by the area rep

*\*\*Please note that Yorkville reserves the right to change these conditions without notice. Please consult with your local order desk for the most up-to-date warranty policy information.*

SEQ	PRODUCT CODE	REPLACEMENT PRODUCT	DESCRIPTION
---	-----	-----	-----
01A	3BULBKIT		3 LIGHT BULB RETROFIX FOR SPK CAB
01A	AP3000KIT		REPLACEMENT PARTS FOR M1002 M1011
01A	AP3400KIT		REPLACEMENT PARTS FOR M1002A M1011A
01A	DJMXFADER		DJM806 REPLACEMENT CROSS FADER
01A	E152KIT		REPAIR KIT FOR E152 CABINET
01A	FILTERKIT		FAN FILTER KIT AP1200/3000/3400
01A	FILTERKIT2		FAN FILTER AP2020/4020/4040/800/4.4
01A	LOAD BOX		1000W 2CHANNEL LOAD BOX VERSION 3.0
01A	M1146KIT		REPLACEMENT PARTS FOR BOARD REPAIRS
01A	NX25PKIT		NX25P - MFG. KIT ONLY
01A	SCREW KIT		BAG OF MIX SCREWS
01A	SPACERKIT		KIT TO FIT 18/851KNR INTO OLD BASKT
01A	TRANSHRDW-KIT		ASSORTED TRANSISTOR HARDWARE
01A	P02		MID RANGE ENCLOSURE
01B	3731		SPRING RETAINER FOR OUTPUT TUBE
01B	3732		9 PIN PC MOUNT TUBE SOCKET BE
01B	3733		8 PIN PC MOUNT TUBE SOCKET
01B	3983		9 PIN PC MOUNT TUBE SOCKET
01B	4021		SPRING RETAINER FOR 6550
01B	12AX7SELECTED		TUBE TESTING FOR 12AX7 PREAMP TUBE
01B	12AX7SORTED	12AX7SELEC	TUBE TESTING FOR 12AX7 PREAMP TUBE
01C	CBL0011		TRAYNOR DUAL FOOTSWCH 10' CORD-BULK
01C	TFS-4		TRAYNOR QUAD FOOTSWCH 20' CORD
01D	3537		ACC# 4EB3C1B LONG REVERB
01D	3581		OC# 300-OHM MINI REVERB WIRE LEAD
01D	3582	SEE 3572 N	ACC# 1EB2C1B SHORT REVERB
01D	3586		ACC# 1BB1C1C SHORT REVERB

SEQ	PRODUCT CODE	REPLACEMENT PRODUCT	DESCRIPTION
---	-----	-----	-----
02A	7584		SQUARE-CUT O RING FOR AP AIR FILTER
02A	8432		AP SERIES AIR GRILL BLACK PLASTIC
02A	8552		AIR VENT, AP MIXERS
02B	3630		FAN GUARD METAL 80MM CHROME
02B	3632		FAN GUARD METAL 60MM CHROME
02B	3634		FAN GUARD PLASTIC BLACK 80MM X 80MM
02B	3656		FAN 40MM X 40MM 6CFM 24VDC 50MA
02B	3856		FAN 80MM X 80MM 39CFM 12VDC 200MA
02B	3860		FAN 80MM X 80MM 40CFM 12VDC
02B	3863		FAN 80MM X 80MM 33CFM 12VDC 173MA
02B	3864		FAN 92MM X 92MM 60CFM 24VDC
02B	3868		FAN 92MM X 92MM 60CFM 24VDC ???MA

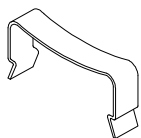

3567 XSISTR SPRING CLIP #56379-SOT93

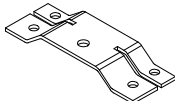

3734 DUAL XSISTOR SINGLE BODY PATE JS500  
3745 DUAL XSISTOR SPLIT SPRING PLATE ZN

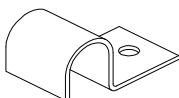

8461 TRIM CLIP (PLATED BLK ZINC)

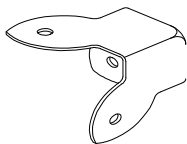

8501 CORNER, 3 LEGS, NICKEL  
8562 CORNER, 3 LEGS, BLACK OXIDE

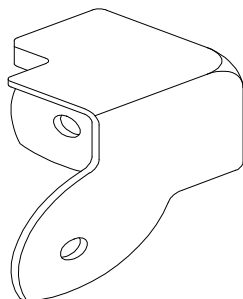

8502 CORNER, 2 LEGS/1 LIP, NICKEL

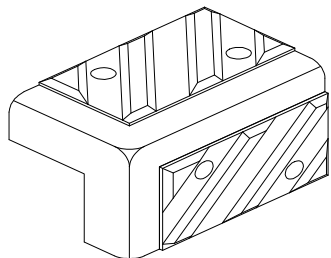

8674 PLASTIC CORNER WITH TREAD

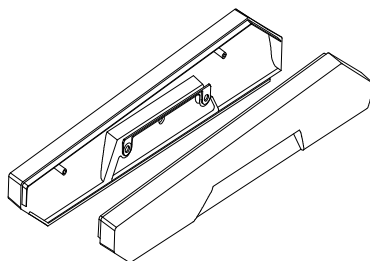

8559 AUDIOPRO GABLE "SET" ABS PLASTIC

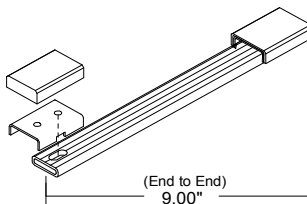

8457 9" STRAP HANDLE CLIPS PLASTIC COVER

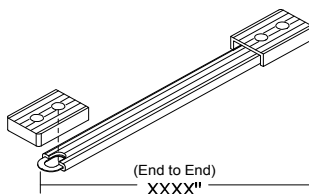

8458 10.5" STRAP HANDLE, PLASTIC COVERS

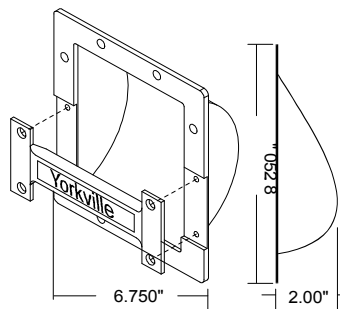

8539 CAST HANDLE "YORKVILLE" YS BLUE

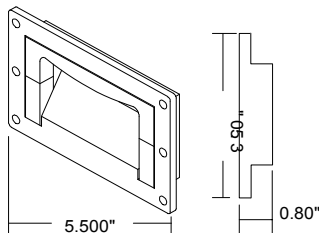

8542 HANDLE, RECESSED, PULL, BLACK PLASTIC

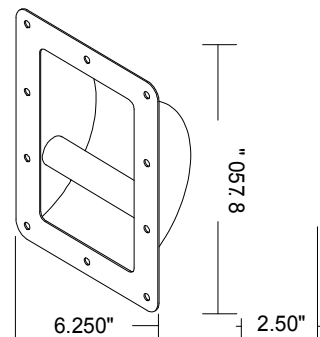

8564 PLASTIC BLK CORNER LEFT CF-3 CLIFF

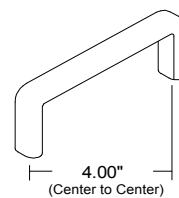

8571 U-SHAPE ALUMINUM OVAL BLACK HANDLE

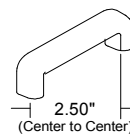

8694ANOBK U-SHAPE OVAL ALUM. BLACK ANO HANDLE

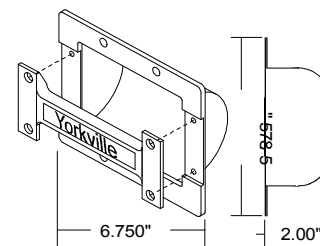

8558 CAST ALUM. HANDLE SMALL PLASTIC WEL

SERVICE PARTS CATALOGUE

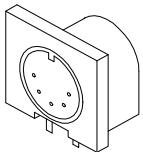

**3427** 5PIN DIN PC MNT MIDI SOCKET

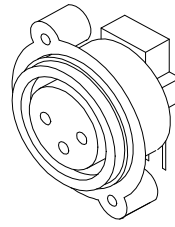

**3660** FEMALE PC MDUNT XLR NTRX. NC3FPR-H-0

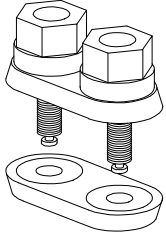

**3443** DUAL BINDING POST

**3410** RED ON LEFT DUAL BINDING POST TPP4

**3415** RED ON RIGHT DUAL BINDING POST TPP4

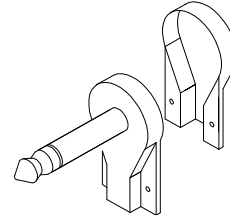

**3912** 1/4" RIGHT ANGLE PHONEPLUG 228

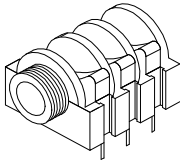

**3450** G203-02 ALL GOLD PC MNT JK SKT

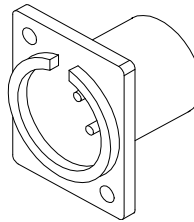

**3923** NC3MAH MALE XLR PC MNT

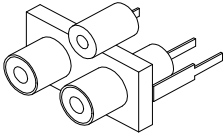

**3460** MOULDED DUAL RCA SOCKET GOLD PLATED

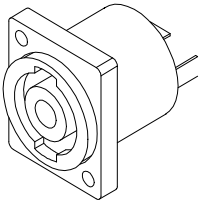

**3627** PC-MOUNT 250TAB SPEAKER #8SCREW BLA

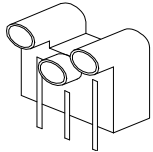

**3650** NCPPCB-H XLR PCB ADAPTOR

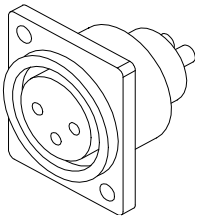

**3659** NC3FPP FEMALE XLR PLASTIC

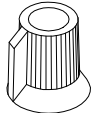

8391 *ROCKBLOC ROTARY KNOB GREY*



8661 *BUTTON KNOB FLAT GREY*

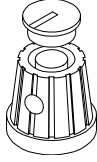

8460 *P862-01/P863-25 KNOB W BLACK CAP*



8684 *MICROMIX ROTARY KNOB BLUE*

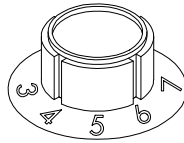

8507 *LARGE ROGAN KNOB AR2SK29*



8689 *BLUE EQ KNOB PLASTIC*



8611 *SLIDE POT KNOB-GREY*



8690 *BLACK FADER KNOB - MICROMIX*

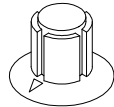

8617 *SMALL SKIRTED KNOB PLASTIC*

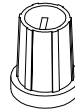

8693 *S ROTARY KNOB GREY*



8619 *BLACK L-PAD KNOB MARS RLP KB6*

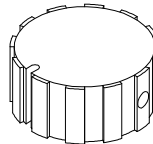

8695 *AP-SERIES KNOB - BARE 6061-T6 ALUM*

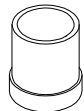

8627 *LIGHT SHOW KNOB (BLACK/W RED CAP)*



8702 *GREEN KNOB FOR "NEW" M.MIX/A.PRO*



8638 *AP MIXER SERIES PUSH SW BUTTON GREY*



8650 *RED KNOB 10081-309 PREH-MOMNTRY*

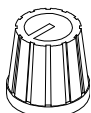

8644 *ROTARY KNOB PLASTIC W GREEN INSERT*



SEQ	PRODUCT CODE	REPLACEMENT PRODUCT	DESCRIPTION
---	-----	-----	-----
03A	3986		PC/2 "AA" BATT. HOLDER
03A	3545		ANGLE BRACKET .5" X .5" X .5"
03A	8721		3/8-16X11/4 GRD5 FLAT SCKT HD JS500
03A	8726	8997	3/8-16X11/2 GRD5 FLAT SCKT HD JS500
03A	8816		1/4" FLT WASHER .625"O.D .275I.D SJ
03A	8855		SCREWKNOB 5/16"18 X 1" SUPERSTAR
03A	8889		RUBBER GROMMET #2183-034-BLK
03A	8938		1/4-20 X 10MM INSERT NUT, TYPE D
03A	9897		CABINET COVER, BLACK, 54" WIDE
03A	3495		1/8" HEATSHRINK POLYOLEFIN
03A	3496		1/16" PVC TUBING 15AWG
03A	3505		3/8" HEATSHRINK FIT 221-3/8
03A	3512		WHITE SLEEVE FOR 16 OR 18 GA.
03A	3513		3/16" HEATSHRINK POLYOLEFIN
03A	3438		IEC PWR SOC W/.205TAB &FUSE 10A250V
03A	3510		B52200F005 COMP WASH #4 LARGE
03A	3518		CLEAR PVC TUBING .500" DIA. 105'C
03A	3579		BUSHING SB-500-6
03A	3645		AC SOCKET RECEPTACLE WITH 0.250 TAB
03A	3684		EUROPEAN AC SOCKET
03A	3685		15 AMP HOUSE SOCKET IVY #5320-I
03A	3798		8" NYLON CABLE TIE
03A	3799		ROUND BUMPER BUTTON BLACK
03A	3801		5/8" BUMPER BUTTON BLACK
03A	3803		NYLON SECUR-A-TACH MINI PLASTIC TIE
03A	3837		WECO TERM BLOCK 34-820-008
03A	3841		5.5" NYLON CABLE TIE
03A	3852		STICK ON CABLE WRAP ANCHOR
03A	9904		PAR 56 LIGHT FIXTURE ALUMINUM
03A	LIGHT-CLAMP		C-CLIP TO HOLD BULB INSIDE PAR CAN
03A	U-BRACKET1		METAL U BRACKET FOR PAR 56 CANS
03A	3730		18" 6C-26AWG RIB 1 W/LCK HDR 098GL
03A	3903		PCB CONN 4 CIR BOTTOM .156
03A	4005		17" 6C-26 AWG RIBBON CABLE 0.1"
03A	8701		4-40 KEPS NUT ZINC
03A	8793		4-40 HEX NUT ZINC
03A	8666		6-32 X 1/4" INSERT CFS0632-8
03A	8760		6-32 KEPS NUT TIN PLATED
03A	8800		6-32 KEPS NUT ZINC
03A	8854		6-32 X 1/4" O.D. HEX NUT ZINC CLEAR
03A	8787		8-32 KEPS NUT ZINC
03A	8841		10-32 KEPS NUT TIN PLATED
03A	8880		3/16 PUSHNUT SPAENAUER #177078
03A	8602		1/4-20 T NUT
03A	8603		3/8-16 T NUT
03A	8683		1/4-20 NYLON INSERT NUT ZINC
03A	8788		1/4-20 KEPS NUT ZINC
03A	8890		1/4-20 CAGE NUT C79-88142027
03A	8898		1/4-20 CAGE NUT C79 98142027

SEQ	PRODUCT CODE	REPLACEMENT PRODUCT	DESCRIPTION
03A	8934		7/16-20 UNF HEX NUT GRD 5 CLEAR ZNC
03A	8712		5/16-24 JAM NUT JS500
03A	8797		5/16-18 KEPS NUT JS500
03A	8848		5/16 WELDNUT
03A	8594	8610	3/8-32 POT HEX NUT BRASS SUB 8610
03A	8724		3/8-16 T-NUT (SCREW MOUNT)
03A	8883		1/2 X 13 NYLON INSERT LOCK NUT
03A	9867		1/8 X 26 X 26 STYRENE BLACK UTILITY
03A	9888		LEATHERETTE,BLACK,NUBTEX 54"
03A	9889		LEATHERETTE, WINE RED NUBTEX, 54"
03A	9890		LEATHERETTE, NAVY BLUE NUBTEX, 54"
03A	9891		GRILLE CLOTH, BLACK, 36" WIDE
03A	9892		CABINET COVER, BLUE/BLACK, 54" WIDE
03A	9893		LEATHERETTE, WINE BUGGY WHIP, 54"
03A	9894		LEATHERETTE,RED,ELEPHANT HYDE 54"
03A	9895		CABINET COVER, BLUE/BLACK/GREY, 54"
03A	9896		CABINET COVER, MIDNIGHT BLUE, 54" W
03A	9898		LEATHERETTE,BLACK,BRONCO 54"
03A	9899		GRILLE CLOTH, WHITE METALLIC 36"WID
03A	9905		GRILLE CLOTH, YELLOW/BROWN 36" WIDE
03A	GC1		GRILL CLOTH 1 VINTAGE TRAYNOR
03A	8908	N/A	#10 SAE FLAT WASHER .25"ID .565" OD
03A	8913		1" OD X 3/16 ID X .06 THICK WASHER
03A	8921		#4 FLAT WASHR 1/8 I X 5/16 O X 1/32
03A	8489		1/4-20 SPLIT WASHER BLACK OXIDE
03A	8492		7/16" SPLIT LOCK WASHER CLEAR ZINC
03A	8925		#4 INTERNAL TOOTH LOCKWASHER
03A	8682		#4 TEFLON WASHER .125ID .281OD .031
03A	8651		SHOULDER WASHER .483" X .4" BLACK
03A	8652		SHOULDER WASHER .483" X .125" BLACK
03A	8667		SHOULDER WASHER SWS-229 LENGTH 1/8
03A	8670		SHOULDER WASHER 125X140#4 HITMP BLK
03A	8482		3/8 1D FLAT WASHER
03A	8488		3/8 INT TOOTH LOCKWASHE ZINC
03A	8884		.505 I. D. SPRING TENSION WASHER
03A	3517		NYLON WASHER #8 0.062
03A	8818		3/4 OD X 3/8 ID X .080 THICK WASHER
03A	3511		#6 FLAT WASHER NYLON
03A	8485	N/A	#6 SPLIT WASHER ZINC
03A	8852		#6 INTERNAL TOOTH LOCKWASHER
03A	8853		#6 TEFLON FLAT WASHER 0.0316 THICK
03A	8491		#10 SPLIT LOCK WASHER BO
03A	8820		#8 FLAT WASHER JS500
03A	8473		#10 BLACK CUPWASHER SWF-10BK
03A	8817		#10 FLAT WASHER FOR 3/16" BOLT
03A	8850		#10 INT TOOTH LOCKWASHER BO
03A	8942		1/2" SPLIT WASHER
03A	8996		3/8" SPLIT WASHER
03A	3502		NYLON FLAT WASHER OD.158ID.110H.070

SEQ	PRODUCT CODE	REPLACEMENT PRODUCT	DESCRIPTION
---	-----	-----	-----
03A	3503		FIBRE WASHER 0.5ID, 0.75OD 0.04 THK
03A	3509		SWS 3602 BLK. SHOULD.WASHER(MICRO)
03A	3515		NYLON SHOULDER WASHER (SWS 4003)
03A	3524		NYLON SH/WASHER ID385 OD750 T060
03A	3577		FIBER WASHER .625OD .380ID .03
03A	8463		1.468 X .515 X .05 NYLON WASHER BLK
03A	8470		1.50 X .375 X .060 RUBBER WASHR BLK
03A	8981		RUBBER WASHER .312OD .150ID .093TH
03A	8468		VELCRO STRAP 3/4"X22CM (VELSTRAP)
03A	8480		VELCRO STRAP 1.5"X10.5',BLACK,HOOK
03A	3900		2/18 RUBBER SPEAKER WIRE
03A	3945		BLUE 22 AWG TR64 PREFUSED WIRE
03A	3989	N/A	2/16 RUBBER SPEAKER WIRE
03B	3926		BNC FEMALE PANEL MNT NON-INSUL
03B	3380		RED ON LEFT DUAL BINDING POST TPP5
03B	3385		RED ON RIGHT DUAL BINDING POST TPP5
03B	3397		RED ON RIGHT DUAL BINDING POST TPP4
03B	3406		GROUND POST - BANANA JACK J587-ND
03B	3410		RED ON LEFT DUAL BINDING POST TPP5
03B	3415		RED ON RIGHT DUAL BINDING POST TPP5
03B	3418		BND POST PCB MT VERT DUAL
03B	3419		RED BINDING POST TP3 CLIFF
03B	3447	3410 OR 34	DUAL BINDING POST TPP3
03B	3452		BND POST PCB MT HORZ QUAD ASSEMBLY
03B	3991		BANANA PLUG POMONA
03B	3427		MIDI JCK PCB MT HORZ 5PIN DIN
03B	3530		PCB CONN 20CIR TOP .100
03B	3992		121 INLINE JACK SWITCHCRAFT
03B	3449		REAN JACK NUT RED
03B	3444	SEE NOTES	1/4" JCK PCB MT VERT MONO TIP SWT
03B	3457	3458	11 JACK (SHORT, NO CENTRE TAB)
03B	3458	SEE NOTES	L11 JACK (LONG, NO CENTRE TAB)
03B	3497		1/4" JCK PCB MT VERT ISO
03B	3498		1/4" JCK PCB MT HORZ
03B	3523	3450	1/4" JCK PCB MT HORZ GOLD T__
03B	3527		1/4" JCK PCB MT HORZ GOLD __S
03B	3912	NP2RCS?	1/4" RIGHT ANGLE PHONEPLUG 228
03B	3918		1/4" JCK PCB MT HORZ SLIM W/SCREW
03B	3921		1/4" JCK PCB MT VERT STER RT SWT
03B	3924		1/4" JCK PCB MT VERT 2XTIP HICURNT
12B	3432		1/4" JCK PCB MT HORZ THIN
03B	3456		RCA DUAL PCB MT HORZ STACK W ON TOP
03B	3460		RCA DUAL PCB MT VERT GOLD .475"
03B	3466		RCA DUAL PCB MT VERT GOLD 24MM
03B	3886		36" RCA PREFAB CABLE RED
03B	3890		36" PREFAB. CABLE
03B	3902		72" RCA PREFAB CABLE STEREO
03B	3914		RCA SNGL PCB MT HORZ
03B	3628		SPKON 4C PCB MT VERT 250TAB GRY #4

SEQ	PRODUCT CODE	REPLACEMENT PRODUCT	DESCRIPTION
---	-----	-----	-----
03B	6956		SPKON 4C PCB MT HORZ GRY #4
03B	6958	NL8MPR	SPKON 8C PNL MT VERT 250TAB
03B	3417		6-32 SCREW TERMINAL PC MNT SNAP-IN
03B	3405		TERMINAL STRIP 5P #6 SCREW
03B	3450FW		FIBER WASHER FOR 3450 ALL GOLD PC M
03B	3450NUT		BLACK PLASTIC NUT FOR 3450 1/4"JACK
03B	NUTFOR3450		BLACK PLASTIC NUT FOR 3450 1/4"JACK
03B	3416		1/4"&XLR PCB MT VERT COMBO
03B	3445		1/4"&XLR PCB MT HORZ COMBO
03B	3453		XLR MALE PCB MT VERT
03B	3650		XLR ADPT PCB MT
03B	3657		XLR FEML PCB MT HORZ NO SHELL
03B	3659		XLR FEML PLASTIC
03B	3660		XLR FEML PCB MT HORZ
03B	3922		XLR FEML PCB MT HORZ THIN SNAP-IN
03B	3923		XLR MALE PCB MT HORZ MTHOLE-V SNAP
03B	3925		XLR FEML PCB MT VERT 24MM U-CONT
03B	4010		XLR FEML PCB MT VERT 24MM AA-SERIES
03C	6744		LM1458N IC DUAL OP AMP (4558)
03C	8803		8-32 X 3/8 PAN PHIL TAPTITE JS500
03C	8870		#4 X 1/4 PAN PH TYPE A ZINC
03C	8877	N/A	4-40 X 1/4 FILLISTER PH MS ZN
03C	8865		4-40 X 5/16 PAN PH MS JS500
03C	8729		#4 X 3/8 FLAT QUAD TYPE A JS500 BLK
03C	8742		4-40 X 3/8 PAN PH TAPTITE JS500
03C	8861		4-40 X 3/8 PAN PH MS JS500
03C	8863		4-40 X 3/8 HEX ND TAPTITE BO
03C	8867		4-40 X 3/8 FILLISTER PH MS JS500
03C	8741		4-40 X 1/2 PAN PH MS JS500
03C	8789		4-40 X 1/4 PAN PH MS ZINC
03C	8826		4-40 X 3/16 FLAT PHIL U/C TRILOB ZC
03C	8827		4-40 X 1/2 FLAT PH TAPTITE JS500
03C	8864	N/A	4-40 X 1/2 PAN PH TAPTITE JS500 BLK
03C	8946		4-40 X 5/16 FLAT PHIL U/C TRILOB ZC
03C	8871		4-40 X 5/8 PAN PH MS JS500
03C	8808	N/A	4-40 X 3/4 FL AT PH MS JS500
03C	8842		#4 X 5/16 PAN QUAD TYPE A JS500 BLK
03C	8799		#6 X 1/4 PAN PH TYPE B JS500
03C	8831		6-32 X 1/4 PAN PH TAPTITE ZN
03C	8832		6-32 X 1/4 PAN PH TAPTITE JS500
03C	8807		6-32 X 5/16 PAN PH MS JS500
03C	8839		6-32 X 5/16 FLAT PH MS BO
03C	8805		4-40 X 1/4 PAN PH TAPTITE BO
03C	8829		6-32 X 3/8 FLAT PH TAPTITE BO#C HEA
03C	8747	0	6-32 X 1/2 HEX ND MS ZINC
03C	8761		6-32 X 1/2 PAN PHIL MS ZINC CLEAR
03C	8825		6-32 X 1/2 FLAT PHIL TRILOB NICKEL
03C	8835		6-32 X 1/2 PAN QUAD MS TIN PLATED
03C	8837		6-32 X 1/2 ROUND PH MS JS500

SEQ	PRODUCT CODE	REPLACEMENT PRODUCT	DESCRIPTION
---	-----	-----	-----
03C	8856		6-32 X 1/2 HEX WASH SLOT MS ZINC
03C	8713		6-32 X 5/8 FL QD MS ZINC
03C	8755		#6 X 5/8 PAN PH TYPE A JS500 BLACK
03C	8757		#6 X 5/8 PAN PHIL TYPE A ZINC CLEAR
03C	8784		#6 X 7/16 PAN PH FRAMING BLACK PHOS
03C	8796		6-32 X 5/8 PAN PH TAPTITE ZINC
03C	8745		6-32 X 3/4 HEX ND MS ZINC
03C	8828		6-32 X 3/4 PAN PH TAPTITE JS500
03C	8830		6-32 X 7/8 PAN PH MS JS500
03C	8778		6-32 X 1.25 PN PH TAPTITE ZN
03C	8823		6-32 X 1 PAN PH TAPTITE JS500
03C	8838		6-32 X 1 HEX HD MS ZINC CLEAR
03C	8857	SEE INC.ST	#6 X 1 PAN PH TYPE A JS500
03C	8744	N/A	6-32 X 1 1/4 HH MS UD ZINC
03C	8812		#6 X 1 1/8 FLAT SQ. SOCKT CLEAR ZNC
03C	8984		#10 X 4 FLAT SOCKT WOOD ZINC CLEAR
03C	8986		6-32 X 1 1/2 PAN PH MS JS500
03C	8876		#6 X 1 1/2 PAN PH TYPE A JS500 BLK
03C	8878		#6 X 2" PAN PHIL TYPE A JS500 BLACK
03C	8824		8-32 X 5/16 PAN QUAD TAPTITE JS500
03C	8802		8-32 X 3/8 PAN QUAD #6HD TT JS500
03C	8810		8-32 X 3/8 PAN PHIL MS ZINC CLEAR
03C	8763		8-32 X 1/2 PAN PH MS JS500 BLACK
03C	8849		8-32 X 1 PAN PHIL MS TIN PLATED
03C	8869		8-18 X 1/2 THRD CUTTING FOR PLASTIC
03C	8779		1/4-20X 2 1/2 CARRIAGE BOLT ZINC
03C	8999		8-32 X 5/8 PAN PH TAPTITE JS500
03C	8719		8-32 X 3/4 FILLISTER PHIL MS JS500
03C	8767		#8 X 3/4 PAN PHIL TYPE A JS500 BLK
03C	8785		#8 X 3/4 OVAL PH TYPE A BLACK OXIDE
03C	8815		8-32 X 3/4 PAN PH TAPTITE JS500
03C	8722		#8 X 1" PAN QUAD TYPE AB B/O
03C	8874		8-32 X 1" PAN PHIL TAPTITE JS500
03C	8892		8-32 X 11/4" PAN PHIL TAPTITE JS500
03C	8804	N/A	8-32X1.25 PAN PH MS ZINC CLEAR
03C	8875		#8 X 1 1/2 PAN PH TYPE A JS500
03C	8990		#8 X 2 1/2 SCKT DECK SCRW FLT JS500
03C	8809		10-32 X 1/4 PAN PH TAPTITE JS500
03C	8624		10-32 X 1/2 HEX HD MS JS500 BLK
03C	8734		#10 X 1/2 PAN PH TYP A BRITE NICKEL
03C	8749		10-32 X 1/2 QDX PH TAPTITE JS500
03C	8758		#10 X 1/2 HEX HD TYPE A JS500 BLACK
03C	8762		10-32 X1/2 TRUSS QUAD TAPTITE JS500
03C	8868		10-32 1/2" FLAT PH 82' CS TT JS500
03C	8911		10-16 X 1/2 TYPE B HEX W/SLOT BL
03C	8731		10-16 X 5/8 TYPE B HEX W/SLOT JS500
03C	8708		10-32 X 3/8 FILLISTER QD MS ZN
03C	8754		#10 X 3/4 PAN PH TYPE A ZINC
03C	8756		#10 X 3/4 PAN PH TYPE A BLACK OXIDE

SEQ	PRODUCT CODE	REPLACEMENT PRODUCT	DESCRIPTION
03C	8707		#10 X 7/8 (#8 HEAD)FLAT PHIL TYPE A
03C	8781		#10 X 7/8 FLAT PHIL TYPE A JS500BLK
03C	8833		10-32 X 7/8 HEX CAP GRD 5 JS500
03C	8727		#10 X 1" PAN PH TYPE A JS500 BLACK
03C	8783		10-32 X 1 PAN QUAD TT JS500 BLACK
03C	8912		10-32 X 1 FLAT PHIL MS JS500 BLK
03C	8993	N/A	10-32 X 1" ALLEN HD CAP SCREW JS500
03C	8821		10-16 X 1 3/32 TYPE B HEX W/SLOT BL
03C	8893		10-32 X 1 FLAT PHILIPS TT JS500 BLK
03C	8786		10-32 X 1 1/4 PAN QD MS JS500 BLACK
03C	8992	N/A	10-32X1.25 ALLEN HD CAP SCREW JS500
03C	8773		10-32 X 1 1/4 PN PH TT FULL THD JS5
03C	8862		#10 X 1 1/2 PAN PH TYPE A JS500
03C	9930		#10 X 1 3/4 PAN PH TYPE A ZINC
03C	8751		10-32 X 2 PAN PH MS JS500
03C	8777		#14 X 1FLAT PH TYPE A JS500 M6 HEAD
03C	8906		#14X2 ALLEN FLAT HD WOOD SCRW JS500
03C	8928		#14X11/4 ALLEN FLHD WOOD SCRW JS500
03C	8935		1/4-20 X 23MM JOINT CON. BOLT B/O
03C	8769		1/4-20 X 3/8 ROUND QUAD MS ZINC
03C	8772		1/4-20 X 1 TRUSS PH MS JS500 BLACK
03C	8936		1/4-20 X 3/4 PAN PH MS BLACK OXIDE
03C	8846		1/4-20 X 1 3/4 FLAT PH MS JS500
03C	8847		1/4-20 X 1 1/4 FLAT PH MS JS500
03C	8770		1/4-20 X 1 5/16 TRUSS PH MS JS500
03C	8709		1/4-20 X 1.5 PAN PHIL MS ZINC CLEAR
03C	8774	N/A	1/4-20 X 1 1/2 GRD 5 BUTTON HEX JS5
03C	8927		1/4-20 X 3/4 HEX HEAD BOLT
03C	8948		1/4-20 X 1 1/2 HEX HEAD BOLT
03C	8907		1/4-20 X 2 1/4 HEX BOLT GR 2 FUL TD
03C	8714		1/4-20 X 2 PAN QUAD JS500
03C	8765		1/4-20 X 2 1/2 HEX HD MS JS500 BLK
03C	8768		5/16-18X2 1/2 CARRIAGE BOLT ZINC
03C	8780		5/16-18 X 3 3/4 CARRIAGE BOLT FT ZN
03C	8926		5/16-18X3 CARRIAGE BOLT ZINC
03C	8733		5/16-18X2-1/2 GRD 5 HEX BOLT JS500
03C	8941		M12 X 60 GRD 5 HEX CAP SCREW ZINC
03C	8736		5/16-18X2-3/4 GRD 5 HEX BOLT JS500
03C	8711		5/16-24 X 3 GRD 5 HEX BOLT JS500
03C	8740		5/16-18 X 3 GRD 5 HEX BOLT JS500
03C	8794		5/16-18 X 3 1/2 GRD5 HEX BOLT JS500
03C	8860		1/2-13 X 1 HEX CAP SCREW ZINC
03C	8882		1/2-13 X 5 BOLT ZINC
03C	8985		M5 X 60 PAN PHIL MS JS500 BLACK
03C	8879		M5 X 10 DIN 7985 MS ZINC SCREW
03C	8903		M5 X 16 DIN 7985 HH ZINC SCREW
03C	8943		M12 STEEL FLAT WASHER,ZINC CLEAR
03C	8987		M5 X 25 PAN PHIL JS500 ZINC
03C	8991		M5 X 35 PAN PHIL JS500 BLACK

SEQ	PRODUCT CODE	REPLACEMENT PRODUCT	DESCRIPTION
---	-----	-----	-----
03C	8995		3/8" STEEL FLAT WASHER,ZINC CLEAR
03C	8723		M6 X 12 PAN PHILIPS M/S CLEAR ZINC
03C	8730		M6 X 16 HEX BOLT ZINC
03C	8737		M6 X 25 PAN PHIL M/S ZINC CLEAR
03C	8739		M6 X 30 PAN PHIL M/S ZINC CLEAR
03D	8557		GABLE, 3-HOLE AP MIXERS STYLE 2
03D	8568		GABLE, 4-HOLE PM MIXER STYLE 3
03D	8428L		M8 LEFT CORNER
03D	8428R		M8 RIGHT CORNER
03D	8528WS		BUMPER, PM22 SERIES 31.575"
03D	8553WS		BUMPER,GENERIC 17.250"
03D	NX15BACK	NX15CABINE	15"NX XOVER BACK BLACK PLASTC
03D	NX15FRONT		15"NX FRONT PART ONLY PLASTC
03D	NX15PCABINET		15"NX CAB EMPTY,COMPLETE, BLACK
03E	8506		BLANK CROSSOVER DISH PLASTIC ROMAC
03E	8509		BLACK BLANK XOVERDISH PLASTIC CNFG1
03E	8511		BLACK BLANK XOVERDISH PLASTIC CNFG3
03E	8513		WHITE BLANK XOVERDISH PLASTIC CNFG4
03E	8514		BLACK BLANK XOVERDISH PLASTIC CNFG5
03E	8515		SMALL BLACK XOVERDISH PLASTIC CNFG1
03E	8516		SMALL BLACK XOVERDISH PLASTIC CNFG2
03F	8392		KNOB STYLE 1 RED
03F	8393		KNOB STYLE 1 GREY
03F	8394		KNOB STYLE 1 GREEN
03F	8395		KNOB STYLE 1 BLUE
03F	8397		KNOB STYLE 2 GREY
03F	8399		KNOB BASSMASTER NICKEL/CHROME
03F	8400		KNOB BASSMASTER NICKEL/CHROME STP
03F	8401		TRAYNOR KNOB, CHROME PLATED
03F	8430		KNOB CHICKEN-BEAK
03F	8433		KNOB AP SERIES PLASTIC
03F	8590		KNOB SLIDE POT GREEN
03F	8591		KNOB SLIDE POT RED
03F	8614	N/A	KNOB ROUND TRAYNOR
03F	8619	8693	L-PAD KNOB #TP-150-006 BLACK(SIFAM)
03F	8627		KNOB LIGHT SHOW BLACK W/GRAY CAP
03F	8632		KNOB ROUND PUSHBUTTON 1/4" GREY
03F	8633		KNOB ROUND PUSHBUTTON 1/4" BLACK
03F	8637		ROUND PUSH BUTTON 1/4" BLK 24MM
03F	8638		KNOB APMIXER PUSHSW BUTTON GREY
03F	8641		KNOB AM SERIES AQUA
03F	8642		KNOB AM WINE RED MAROON
03F	8645	8704	KNOB ROTARY PLASTIC W/RED INSERT
03F	8647	SEE INC.ST	KNOB MC SERIES 1A951
03F	8648	SEE INC.ST	KNOB SWITCH ITT BLACK
03F	8649		BUTTON KNOB FLAT BLACK
03F	8650		KNOB 10081-309 PREH-MOMNTRY RED
03F	8655		KNOB BUTTON REAN P120-OX BLACK
03F	8659		TX SERIES PUSH SW CAP GREY

SEQ	PRODUCT CODE	REPLACEMENT PRODUCT	DESCRIPTION
---	-----	-----	-----
03F	8660		KNOB RLP-KB7 BLACK W/GREY CAP
03F	8661		KNOB BUTTON FLAT GREY
03F	8677		KNOB ROTARY RED ON BLACK
03F	8680		KNOB AP-812 GREY FADER
03F	8686	8702	KNOB MICROMIX ROT GREEN
03F	8693		KNOB S ROTARY GREY
03F	8695	8695ANO	KNOB AP-SERIES BARE 6061-T6 ALUM
03F	8702		KNOB MICROMIX/AP GREEN
03F	8703		KNOB MICROMIX/AP BLUE
03F	8704		KNOB MICROMIX/AP RED
03F	8705	8660	KNOB MICROMIX/AP GREY
03F	8706		KNOB ROTARY BLACK BLUE POINT
03F	8715		KNOB MM-6 GREEN CORE PIN5-8
03F	8716		KNOB MM-6 BLUE CORE PIN5-8
03F	8717		KNOB MM-6 RED CORE PIN5-8
03F	8718		KNOB MM-6 GREY CORE PIN5-8
03F	8859		KNOB LP-304 THUMB-SCREW FOR 8858
03F	9915		KNOB 0-DEG RED SOFT GRAY RIB
03F	9916		KNOB 0-DEG GRY SOFT GRAY RIB
03F	9917		KNOB 0-DEG GRN SOFT GRAY RIB
03F	9918		KNOB 0-DEG BLU SOFT GRAY RIB
03F	9919		KNOB 0-DEG YEL SOFT GRAY RIB
03F	9920		KNOB 0-DEG WHT SOFT GRAY RIB
03F	9921		KNOB 0-DEG GRY W/O COVERING
03F	8300R		KNOB 90DEG-R RED SOFT GRAY RIB
03F	8873		1.2500DX5/16ID FENDER WASHER BARE
03F	8891		2"OD X 17/32ID FENDER WASHER ZINC
03F	8944		2" OD X 17/32 ID FENDER WASHER ZINC
03F	8947		1.2500DX1/4 ID FENDER WASHER ZINC
03G	3390		6' 3X.075MM AC LINE CORD EURO-REMOV
03G	3401	4045 POWER	30 AMP 125V TWISTLOC PLUG
03G	3403		6' 16AMP250VAC LINE CORD EURO-REMOV
03G	3426		8' 3/16 SJT AC LINE CORD REMOV-B-CSA
03G	3428		8' 3/18 SJT AC LINE CORD REMOVABLE
03G	3431		9' 2/18 SJT AC LINE CORD" T" JAPANESE
03G	3461		8' 3/18 SVT AC LINE CORD
03G	3468		8' 3/16 SJT AC LINE CORD STRIP 17"
03G	3471		8' 3/16 SJT AC LINE CORD 250 CLIPS
03G	3474		6' 3X.075MM AC LINE CORD EURO-REMOV
03G	3479		12' 3/16 SJT AC LINE CORD BLACK 250"
03G	3481		8' 3/18 SJT AC LINE CORD 250 CLIPS
03G	3483		6' 3X.075MM AC LINE CORD EURO PLUG
03G	3484		8' 3/18 SJT AC LINE CORD 250WH187BL
03G	3821		STRAIN RELIEF HEYCO #1200
03G	3826		STRAIN RELIEF HEYCO #1150
03G	3829		STRAIN RELIEF HEYCO #1207
03G	3834		STRAIN RELIEF HEYCO #1214
03G	3838		STRAIN RELIEF HEYCO #1147
03G	3839		STRAIN RELEIF 0.8 INCH W/DOME NUT



SEQ	PRODUCT CODE	REPLACEMENT PRODUCT	DESCRIPTION
---	-----	-----	-----
03H	3920		HEATSHRINK PRECUT WITH L&M PRINT
03H	3666		_2.0" 4C-26AWG RIBBON CABLE 0.1"
03H	3616		_7.0" 4C-26AWG RIBBON CABLE 0.1"
03H	3690		_8.0" 4C-28AWG RIB 1 W/LCK HDR 098R
03H	3565		10.0" 4C-28AWG RIBBON CABLE 0.1"
03H	3678		14.0" 4C-26AWG RIBBON CABLE 0.1"
03H	3680		14.0" 4C-28AWG RIB 1 W/LCK HDR 098R
03H	3623		17.0" 4C-26AWG RIBBON CABLE 0.1"
03H	3625		_4.5" 5C-26AWG RIB 3/4" NOTCH 0.1"
03H	3609		_6.0" 5C-26AWG RIBBON CABLE 0.1"
03H	3574		_9.0" 5C-22AWG RIBBON CABLE 0.1"
03H	3594		_9.5" 5C-24AWG RIB.5NTCH HITMP 0.1"
03H	3709		_7.0" 6C-26AWG RIB 1 W/LCK HDR 098"
03H	3514		10.0" 6C-26AWG RIB 1 W/LCK HDR 098"
03H	3710		17.0" 6C-26AWG RIB 1 W/LCK HDR 098"
03H	3665		_2.0" 8C-26AWG RIBBON CABLE 0.1"
03H	3619		_4.75 8C-22AWG RIB 3/4" NOTCH 156"
03H	3677		_5.0" 8C-26AWG RIB 3/4" NOTCH 0.1"
03H	3621		10.0" 8C-26AWG RIB 3/4" NOTCH 0.1"
03H	3664		13.0" 8C-26AWG RIB 1 W/LCK HDR 098"
03H	3681		13.0" 8C-28AWG RIB 1 W/NP HDR 098"
03H	3706		13.0" 8C-26AWG RIB 1 W/LCK HDR 098"
03H	3614		16.0" 8C-24AWG TELEPHONE CABLE.050"
03H	3595		17.0" 8C-24AWG RIB.5NTCH HITMP 0.1"
03H	3508		20.0" 8C-26AWG RIB 1 W/LCK HDR 098"
03H	3535		10.0" 9C-26AWG RIB 1 W/LCK HDR 098"
03H	3608		10.0" 9C-24AWG RIBBON HITMP 0.1"
03H	3610		10.0" 9C-26AWG RIB 3/4" NOTCH 0.1"
03H	4001		_8.5"10C-26AWG RIB 1 W/LCK HDR 098"
03H	4003		_8.5"10C-26AWG RIB 1 W/LCK HDR 098"
03H	3639		_1.7"12C-26AWG RIBBON 0.25"S&R 098"
03H	3679		_6.0"12C-28AWG RIB 1 W/NP HDR 0.1"
03H	3740		15.0"12C-26AWG RIB 1 W/LCK HDR 098"
03H	3519		28" 12C-26AWG RIB 1 W/LCK HDR 098
03H	3642		10 □12C-FFC CABLE 7.5MMBACKING-PINS
03H	3603		16" 13C-24AWG RIBBON CABLE 0.1"
03H	3622		14" 14C-28AWG DIP HDR CABLE .05"
03H	3734		16" 14C-26AWG RIB 1 W/LCK HDR 098
03H	3604		21" 14C-28AWG DIP HDR CABLE .05"
03H	3626		12" 16C-28AWG RIBBON CABLE SOCKETS
03H	3673		12" 16C-28AWG DIP HDR CABLE .05"
03H	3790		EMI FILTER FOR RIBBON CABLE

SEQ	PRODUCT CODE	REPLACEMENT PRODUCT	DESCRIPTION
---	-----	-----	-----
04A	8434		AP SERIES PLASTIC HANDLE PAIR
04A	8451		10" STRAP HANDLE, BLACK METAL ENDCAP
04A	8456		10.0" STRAP HANDLE, NICKEL COVERS
04A	8458		10.5" STRAP HANDLE, PLASTIC COVERS
04A	8459		9.5" STRAP HANDLE, PLASTIC COVERS
04A	8534		GREY BAR HANDLE ALL METAL
04A	8540		HANDLE BAR, ZINC DIECAST
04A	8541		HANDLE BAR, WHITE
04A	8542		HANDLE, RECESSED, PULL, BLACK PLASTIC
04A	8551		BAR HANDLE RIGHT ANGLE TOP LOAD
04A	8560	8564?	POCKET HANDLE, PLASTIC, RECTANGULAR
04A	8564		SMALL BAR HANDLE ALL METAL
04A	8565		BAR HANDLE ALL METAL RECTANGULAR
04A	8571	N/A	U-SHAPE ALUMINUM OVAL BLACK HANDLE
04A	8675		XS800H HANDLE - BARE 6061-T6 ALUMIN
04A	8694		S-SERIES HANDLE BARE 6061-T6 ALUM
04A	8696		AP-SERIES HANDLE- BARE 6061-T6 ALUM
04A	8694ANOBLK		HANDLE, USHAPE OVAL BLACK ANO ALUMIN
04A	8696ANO		HANDLE, USHAPE OVAL GRAY ANO ALUMIN
04B	8245		PULSE SMALL LEXAN LABEL
04B	8246		LEXAN LABEL PULSE LARGE
04B	Z464		Y LOGO BLACK 1.5" X 1.5" LEXAN
04B	8235		LOGO PULSE SERIES MEDIUM DOMED
04B	8236		LOGO PULSE SERIES LARGE DOMED
04B	8239		LOGO PERFORMANCE LARGE DOMED
04B	8243		LOGO PULSE SERIES LARGE
04B	8260	8264	LOGO TRAYNOR YCV EMBOSSED ALUM
04B	8264		LOGO TRAYNOR YBA/YCV EMBOSSED ALUM
04B	8267		LOGO TRAYNOR SMALL EMBOSSED ALUM
04B	8453		LOGO YS 7/8X7/8 BLACK LEXAN
04B	8239D		LOGO YORKVILLE SMALL WHITE DOMED
04B	8240D		LOGO YORKVILLE SMALL BLUE DOMED
04B	8243D		LOGO BASSMASTER LARGE DOMED
04B	8255D		LOGO YSM1/P SMALL BLUE DOMED
04B	8256D		LOGO YSM1P LEFT ACTIVE LED DOMED
04B	8257D		LOGO YSM1P RIGHT ACTIVE LED DOMED
04B	8259D		LOGO ELITE SERIES LARGE DOMED

SEQ	PRODUCT CODE	REPLACEMENT PRODUCT	DESCRIPTION
---	-----	-----	-----
05A	7272		_8R 50W 1.00" DRIVER BOLT ON
05A	7283		16R 50W 1.00" DRIVER BOLT ON EMIN
05A	7286		_8R 30W 4.75" TWEETER
05A	7393		_8R 30W 1.00" DRIVER BMS
05A	7395		_8R 30W 1.00" DRIVER COMP PWRLINE
05A	7398		_8R 30W 1.00" DRIVER N270TIT RCF
05A	7401		_8R 120W 1.50" DRIVER TI DE72P B&C
05A	7402		_8R 45W 1.00" DRIVER 4550-8R BMS
05A	7403		_8R 100W 2.00" DRIVER DE750YT B&C
05A	7411		_8R 30W TWEETER PIEZO TLC/2-4
05A	7413	?? SEE NOT	_8R 50W TWEETER PIEZO MOTOROLA
05A	7414	7286	_8R 50W TWEETER 4.5X4.5" FOSTER
05A	7417		_8R 30W TWEETER PIEZO TLC 1
05A	7418	7435	_8R 30W TWEETER PIEZO KSN1056A
05A	7428		_8R 35W TWEETER PIONEER
05A	7429		4R 30W TWEETER RADIAL PIEZO
05A	7435		_8R 50W TWEETER PIEZO
05A	7448		_8R 40W 1.00" DRIVER HD120F8R
05A	7450		_8R 60W 1.00" DRIVER CELESTION
05A	7461		_8R 40W 1.00" DRIVER CDX1-1425 CEL
05A	CP16		_8R ??W TWEETER CP-1 BEYMA
05A	DE-10		_8R 40W 1.00" DRIVER DE-10-8 B&C
05A	DE-10KIT		_8R 40W 1.00" DRIVER KIT DIAP B&C
05A	DE600		_8R 75W 1.40" DRIVER DE600 B&C
05A	DE-72P	7401	_8R 100W 2.00" DRIVER PLAST PH B&C
05A	N252		_8R 30W 1.00" DVR&HORN N25 RCF
05A	N252XN		_8R 30W 1.00" DRIVER N252XN RCF
05A	N255	SEE NOTES	_8R 30W 1.00" DVR&HORN N25 RCF
05A	D-24		1" 16R 80W DRIVER MYLR B&C 7437
05A	D-32		_ 8R 18W BULLET B&C 7435
05A	DE-15	N/A	1" 8R 60W DRIVER DE-15-8R 7441
05A	DE-45	7272	1" 8R 80W DRIVER TITANIUM
05A	DE-75	7403	2" 8R 120W DRIVER BBC 7436
05A	N481YK	7272	1" 8R 30W DRIVER RCF-N481
05B	7405		5" 8R 30WPGM SPEAKER SEALED/BACK
05B	7289	7291+SEE N	6.5"8R 75WPGM SPEAKER
05B	7291		6.5"12R 75WPGM SPEAKER
05B	AM100WFR		6.5" SPEAKER
05B	7328		8" 4R 75WPGM SPEAKER
05B	7329		8" 8R 125WPGM SPEAKER
05B	7330		8" 16R 100WPGM SPEAKER
05B	7331		8" 8R 50WPGM SPEAKER
05B	7426		8" 32R 100WPGM SPEAKER CELESTION
05B	HM210Z8		8"8R RECONED HM210Z8 SPKR
05B	7264		10" 4R9 150WPGM SPEAKER
05B	7265		10" 8R 300WPGM SPEAKER
05B	7266		10" 2R 200WPGM SPEAKER
05B	7269		10" 4R 350WPGM SPEAKER CAST FRAME
05B	7273	7269? SEE	10" 4R 300WPGM SPEAKER

SEQ	PRODUCT CODE	REPLACEMENT PRODUCT	DESCRIPTION
---	-----	-----	-----
05B	7278	7265	10" 8R 200WPGM SPEAKER
05B	7281	7406	10" 16R 150WPGM SPEAKER
05B	7284		10" 8R 150WPGM SPEAKER
05B	7318	N/A	10" 8R 100WPGM SPEAKER
05B	7322		10" 4R 50WPGM SPEAKER
05B	7337		10" 4R 50WPGM SPEAKER
05B	7399		10" 8R 300WPGM SPKR NEO 10HPL64
05B	7406		10" 16R 150WPGM SPEAKER
05B	7463	7467	10" 8R 160WPGM SPEAKER 18SOUND
05B	7467		10" 8R 160WPGM SPKR NEO 18SOUND
05B	L10/500	7273	10" 4R 100WPGM SPEAKER RCF-L10
05B	L10/581RC		10" 8R 160WPGM RECONED SPEAKER
05B	L10/750		10" 8R 300WPGM SPEAKER
05B	TUBE10	SPK0002	10" 8R 30WPGM SPKR CELESTION
05B	7078		12" 8R 25WPGM SPKR CELESTION
05B	7079		12" 8R 50WPGM SPKR CELESTION
05B	7080		12" 8R 80WPGM SPKR CELESTION
05B	7081		12" 8R 60WPGM SPKR CELEST VINT30
05B	7082		12" 16R 60WPGM SPKR CELEST VINT30
05B	7282		12" 8R 350WPGM SPEAKER
05B	7285	7282	12" 8R 250WPGM SPEAKER
05B	7288		12" 4R 100WPGM SPEAKER
05B	7295		12" 4R 250WPGM SPEAKER
05B	7317		12" 8R 150WPGM SPEAKER
05B	7388		12" 2R 170WPGM WOOF POLY/RUB SRND
05B	7409		12" 4R 300WPGM SPEAKER EMININENCE
05B	7452		12" 8R 75WPGM SPEAKER
05B	7455		12" 4R 450WPGM SPEAKER (T5432)
05B	7456		12" 8R 350WPGM SPEAKER (T5431)
05B	7472		12" 8R 350WPGM SPKR NEO
05B	12/059Y8M	SEE PROD.N	12" 8R 350WPGM SPEAKER
05B	12HPL64-8	7456	12" 8R 350WPGM SPKR NEO B&C
05B	12PE31E4R	12/150Y4M	12" 4R 350W SPEAKER BBC12PE31E4R
05B	12PE324R	12/150Y4M	12" 4R 350WPGM SPEAKER
05B	12PE328R	7456	12" 8R 350WPGM SPEAKER
05B	L12P11W		12" 8R 450WPGM SPEAKER
05B	SPK0026		12" 8R 75WPGM SPEAKER
05B	7308		15" 8R 300WPGM SPEAKER
05B	7309	7308	15" 8R 300WPGM SPEAKER
05B	7311		15" 8R 200WPGM SPEAKER
05B	7316		15" 2R 200WPGM SPEAKER
05B	7333	7475	15" 8R 300WPGM SPEAKER
05B	7336		15" 8R 225WPGM SPEAKER
05B	7347		15" 4R 200WPGM SPEAKER BASS
05B	7352	7347	15" 4R 200WPGM SPEAKER
05B	7392	7479+SEE N	15" 8R 450WPGM SPKR B&C15/244-8
05B	7400	7422	15" 8R 800WPGM SPKR B&C15/257Y8M
05B	7404		15" 4R 800WPGM SPEAKER 18SOUND
05B	7407		15" 8R 800WPGM SPKR NEO 18SOUND

SEQ	PRODUCT CODE	REPLACEMENT PRODUCT	DESCRIPTION
---	-----	-----	-----
05B	7410		15" 8R 600WPGM SPKR NEO 15-286-8
05B	7427	7466	15" 8R 500WPGM SPEAKER
05B	7436		15" 8R 500WPGM SPKR NEO
05B	7439		15" 8R 800WPGM SPKR NEO
05B	7442	7308	15" 8R 300WPGM SPEAKER
05B	7443		15" 8R 400WPGM SPEAKER
05B	7444	7446	15" 4R 350WPGM SPEAKER
05B	7445	7443	15" 8R 450WPGM SPEAKER
05B	7446		15" 4R 600WPGM SPEAKER
05B	7447		15" 8R 1000WPGM SPEAKER
05B	7449		15" 16R 400WPGM SPEAKER
05B	7451		15" 8R 400WPGM SPEAKER
05B	7466		15" 8R 500WPGM SPKR NEO
05B	7468		15" 8R 500WPGM SPKR NEO
05B	7471		15" 8R 1000WPRGM 3"V.C. NEO SPEAKER
05B	7475		15" 8R 400WPGM SPEAKER
05B	15/138Y8M		15" 8R 500WPGM SPEAKER
05B	152198R		15" 8R 400WPGM SPKR NEO 15-219-8
05B	15PL408R	7392 (OR 7	15" 8R 400WPGM SPEAKER
05B	L15K80Y		15" 8R 500WPGM SPEAKER -RECONED
05B	L15K81Y	SEE NOTE	15" 4R 400WPGM SPEAKER
05B	7268		18" 2R 200WPGM SPEAKER SUBWOOFER
05B	7276		18" 8R 350WPGM SPEAKER
05B	7458	7465	18" 4R 800WPGM SPEAKER
05B	7460	7469	18" 4R 1200WPGM SPEAKER DCR3.9R
05B	7465		18" 8R 1200WPGM NEO SPEAKER
05B	7469		18" 4R 1200WPGM NEO SPEAKER
05B	18/029Y4M	RECONES-SE	18" 8R 800WPGM SPKR-RECONE ONLY
05B	18/063Y4M	7460	18" 4R1200WPGM SPEAKER DCR3.9R
05B	L18/851	L18Y800	18" 4R 800WPGM SPEAKER
05B	L18P751	L18P540	18" 8R 400WPGM SPEAKER RCF-L188
05B	15PE408RBSK		RECONE KIT FOR 15PE408R BBC
05C	7283KIT		EMINENCE 1" COMP.DRV RECONE KIT
05C	7410KIT		RECONE KIT 15" 8R 600WPGM NEO SPEAK
05C	7436KIT		RECONE KIT 15" 8R 500WPGM NEO SPEAK
05C	10/039R8KIT	SEE NOTES	RECONE KIT FOR EX-250 8R
05C	10/581R		RECONE KIT FOR 10/581R RCF
05C	10/750R		RECONE KIT FOR 10/750R RCF 10
05C	10MB400KIT		RECONE KIT FOR 10 8R 18SOUND
05C	12/059Y8MKIT		RECONE KIT FOR 12/059Y8M
05C	12/150Y4MKIT		RECONE KIT FOR 12/150Y4M
05C	12584R	N/A	RECONE KIT FOR L12584 SPEAKER
05C	12HPL644RKIT	SEE NOTES	RECONE KIT FOR 12 4R NEO
05C	12HPL648RKIT		RECONE KIT FOR 12 8R NEO
05C	12PE31E4RKIT		RECONE KIT FOR 12PE31 4R BBC
05C	12PE31E8RKIT		RECONE KIT FOR 12PE31E 8R BBC
05C	12PE324RKIT		RECONE KIT FOR 12PE32 4R BBC
05C	12PE328RKIT		RECONE KIT FOR 12PE32 8R BBC
05C	15/138Y8MKIT		RECONE KIT FOR 15/138Y8M

SEQ	PRODUCT CODE	REPLACEMENT PRODUCT	DESCRIPTION
---	-----	-----	-----
05C	15/139Y8MKIT		RECONC KIT FOR 15/139Y8M
05C	152198RKIT		RECONC KIT FOR 15 8R NEO
05C	15K80R		RECONC KIT FOR L15K80Y
05C	15K81R		RECONC KIT FOR L15K81Y
05C	15PE408RKIT		RECONC KIT FOR 15PE408R BBC
05C	15PL408RKIT		RECONC KIT FOR 15PL408R B&C
05C	18/029Y4MKIT		RECONC KIT FOR 18/029Y4M B&C
05C	18/063Y4MKIT		RECONC KIT FOR 18/063Y4M
05C	18/063Y8MKIT		RECONC KIT FOR 18/063Y8M
05C	18/651R		RECONC KIT FOR L18/651 SPEAKER
05C	18/851KNR		RECONC KIT RCF L18/851KN
05C	18P300R		RECONC KIT FOR L18P300
05C	18P751R		RECONC KIT FOR RCF L18P751
05C	18Y800R		RECONC KIT RCF L18Y800
05C	6000WFRK	N/A, NO SUB	RECONC KIT FOR SCD6000
05C	7392KIT		RECONC KIT FOR 15 8R 400WPGM
05C	7399KIT		RECONC KIT FOR 10 8R 300WPGM NEO
05C	7400KIT		RECONC KIT FOR 15 8R 800WPGM
05C	7404KIT		RECONC KIT FOR 15 5R NEO
05C	7407KIT		RECONC KIT FOR 15 8R NEO
05C	7422KIT		RECONC KIT FOR 15 8R NEO
05C	7439KIT		RECONC KIT FOR 15" 8R 800WPGM NEO
05C	7440KIT		15" RECONC KIT FOR 7440 SPEAKER
05C	7458KIT		RECONC KIT FOR 7458 ONLY B&C
05C	7459KIT		RECONC KIT FOR 7459 ONLY B&C
05C	7460KIT		RECONC KIT FOR 7460 ONLY B&C
05C	7465KIT		RECONC KIT FOR 18/063N8
05C	7466KIT		RECONC KIT FOR 18 8R NEO
05C	7467KIT		RECONC KIT FOR 18 8R
05C	7468KIT		RECONC KIT FOR 7468
05C	7469KIT		RECONC KIT FOR 18/063N4
05C	7472KIT		RECONC KIT FOR 12" 8R 350WPGM SPK
05C	7479KIT		RECONC KIT FOR 15 8R NEO
05C	7483KIT		RECONC KIT FOR 10NW64-8R
05C	7485KIT		RECONC KIT FOR 7485KIT4M
05C	HM210Z8KIT		RECONC KIT FOR HM210Z8
05C	PS46Y8MKIT		RECONC KIT FOR 18 8R 600WPG DCR6
05C	RX-18KIT		RECONC KIT FOR RX-18 B&C
05D	7412	N/A	2 EV-2012 REPLACEMENT DIAPHRAGM
05D	7425		DIAPHRAGM FOR 7424CP25/22 REPL DIA
05D	7434		DIAPHRAGM FOR FOSTER 7360, 7414
05D	6000MRD		DIAPHRAGM FOR M6002MR SCD6000 MIDR
05D	6020WFR	N/A	DIAPHRAGM FOR SCD6020
05D	7272KIT		DIAPHRAGM FOR 8R 7272
05D	7393KIT		DIAPHRAGM FOR 8R 30W 1DRIVER BMS
05D	7398KIT		DIAPHRAGM FOR RCF-N270 M90
05D	7401KIT		DIAPHRAGM FOR DE-72, DE-75 & DE-750
05D	7402KIT		DIAPHRAGM FOR 8R 45W 1 DRIVER BMS
05D	7403KIT	7401KIT	DIAPHRAGM FOR 8R 100W 2DE750YT DRV

SEQ	PRODUCT CODE	REPLACEMENT PRODUCT	DESCRIPTION
---	-----	-----	-----
05D	7447KIT		15" 8R1000WPGM RECONE KIT
05D	7448KIT		DIAPHRAGM FOR 8R 40W 1 HD 120
05D	7450KIT		DIAPHRAGM FOR CDX1-1730/1745
05D	7453KIT	7461KIT	DIAPHRAGM FOR 7453 1" DRIVER
05D	7461KIT		DIAPHRAGM FOR 7461 1" DRIVER
05D	7484KIT		DIAPHRAGM FOR 16R 80W 1" DRVR BMS
05D	CP16KIT		DIAPHRAGM FOR BEYMA CP16 TWEETER
05D	D-24KIT		DIAPHRAGM FOR BBC 1 DRIVER
05D	D-32KIT		DIAPHRAGM FOR 1.25" BBC BULLET
05D	DE-15KIT		DIAPHRAGM FOR DE-15
05D	DE-45KIT		DIAPHRAGM FOR DE-45
05D	DE600KIT		DIAPHRAGM FOR 8R 75W 1.4 DE60
05D	M-58		DIAPHRAGM FOR SCD6000 TWEETER
05D	M-65		DIAPHRAGM FOR M-65 N481K
05D	M-73		DIAPHRAGM FOR RCF N252
05E	8885		NEOPRENE EMINENCE DRIVER GASKET
05E	8886		NEOPRENE N252 DRIVER GASKET
05F	H01		HORN 1.0" 60X40 1KHZ CUTOFF STY
05F	H02		HORN 1.0" 60X CONICAL TRACTRIX STY
05F	H03		HORN 1.0" 60X40 2KHZ CUTOFF STY
05F	H04		HORN 1.0" 55X75X60 STY
05F	H05		HORN 1.0" 60X40 STY
05F	H08		HORN 2.0" 60X40 800HZ CUTOFF STY
05F	H09A		HORN 60 X 40 2" STY 1000HZ CUTOFF
05F	H10		HORN 1.0" 90X40 1KHZ CUTOFF STY
05F	H11		HORN 1.0" 60X90 ___HZ FOR PL315
05F	H14		HORN 1.5" 90X30 BI-RADIAL
05F	H2006	NOT AVAIL	HORN 0.7" 80X120 RCF 7342 RESIN ABS
05F	H2009		HORN 100X60 RCF ALUM
05F	H31		HORN 1.0" 80X50 1KHZ CUTOFF
05F	H32		HORN -FOR UNITY 15 CABINET-
05F	H33		HORN 1.0" 60X40 1.5KHZ CUTOFF
05F	H3709		HORN 1.0" 90X40 RCF 7343 ALUM
05F	H6040		HORN 2.0" RCF-H60 PLASTIC
05F	P11		FOAM PHASING PLUG
05F	H9041	N/A	HORN 90X40 1" POLYURATHAN RCF 7297
05F	N252PP		PHASE PLUG FOR N252

SEQ	PRODUCT CODE	REPLACEMENT PRODUCT	DESCRIPTION
---	-----	-----	-----
06A	3412		LOWPROFILE FUSEHOLDER FOR .25X1.25
06A	3413		LOWPROFILE FUSEHOLDER FOR 5X20MM
06A	3414		INTERNATIONAL PC MOUNT FUSEHOLDER
06A	3482		LOWPROFILE FUSEHOLDER 1/4" BUSSMANN
06B	2435		_0.100 AMP SLO-BLO .25X1.25 FUSE
06B	2431		_0.200 AMP SLO-BLO .25X1.25 FUSE
06B	2430		_0.250 AMP SLO-BLO .25X1.25 FUSE
06B	2477	2413	_0.500 AMP SLO-BLO .25X1.25 FUSE
06B	2480		_0.600 AMP SLO-BLO .25X1.25 FUSE
06B	2468		_0.800 AMP SLO-BLO .25X1.25 FUSE
06B	2449		_1.0 AMP SLO-BLO .25X1.25 FUSE
06B	2439		_1.25 AMP SLO-BLO .25X1.25 FUSE
06B	2406		_1.6 AMP SLO-BLO .25X1.25 FUSE
06B	2486		_1.5 AMP SLO-BLO T&R FUSE
06B	2425		_2.0 AMP SLO-BLO .25X1.25 FUSE
06B	2407		_2.5 AMP SLO-BLO .25X1.25 FUSE
06B	2453		_3.0 AMP SLO-BLO .25X1.25 FUSE
06B	2410		_4.0 AMP FAST-BLO .25X1.25 FUSE
06B	2415		_5.0 AMP FAST-BLO .25X1.25 FUSE
06B	2427		_5.0 AMP SLO-BLO .25X1.25 FUSE
06B	2409		_6.0 AMP FAST-BLO .25X1.25 FUSE
06B	2428		_6.0 AMP SLO-BLO .25X1.25 FUSE
06B	2465		_7.0 AMP FAST-BLO .25X1.25 FUSE
06B	2487		_7.0 AMP SLO-BLO T&R FUSE
06B	2414		_8.0 AMP SLO-BLO .25X1.25 FUSE
06B	2405		10.0 AMP SLO-BLO .25X1.25 FUSE
06B	2438		12.0 AMP SLO-BLO .25X1.25 FUSE
06B	2484		15.0 AMP SLO-BLO .25X1.25 FUSE
06B	2481		T80MA 5X20MM FUSE
06B	2478		T250MA 5X20MM FUSE
06B	2462		T400MA 5X20MM FUSE
06B	2476		T800MA 5X20MM FUSE
06B	2471		T1A 5X20MM FUSE
06B	2402		T1,25A 5X20MM FUSE
06B	2473		T1,6A GDC BUSSMANN 5X20MM FUSE
06B	2403		T2,0AL 5X20MM FUSE
06B	2470		F2A 5X20MM FUSE
06B	2400		T2,5A 5X20MM FUSE
06B	2472		T3,15A GDA BUSSMANN 5X20MM FUSE
06B	2475		T3,15ALGDC BUSSMANN 5X20MM FUSE
06B	2469		T5A 5X20MM FUSE
06B	2479		F5A 5X20MM FUSE
06B	2483		F2.5A 5X20MM FUSE
06B	2463		T6,3A 5X20MM FUSE
06B	2464		F6,3A 5X20MM FUSE
06B	2404	N/A	F8A 5X20MM FUSE
06C	2445		CIRCUIT BREAKER ADAPTOR PLATE
06C	2420		_1.50 AMP CIRCUIT BREAKER PC MNT
06C	2429		_1.50 AMP CIRCUIT BREAKER



SEQ	PRODUCT CODE	REPLACEMENT PRODUCT	DESCRIPTION
---	-----	-----	-----
06C	2443		_1.95 AMP CIRCUIT BREAKER HOLD
06C	2434		_2.00 AMP CIRCUIT BREAKER
06C	2422	N/A	_3.00 AMP CIRCUIT BREAKER PC MNT
06C	2426		_3.00 AMP CIRCUIT BREAKER
06C	2416		_4.50 AMP CIRCUIT BREAKER SM.BODY
06C	2419	N/A SEE NO	_5.00 AMP CIRCUIT BREAKER PC MNT
06C	2412		_5.50 AMP CIRCUIT BREAKER PC MNT
06C	2417		_6.00 AMP CIRCUIT BREAKER .250 TAB
06C	2447		_6.50 AMP CIRCUIT BREAKER TT PC MNT
06C	2423		_7.00 AMP CIRCUIT BREAKER
06C	2459		_7.00 AMP CIRCUIT BREAKER
06C	2408		_8.00 AMP CIRCUIT BREAKER
06C	2432		_8.00 AMP CIRCUIT BREAKER
06C	2433		_8.00 AMP SWITCH BREAKER BLK
06C	2441		_8.00 AMP SWITCH BREAKER WHITE
06C	2457		_8.00 AMP CIRCUIT BREAKER
06C	3606		12.00 AMP CIRCUIT BREAKER
06C	2446	N/A SEENOT	13.00 AMP CIRCUIT BREAKER
06C	2448		15.00 AMP CIRCUIT BREAKER
06C	2458		20.00 AMP CIRCUIT BREAKER .250 TAB
06C	2444		25.00 AMP CIRCUIT BREAKER
06C	3395		THERMO/BRKR:N/CLOSED OPEN@82C
06C	3398		THRL.BRKR:OP@198F/CL@173F 36TX21
06C	3399		THERMO/BRKR:N/CLOSED OPEN@96C
06C	3409		THERMO SW N/CLOSED OP/184F CL/144F
06C	3422		THERMO/BRKR:N/CLOSED OPEN@60C
06D	3641		S.C BAYONET WIRE SOCKET TINNED
06D	3643		12V 15W SC BAYONET #93 BULB
06D	3644		12V 24W SC BAYONET #1156 BULB
06D	3647		12V 18W SC BAYONET #1141 BULB
06D	3651		12V 36W SC BAYONET #1195 BULB
06D	3652		24V 55/50W DUPLO-D #R2 P45T BULB

## Capacitor/Inductor Band Codes

### Axial Lead Ceramic Capacitor



Color	1st, 2nd Band	Multiplicien	Tolerance	Characteristic
Black	0	1	±20% (M)	NPO
Brown	1	10		Y5S
Red	2	100		Y5T
Orange	3	1K		N150
Yellow	4	10K		N220
Green	5			N330
Blue	6			N470
Violet	7			N750
Grey	8		±30% (N)	Y5R
White	9			SL (G.P)
Gold	-	0.1	± 5% (J)	Y5F
Silver	-	0.01	±10% (K)	Y5P

### Axial Lead Inductor



34 Foley Drive, Sodus, New York 14551-0067, Telephone (315) 483-9122 TWX 510-250-2331  
 23452 Peralta Drive, Suite C, Laguna Hills, CA 92653 (714) 855-4013 TWX 910-595-2652  
 For more information call direct or any one of our sales offices in more than 20 U.S. cities.

We  
set  
the

# PACE

Electronic Products

SEQ	PRODUCT CODE	REPLACEMENT PRODUCT	DESCRIPTION
---	-----	-----	-----
07A	5198		__4P7 100V 5%CAP T&R RAD CER.2"NPO
07A	5443		__4P7 50V 10%CAP T&R TUBULAR NPO
07A	5200		_10P 200V 5%CAP T&R RAD CER.2"NPO
07A	5400		_10P 100V 10%CAP T&R BEAD NPO
07A	5401		_10P 500V 5%CAP T&R RAD CER.2"NPO
07A	5402		_15P 100V 10%CAP T&R BEAD NPO
07A	5817		_15P 100V 2%CAP T&R RAD CER.2"NPO
07A	5404		_27P 100V 10%CAP T&R BEAD NPO
07A	5405		_27P 200V 5%CAP T&R RAD CER.2"NPO
07A	5192		_33P 1000V 5%CAP T&R RAD CER.2"NPO
07A	5406		_33P 50V 10%CAP BLK BEAD NPO
07A	5203		_47P 100V 2%CAP T&R RAD CER.2"NPO
07A	5408		_47P 100V 10%CAP T&R BEAD NPO
07A	5195	NA	100P 1000V 10%CAP T&R RAD MICA 8
07A	5199		100P 100V 2%CAP T&R RAD CER.2"NPO
07A	5410		100P 100V 10%CAP T&R BEAD NPO
07A	5196		150P 100V 2%CAP T&R RAD CER.2"NPO
07A	5411		150P 100V 10%CAP T&R BEAD NPO
07A	5415		180P 100V 2%CAP T&R RAD .2"
07A	5197		220P 100V 2%CAP T&R RAD CER.2"NPO
07A	5277		220P 200V 5%CAP T&R RAD CER.2"NPO
07A	5412		220P 100V 10%CAP T&R BEAD NPO
07A	5414		270P 50V 10%CAP T&R BEAD NPO
07A	5211		330P 100V 5%CAP T&R RAD CER.2"NPO
07A	5417		330P 50V 10%CAP T&R BEAD NPO
07A	5419		330P 500V 5%CAP BLK MICA
07A	5413		390P 50V 10%CAP T&R BEAD NPO
07A	5194		470P 1000V 10%CAP T&R RAD CER.2"Y5P
07A	5201		470P 100V 5%CAP T&R RAD CER.2"NPO
07A	5416		470P 50V 10%CAP T&R BEAD NPO
07A	5418		470P 250V 20% Y2 CAP DISC T&R
07A	5819		470P 160V 1%CAP T&R AXIAL FLM
07A	5420		680P 50V 10%CAP T&R BEAD NPO
07A	5815		680P 200V 5%CAP T&R RAD CER.2"NPO
07A	5816		680P 100V 5%CAP T&R RAD CER.2"NPO
07A	5206		__1N 400V 5%CAP T&R RAD .2"FLM
07A	5213		__1N 400V 5%CAP T&R RAD PRO.□2"FM
07A	5422		__1N 50V 10%CAP T&R BEAD NPO
07A	5524	SEE NOTE	__1N 250V 20%CAP BLK RAD 'Y2' AC
07A	5603		__1N0 50V 5%CAP T&R RAD CER.2"X7R
07A	5423		__1N2 50V 10%CAP T&R BEAD X7R
07A	5273		__1N5 200V 5%CAP T&R RAD CER.2"NPO
07A	5424		__1N5 50V 10%CAP T&R BEAD Y5P
07A	5606		__1N5 50V 5%CAP T&R RAD CER.2"X7R
07A	5425		__1N8 50V 10%CAP T&R BEAD X7R
07A	5208		__2N2 400V 5%CAP T&R RAD .2"FLM
07A	5274		__2N2 200V 5%CAP T&R RAD CER.2"NPO
07A	5426		__2N2 50V 10%CAP T&R BEAD Y5R
07A	5427		__2N2 500V 10%CAP T&R RAD CER.2"YB

SEQ	PRODUCT CODE	REPLACEMENT PRODUCT	DESCRIPTION
---	-----	-----	-----
07A	5605		__2N2 630V 2%CAP T&R POLY FLM
07A	5836		__2N2 100V 20%CAP RAD CER DISC BULK
07A	5275		__3N3 100V 5%CAP T&R RAD .2"FLM
07A	5276		__3N3 200V 5%CAP T&R RAD CER.2"NPO
07A	5428		__3N3 50V 10%CAP T&R BEAD Y5R
07A	5209		__4N7 250V 5%CAP T&R RAD .2"FLM
07A	5432		__4N7 50V 10%CAP T&R BEAD Y5R
07A	6451		__4N7 250V 20%CAP BLK 'Y' 10MM AC
07A	6458		__4N7 250V 20%CAP BLK 'Y' 15MM AC
07A	5271		__5N6 100V 5%CAP T&R RAD .2"FLM
07A	5433		__5N6 50V 10%CAP T&R BEAD X7R
07A	5272		__6N8 100V 5%CAP T&R RAD .2"FLM
07A	5376		__6N8 50V 5%CAP T&R BEAD X7R
07A	5204		_10N 100V 10%CAP T&R RAD .2"FLM
07A	5300		_10N 50V 10%CAP T&R BEAD X7R
07A	5523		_10N 250V 20%CAP BLK RAD 'Y2' AC
07A	5834		_10N 250V 20%CAP BLK RAD POLY FLM
07A	5301		_12N 50V 10%CAP T&R BEAD X7R
07A	5205		_15N 100V 10%CAP T&R RAD .2"FLM
07A	5235	NA	_15N 1200V 10%CAP BLK RAD FILM FOIL
07A	5302		_15N 50V 10%CAP T&R BEAD X7R
07A	5936		_15N 400V 10%CAP BLK RAD POLY FLM
07A	5207		_18N 100V 5%CAP T&R RAD .2"FLM
07A	5303		_18N 50V 10%CAP T&R BEAD X7R
07A	5210		_22N 100V 10%CAP T&R RAD .2"FLM
07A	5304		_22N 50V 10%CAP T&R BEAD X7R
07A	5840		_22N 400V 10%CAP BLK RAD POLY FLM
07A	6435		_22N 275V 20%CAP BLK 'X2' 15MM AC
07A	5215		_27N 100V 5%CAP T&R RAD .2"FLM
07A	5222		_33N 100V 10%CAP T&R RAD .2"FLM
07A	5306		_33N 50V 10%CAP T&R BEAD X7R
07A	5835		_33N 250DC 10%CAP BLK RAD POLYE FLM
07A	5223		_39N 100V 10%CAP T&R RAD .2"FLM
07A	5224		_47N 100V 10%CAP T&R RAD .2"FLM
07A	5232		_47N 600V 5%CAP BLK RAD FILM FOIL
07A	5308		_47N 50V 10%CAP T&R BEAD X7R
07A	5522		_47N 250V 20%CAP AC AXIAL X/SWITCH
07A	5841		_47N 250V 10%CAP RAD POLYFILM BULK
07A	5226		_68N 100V 5%CAP T&R RAD .2"FLM
07A	5310		_68N 50V 10%CAP T&R BEAD X7R
07A	5515		_68N 250V 10%CAP RAD POLYFILM BULK
07A	5227		_82N 100V 5%CAP T&R RAD .2"FLM
07A	5312		_82N 50V 10%CAP T&R BEAD X7R
07A	5511		_82N 400V 10%CAP BLK RAD POLY FLM
07A	5212		100N 63V 5%CAP T&R RAD .2"FLM
07A	5228		100N 100V 5%CAP T&R RAD .2"FLM
07A	5242		100N 250V 20%CAP BLK 'X2' 22MM AC
07A	5314		100N 50V 10%CAP T&R BEAD X7R
07A	5865		100N 250V 10%CAP BLK RAD POLY FLM

SEQ	PRODUCT CODE	REPLACEMENT PRODUCT	DESCRIPTION
---	-----	-----	-----
07A	5229		150N 63V 10%CAP T&R RAD .2"FLM
07A	5514		150N 400V 10%CAP RAD POLYFILM BULK
07A	5827		150N 250V 20%CAP BLK 'X2' 15MM AC
07A	5920		150N 100V 10%CAP RAD POLYFILM BULK
07A	5230		180N 63V 5%CAP T&R RAD .2"FLM
07A	5317		180N 50V 10%CAP T&R BEAD X7R
07A	5231		220N 63V 10%CAP T&R RAD .2"FLM
07A	5318		220N 50V 10%CAP T&R BEAD X7R
07A	5600		220N 100VDC 10%CAP BLKRAD POLYE FLM
07A	5882		220N 250VDC 10%CAP BLK RAD POLY FLM
07A	5233		330N 63V 5%CAP T&R RAD .2"FLM
07A	5320	SEE NOTE	330N 50V 10%CAP T&R BEAD X7R
07A	5602		330N 250VDC 10%CAPBLK RAD POLYE FLM
07A	5234		470N 63V 10%CAP T&R RAD .2"FLM
07A	5322		470N 50V 10%CAP T&R BEAD Z5U
07A	5510		470N 250V 10%CAP RAD POLYFILM BULK
07A	5512		470N 100V 10%CAP RAD POLYFILM BULK
07A	5940		470N 63V 20%CAP AC AXIAL X/SWITCH
07A	5938		560N 100VDC 10%CAP BLKRAD POLYE FLM
07A	5963		560N 160VAC 10%CAPBLK RAD POLYP FLM
07A	5240		680N 63V 10%CAP T&R RAD .2"FLM
07A	5266		680N 250V 20%CAP BLK 'X2' 30MM AC
07A	5800		680N 35V 10%CAP BLK AXIAL TNT
07A	5941		680N 100V 10%CAP BLK RAD POLY FLM
07A	5877		820N 100V 10%CAP BLK RAD POLY FLM
07A	5254		__1U 63V 20%CAP T&R 4X7MM .2"EL
07A	5255		__1U 63V 20%CAP T&R RAD .2"EL
07A	5256		__1U 63V 5%CAP T&R RAD .2"FLM
07A	5262		__1U 275V 20%CAP BLK 'X2' 26.0MM AC
07A	5518		__1U 35V 10%CAP T&R RAD .2"TNT
07A	5519		__1U 100DC10%CAP BLK RAD POLYE FLM
07A	5527		__1U 250V 5%CAP BLK RAD POLY FLM
07A	5604		__1U 400DC10%CAP BLK POLYE FLM
07A	5876		__1U 63V 20%CAP T&R AXIAL EL
07A	5965		__1U 140AC10%CAP BLK RAD POLYP FLM
07A	5801		__1U2 15V 10%CAP T&R AXIAL TNT
07A	5263		__1U5 500V 20%CAP BLK
07A	5925		__1U5 250DC10%CAP BLK RAD POLYE FLM
07A	5966		__1U5 150AC10%CAP BLK RAD POLYP FLM
07A	5257		__2U2 63V 20%CAP T&R RAD .2"EL
07A	5521		__2U2 250V CAP BLK RAD 'X2' AC
07A	5601		__2U2 250DC10%CAP BLK POLYE FLM
07A	5932		__2U2 100V 10%CAP BLK RAD POLY FLM
07A	5948	5257	__2U2 40V 20%CAP T&R AXIAL EL
07A	5962		__2U2 140AC10%CAP BLK RAD POLYP FLM
07A	5927		__3U3 20V 20%CAP T&R RAD TNT.2"LS
07A	5942		__3U3 100DC10%CAP BLK RAD POLYE FLM
07A	5949		__3U3 140AC10%CAP BLK RAD POLYP FLM
07A	5951		__3U3 250DC10%CAP BLK MPOLYP FLM

SEQ	PRODUCT CODE	REPLACEMENT PRODUCT	DESCRIPTION
07A	5258		__4U7 63V 20%CAP T&R 8X7MM .2"EL
07A	5861		__4U7 63V 10%CAP T&R AXIAL EL
07A	5933		__4U7 100DC10%CAP BLK RAD POLYE FLM
07A	5950		__4U7 250DC10%CAP BLK RAD POLYP FLM
07A	5259		__4U7 63V 20%CAP T&R RAD .2"EL
07A	5939	5964	__5U6 100DC10%CAP BLK RAD POLYE FLM
07A	5964		__5U6 250DC10%CAP BLK RAD POLYP FLM
07A	5931		__6U8 100DC10%CAP BLK RAD POLYE FLM
07A	5960		__6U8 140AC10%CAP BLK RAD POLYP FLM
07A	5281		_10U 16V 20%CAP T&R RAD .2"NP
07A	5282		_10U 16V 20%CAP T&R 5X7MM .2"NP
07A	5629		_10U 160V 20%CAP BLK 10X13MM EL
07A	5633		_10U 6V 20%CAP TANTALUM RAD BULK
07A	5806	5516	_10U 25V 20%CAP BLK TNT
07A	5852		_10U 35V 20%CAP T&R 05X05MM EL
07A	5929		_10U 140AC 10%CAP BLK RAD POLYP FLM
07A	5930		_10U 100DC 10%CAP BLK RAD POLYE FLM
07A	5945		_10U 63V 20%CAP T&R RAD .2"EL
07A	5959		_10U 450V 20%CAP BLK EL
07A	7753		_10U 6.3V 5%CAP 5X8.0 SMT ELC
07A	5849		_15U 240V 10%CAP BLK RAD POLYP FLM
07A	5867		_15U 160AC10%CAP BLK RAD POLYP FLM
07A	5944		_15U 100DC10%CAP BLK RAD POLYE FLM
07A	5260		_22U 50V 20%CAP T&R RAD .2"EL
07A	5631		_22U 50V 20%CAP T&R 6X7MM .2"EL
07A	5958		_22U 350V 20%CAP BLK 13X25 EL
07A	7707	7697?CHK W	_22U 16V 5%CAP SMT NP
07A	5961		_33U 16V 20%CAP T&R RAD .2"NP
07A	5627		_47U 10V 20%CAP BLK RAD NP
07A	7770		_47U 4V 20%CAP SMT 4.3X3.9 ELC
07A	5265		_68U 25V 20%CAP T&R RAD .2"EL
07A	5943		_68U 16V 20%CAP T&R AXIAL EL
07A	5902		_82U 450V 20%CAP BLK 22X30MM
07A	5853		_75U 140V 5%CAP BLK AXL POLY FLM
07A	5267		100U 25V 20%CAP T&R RAD .2"EL
07A	5872	5267	100U 25V 20%CAP BLK AXIAL EL
07A	5879		100U 16V 20%CAP T&R 8X7MM .2"EL
07A	5880		100U 35V 20%CAP BULK .1"EL
07A	5914		100U 63V 20%CAP BLK 10X13MM EL
07A	5620		150U 160V 20%CAP BLK AXIAL ELECTR
07A	5850		150U 25V 20%CAP BLK AXIAL EL
07A	5268		220U 35V 20%CAP T&R RAD .2"EL
07A	5610		220U 160V 20%CAP BLK 16X36MM EL
07A	5619		330U 100V 20%CAP BLK 12X25MM EL
07A	5625		330U 10V 20%CAP BLK RAD EL
07A	5630		330U 25V 20%CAP BLK 10X13MM EL
07A	5897		330U 16V 20%CAP BLK 08X11MM EL
07A	5623		330U 16V 20%CAP BLK AXIAL EL
07A	5621		470U 63V 20%CAP BLK 12X25MM EL

SEQ	PRODUCT CODE	REPLACEMENT PRODUCT	DESCRIPTION
---	-----	-----	-----
07A	5622		470U 16V 20%CAP BLK AXIAL EL
07A	5957		470U 350V 20%CAP BLK 30X50 EL
07A	5618		470U 25V 20%CAP BLK 10X15MM EL
07A	5626		1000U 10V 20%CAP BLK AXIAL EL
07A	5635		1000U 35V 20%CAP BLK RADIAL ELECT
07A	5848		1000U 25V 20%CAP BLK AXIAL EL
07A	5887		2200U 50V 20%CAP BLK 18X27MM EL
07A	5888		2200U 25V 20%CAP BLK 16X25MM EL
07A	5904		2200U 80V 20%CAP BLK 25X30MM ELS
07A	5858		2700U 180V 20%CAP RAD 35X63MM ELS
07A	5616		3300U 50V 20%CAP BLK 18X35MM EL
07A	5617		3300U 63V 20%CAP BLK 25X31MM ELS
07A	5860	SEE NOTES	3300U 35V 20%CAP BLK 18X25MM EL
07A	5884		3300U 160V 20%CAP RAD 35X50MM ELS
07A	5899		3300U 100V 20%CAP BLK 25X50MM ELS
07A	5894		3900U 80V 20%CAP BLK 30X40MM ELS
07A	5636		4700U 50V 20%CAP BLK 25X40MM EL
07A	5857		4700U 160V 20%CAP RAD 40X63MM ELS
07A	5859		4700U 50V 20%CAP BLK 25X36MM ELS
07A	5868		4700U 16V 10%CAP BLK 16X31MM ELS
07A	5869		4700U 63V 20%CAP BLK 25X40MM ELS
07A	5896		4700U 80V 20%CAP BLK 25X50MM ELS
07A	5890		5600U 100V 20%CAP RAD 35X50MM ELS
07A	5892		6800U 80V 10%CAP BLK 35X40MM ELS
07A	5895		6800U 63V 20%CAP BLK 25X50MM
07A	5898		8200U 50V 20%CAP 25X50MM ELS
07A	5900		10000U 63V 20%CAP BLK 35X45MM ELS
07A	5903		12000U 35V 20%CAP RAD 25X45MM ELS
07A	5599	N/A SEE NO	18000U 75V CAP REL

SEQ	PRODUCT CODE	REPLACEMENT PRODUCT	DESCRIPTION
---	-----	-----	-----
08A	3759		___4UH COIL 14AWG ZOBEL VERTICAL
08A	3820		___4UH COIL 14AWG ZOBEL HORIZONTAL
08A	3819		___5UH COIL 18AWG R000 AIR CORE
08A	3824		___5UH COIL 16AWG R000 AIR COR
08A	3899		__18UH MINI INDUCTOR HI-Q T&R
08A	3769		_100UH COIL 18AGW ZOBEL FER CORE
08A	3718		_130UH COIL 18AWG R096 IRN CORE
08A	3766		_130UH COIL 18AWG R000 BOBBIN
08A	3777		_130UH COIL 22AWG R000 BOBBIN
08A	3785		_150UH COIL 22AWG R000 BOBBIN
08A	3717		_220UH COIL 18AWG R098 IRN CORE
08A	3780		_220UH COIL 22AWG R000 BOBBIN
08A	3840		_220UH COIL 18AWG R000 BOBBIN
08A	3714		_200UH COIL 24AWG R286 FER-CORE
08A	3763		_280UH COIL 16AWG R000 AIR CORE
08A	3871		_238UH COIL 18AWG R??? IRN CORE
08A	3779		_300UH COIL 18AWG R249 BOBBIN
08A	3784		_300UH COIL 22AWG R000 BOBBIN
08A	6497		_304UH CHOKE 95T18AWG/77111MAGNTKS
08A	3715		_370UH COIL 19AWG R000 IRN CORE
08A	3720		_370UH COIL 18AWG R000 AIR COIL
08A	3805		_370UH COIL 22AWG R000 BOBBIN
08A	3757		_400UH COIL 14AWG R000 AIR CORE
08A	3771		_430UH COIL 22AWG R314 IRON CORE
08A	3781		_430UH COIL 22AWG R000 BOBBIN
08A	3813		_430UH COIL 18AWG R000 BOBBIN
08A	3756		_500UH COIL 14AWG R000 AIR CORE
08A	3761		_560UH COIL 16AWG R258 AIR CORE
08A	3772		_560UH COIL 18AWG R348 AIR CORE
08A	3775		_590UH COIL 18AWG R243 IRN CORE
08A	3873		_560UH COIL 18AWG R000 IRN CORE
08A	3880		_590UH COIL 22AWG R243 IRN CORE
08A	3758		_600UH COIL 14AWG R163 AIR CORE
08A	3773		_690UH COIL 16AWG R000 AIR CORE
08A	3901		_690UH COIL 20AWG R000 IRN CORE
08A	3708		_900UH COIL 16AWG R??? IRN CORE
08A	3711		_900UH COIL 22AWG R448 FER CORE
08A	3713		_900UH COIL 22AWG R400 IRN CORE
08A	3767		_900UH COIL 14AWG R000 AIR CORE
08A	3703		1000UH COIL 18AWG R000 AIR CORE
08A	3724		1000UH COIL 20AWG R361 IRN CORE
08A	3828		1000UH COIL 16AWG R000 AIR CORE
08A	3878		1000UH COIL 18AWG R000 IRNLCORE
08A	3006		1200UH COIL 18AWG R221 IRN CORE
08A	3877		1200UH COIL 18AWG R000 IRNLCORE
08A	3879		1200UH COIL 18AWG R132 IRN CORE
08A	3872		2000UH COIL 18AWG R??? IRN CORE
08A	3783		1300UH COIL 19AWG R000 BOBBIN
08A	3726		1500UH COIL 16AWG R156 IRN CORE



SEQ	PRODUCT CODE	REPLACEMENT PRODUCT	DESCRIPTION
---	-----	-----	-----
08A	3760		1500UH COIL 14AWG R290 AIR CORE
08A	3762		1500UH COIL 18AWG R643 AIR CORE
08A	3712		1600UH COIL 18AWG R225 IRN CORE
08A	3716		2000UH COIL 22AWG R561 IRN CORE
08A	3765		2000UH COIL 20AWG R000 IRN CORE
08A	3874		2600UH COIL 16AWG R??? IRN CORE
08A	3725		2360UH COIL 18AWG R207 IRN CORE
08A	3704		2560UH COIL 16AWG R000 AIR CORE
08A	3727		2600UH COIL 16AWG R225 IRN CORE
08A	2898		3000UH COIL 16AWG R??? IRN CORE
08A	3754		3000UH COIL 20AWG R000 AIR CORE
08A	3782	3783	1000UH COIL 18AWG R000 AIR CORE
08A	3876		4000UH COIL 16AWG R??? IRNL CORE
08A	3774		5400UH COIL 18AWG R000 AIR CORE
08A	3787		8000UH COIL 14AWG R000 AIR CORE
08A	3835		___5MH CHOKE HIGH CURRENT
08A	3755		__10MH COIL 20AWG R000 AIR CORE
08A	3832		__20MH CHOKE HIGH CURRENT
08A	3786		_233UH CHOKE 80T20AWG/77091MAGNTKS
08A	3792		_288UH CHOKE 89T20AWG/77091MAGNTKS
08A	3793		__20UH COIL 5AMP SNUBR
08A	3802		__22UH COIL 15AMP FILTER
08A	3812		__47UH COIL 15AMP INPUT
08A	3816		__50UH COIL 5AMP BOOST
08A	3817		_1.5MH COIL INPUT COM MODE
08A	3836		___ COIL SNUB RESONANT
08A	3847		_100UH COIL 5AMP POWER VERT MTG

SEQ	PRODUCT CODE	REPLACEMENT PRODUCT	DESCRIPTION
---	-----	-----	-----
09A	6425		BAV21 200V 0A25 DIODE T&R
09A	6821		STTA1206D 600V 12A DIODE ULTRAFAS
09A	6825		1N4148 75V 0A45 DIODE T&R
09A	6826		STTA806D 600V 8A DIODE ULTRAFAS
09A	6829		STTA812D 1200V 8A DIODE ULTRAFAS
09A	6830		1N5408 1000V 3A0 DIODE
09A	6831		FEP16JTD 600V 16A DIODE DUALFAST
09A	6835		FEP16BT 100V 16A DUALDIO CC FAS
09A	6888		HER508 1000V 3A0 DIODE ULTRAFAS
09A	6892		UF4004 200V 1A0 DIODE ULTRAFAS
09A	6896		UF5404 200V 3A0 DIODE ULTRAFAS
09A	6438		1N4007 400V 1A0 DIODE T&R
09A	6820		MR5059 200V 1A5 DIODE
09A	6819	6934	MR504 400V 3A0 DIODE GT6934
09A	6827		1N5402 200V 3A0 DIODE
09A	6934		MR854 400V 3A0 DIODE FASREC
09A	6430	6890	MR821 100V 5A0 DIODE
09A	6421		MR752 200V 6A0 DIODE
09A	6431		MR751 100V 6A0 DIODE
09A	6434		6A2 200V 6A0 DIODE
09A	6739		MR750 50V 6A0 DIODE
09A	6890		FE6BTR 100V 6A0 DIODE FASREC
09A	6733		BAT85 30V 0A2 DIODE SCHTKYT&R
09A	6735	SEE NOTES	MBR030 30V 0A5 DIODE SCHTKYT&R
09A	6455		IN5817 20V 1A0 DIODE SCHTKYT&R
09A	6471		MBR160 60V 1A0 DIODE SCHTKY
09A	6442		MBR320P 20V 3A0 DIODE SCHTKY
09A	6487		1N5822 40V 3A0 DIODE SCHTKY
09A	6479		MUR415 150V 4A0 DIODE FASREC
09A	5121		MZ4615RL 2V0 W25 ZENER 5% T&R
09A	6439		1N5225B 3V0 0W5 ZENER 5% T&R
09A	6440		1N750ARL 4V7 0W5 ZENER 5% T&R
09A	6459		1N4732A 4V7 1W0 ZENER 5% T&R
09A	6454		1N5231BRL 5V1 0W5 ZENER 5% T&R
09A	6436		1N753ARL 6V2 0W5 ZENER 5% T&R
09A	6488		1N5236BRL 7V5 0W5 ZENER 5% T&R
09A	6437		1N5237B 8V2 0W5 ZENER 5% T&R
09A	6461		1N5240BRL 10V0 0W5 ZENER 5% T&R
09A	6484		1N4740A 10V0 1W0 ZENER 5% T&R
09A	6450		1N5242B 12V0 0W5 ZENER 5% T&R
09A	6807		1N4742A 12V0 1W0 ZENER 5% T&R
09A	6486		1N5244B 14V0 0W5 ZENER 5% T&R
09A	6818		1N5245B 15V0 0W5 ZENER 5% T&R
09A	6822		1N4745A 16V0 1W0 ZENER 5% T&R
09A	6824		1N5246B 16V0 0W5 ZENER 5% T&R
09A	6432		1N5248B 18V0 0W5 ZENER 5% T&R
09A	6429		1N4747A 20V0 1W0 ZENER 5% T&R
09A	6465		1N5250B 20V0 0W5 ZENER 5% T&R
09A	6463		1N5251BRL 22V0 0W5 ZENER 5% T&R

SEQ	PRODUCT CODE	REPLACEMENT PRODUCT	DESCRIPTION
---	-----	-----	-----
09A	6875		1N5359B 24V0 5W0 ZENER 5% T&R
09A	6426		1N5254B 27V0 0W5 ZENER 5% T&R
09A	6466		1N5256B 30V0 0W5 ZENER 5% T&R
09A	6485		1N5256C 30V0 0W5 ZENER 2% T&R
09A	6433		1N5257B 33V0 0W5 ZENER 5% T&R
09A	6460		1N5260B 43V0 0W5 ZENER 5% T&R
09A	6475		1N5262B 51V0 0W5 ZENER 5% T&R
09B	3747		BLK SPACER LED CUSTOM 0.5
09B	6412		RD&YL 10SG LED BAR GRPH 31+7Y 42B
09B	6413		RED 10SG LED BAR GRPH
09C	6397		JEWELLED PILOT LAMP AMBER REG V1
09C	6554		BLUE 3MM LED 3V9 20MA
09C	5906		RED 3MM LED 1V9 20MA.4SPCER T&R
09C	5991		RED 3MM LED 1V9 20MA W/STOP T&R
09C	5993		RED 3MM LED 1V9 20MA.12SPCR T&R
09C	6398		RED 5MM LED 1V5 20MA HIGH EFF
09C	6399		YEL 5MM LED 1V5 20MA HIGH EFF
09C	6405		RED 3MM LED 1V7 5MA BRT
09C	6409	6405? SEE	RED 3MM LED 1V7 2MA LOW CUR
09C	6411		RED 3MM LED 1V9 5MA BRT
09C	6414	SEE NOTE	RD&YL 5MM LED DUAL SPRY5111
09C	6415		RED 5MM LED 1V7 20MA HYPER BRT
09C	6416		ORN 5MM LED 1V7 20MA ULTRA BRT
09C	5907		YEL 3MM LED 1V9 20MA.4SPCER T&R
09C	5994		YEL 3MM LED 1V9 20MA.12SPCR T&R
09C	6400		YEL 3MM LED 1V9 6MA HIGHEFF
09C	6407		YEL 3MM LED 1V8 5MA
09C	6418		YEL 5MM LED 2V1 20MA SPY5731
09C	5908		GRN 3MM LED 1V9 20MA.4SPCER T&R
09C	5990		GRN 3MM LED 1V7 20MA W/STOP T&R
09C	5995		GRN 3MM LED 1V9 20MA.12SPCR T&R
09C	6401		GRN 3MM LED 1V9 6MA HIGHEFF
09C	6408		GRN 3MM LED 1V9 5MA FROSTED

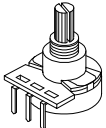

STYLE "P01"

4448	_1M	LN	1"	P01
4449	_20K	A AUD	1"	P01
4450	_50K	LN	1"	P01
4452	50K AUDIO			
4453	100K AUDIO			
4454	15K REV/AUD			
4455	3M AUDIO			
4456	_50K	R/A	1"	P01
4457	_10K	LN	1"	P01
4458	250K	LN	1"	P01
4468	_10K	R/A	1"	P01
4482	1 MEG AUDIO			
4483	250K LINEAR			
4485	1 MEG LINEAR			
4535	100K	LN	1"	P01

**KNURLED SHAFT 1" BODY HORIZONTAL MOUNT WITH COLLAR & THREADED BUSHING**



STYLE "P02"

4422	500K	A AUD	1"	P02
4530	_10K	R/A	1"	P02
4531	_10K	LN	1"	P02
4532	_10K	A AUD	1"	P02
4533	250K	A AUD	1"	P02
4536	100K	LN	1"	P02
4538	_50K	R/A	1"	P02
4539	_50K	A AUD	1"	P02
4540	_50K	LN	1"	P02
4542	_1M	LN	1"	P02
4543	_5K	LN	1"	P02
4544	100K	R/A	1"	P02

**KNURLED SHAFT 1" BODY VERTICAL MOUNT WITH COLLAR & THREADED BUSHING**

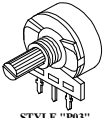

STYLE "P03"

4451	1 MEG AUDIO			
4469	50K AUDIO			
4471	1 MEG AUDIO			
4474	15K REV/AUD			
4491	_4M	R/A	1"	P03
4492	250K	R/A	1"	P03
4503	100K	LN	1"	P03
4504	_25K	A AUD	1"	P03
4505	500K	LN	1"	P03
4506	50K AUDIO			
4507	100K	LN	1"	P03
4511	500K AUD			

**KNURLED SHAFT 1" BODY VERTICAL MOUNT THREADED BUSHING**

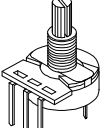

STYLE "P04"

4460	_50K	LN	1"	P04
4461	1 MEG AUDIO			
4463	100K AUDIO			
4464	15K REV/AUD			
4465	3M AUDIO			
4466	50K REV/AUD			
4470	50K LINEAR			
4471	1 MEG AUDIO			
4472	50K AUDIO			
4473	100K AUDIO			
4474	15K REV/AUD			
4475	3M AUDIO			
4486	500K LINEAR			
4493	4 MEG REV/AUD			

**KNURLED SHAFT 1" BODY HORIZONTAL MOUNT 4 LEGS THREADED BUSHING**



STYLE "P05"

4423	2X10K AUDIO			
4446	100K	R/A	1"	+100K P05

**KNURLED SHAFT 1" BODY VERTICAL MOUNT WITH COLLAR & THREADED BUSHING 2 GANG**



STYLE "P06"

4445	200K	R/A	1"	+2X2K P06
------	------	-----	----	-----------

**KNURLED SHAFT 1" BODY VERTICAL MOUNT WITH COLLAR & THREADED BUSHING 3 GANG**



STYLE "P07"

4413	_10K	10C R/A	16MM	P07
------	------	---------	------	-----

**KNURLED SHAFT BODY VERTICAL MOUNT THREADED BUSHING 16MM**



STYLE "P08"

4404	_10K	5B LN	16MM	-DPDT SWITCH P08
4407	_50K	20A AUD	16MM	-DPDT SWITCH P08

**KNURLED SHAFT BODY VERTICAL MOUNT THREADED BUSHING 16MM WITH SWITCH**



STYLE "P11"

4401	_50K	1B LN	16MM	P11
4402	_10K	3B LN	16MM	DETENT P11
4565	_10K	3B LINEAR	DETENT	

**SOLID VERTICAL D-SHAFT 30MM NO BUSHING 16MM PCB SNAP IN**

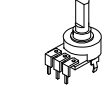

STYLE "P12"

4559	_20K	5C R/A	16MM	P12
4560	_2K	5C R/A	16MM	P12
4561	_10K	1B LN	16MM	P12
4563	_50K	1B LN	16MM	P12

**SOLID VERTICAL D-SHAFT 30MM WITH COLLAR & BUSHING 16MM PCB SNAP IN**



STYLE "P13"

4557	_2K	5C R/A	16MM	P13
4558	_10K	1B LN	16MM	P13

**SOLID VERTICAL SHAFT 30MM & THREADED BUSHING 16MM PCB SNAP IN**

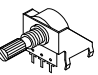

STYLE "P14"

4403	_10K	5B LN	16MM	P14
4405	_50K	20A AUD	16MM	P14
4406	_50K	5B LN	16MM	P14
4409	_10K	5C R/A	16MM	P14
4410	100K	10C R/A	16MM	P14
4411	_10K	10A AUD	16MM	P14

**HORIZONTAL KNURLED SHAFT 30MM THREADED BUSHING 16MM PCB SIDE SUPPORT SNAP IN**

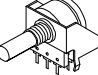

STYLE "P15"

4400	_10K	25A AUD	16MM	DETENT P15
------	------	---------	------	------------

**HORIZONTAL SOLID ROUND SHAFT 30MM THREADED BUSHING 16MM PCB SIDE SUPPORT SNAP IN**



STYLE "P16"

4414	250K	5B LN	18MM	CENTER TAP P16
------	------	-------	------	----------------

**VERTICAL SOLID D SHAFT 30MM BUSHING NOT THREADED 18MM PCB SNAP IN**

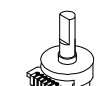

STYLE "P17"

4416	_50K	B LN	18MM	STEREO P17
4564	_20K	1B LN	18MM	STEREO P17

**VERTICAL SOLID D SHAFT 30MM STEREO BUSHING NOT THREADED 18MM PCB SNAP IN**



STYLE "P18"

4580	ROT	BIN	18MM	1BIT ENCODER P18
------	-----	-----	------	------------------

**VERTICAL SOLID D SHAFT 30MM THREADED BUSHING 16MM PCB SNAP IN**



STYLE "P19"

4394	_10K	A AUD	16MM	DETENT P19
------	------	-------	------	------------

**VERTICAL SOLID D SHAFT 30MM THREADED BUSHING 16MM SUPPORTING PIN**



STYLE "P20"

4391	_20K	5C R/A	9MM	P20
4392	_10K	B LN	9MM	P20
4393	_50K	B LN	9MM	P20

**VERTICAL SOLID PLASTIC D SHAFT 30MM, NO BUSHING 9MM PCB SNAP IN**



STYLE "P21"

4385	100K	5C R/A	12MM	STEREO P21
4545	_50K	LN	12MM	STEREO DETENT P21
4562	_10K	LN	12MM	STEREO DETENT P21
4569	_10K	LN	12MM	STEREO P21
4570	_20K	5C R/A	12MM	STEREO P21
4571	_50K	LN	12MM	STEREO P21

**VERTICAL SOLID PLASTIC D SHAFT 27MM, BUSHING 12MM PCB SNAP IN**



STYLE "P22"

4395	_2K	5C R/A	16MM	P22
4390	_10K	A AUD	16MM	DETENT P22

**VERTICAL SOLID D SHAFT DETENT 30MM THREADED BUSHING 16MM SUPPORTING PIN**

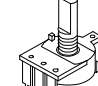

STYLE "P23"

4581	ROT	GRY	18MM	4BIT ENCODER P23
------	-----	-----	------	------------------

**VERTICAL SOLID D SHAFT 30MM STEREO THREADED BUSHING 18MM PCB SNAP IN**



STYLE "P24"

4389	_20K	1B LN	16MM	4532B STEREO P24
------	------	-------	------	------------------

**HORIZONTAL KNURLED SHAFT 30MM STEREO WITH COLLAR AND THREADED BUSHING 16MM**

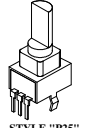

STYLE "P25"

4384	_5K	B LN	9MM	P25
4502	_2K	5C R/A	9MM	P25
4537	_10K	B LN	9MM	DETENT P25
4546	_50K	B LN	9MM	DETENT P25
4566	_10K	B LN	9MM	P25
4567	_20K	5C R/A	9MM	P25
4568	_50K	B LN	9MM	P25

**VERTICAL SOLID PLASTIC D SHAFT 27MM BUSHING 9MM PCB SNAP IN**

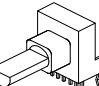

STYLE "P26"

4518	_10K	LN	12MM	STEREO DETENT P26
------	------	----	------	-------------------

**HORIZONTAL SOLID PLASTIC D SHAFT 20MM BUSHING 12MM PCB SNAP IN STEREO**



STYLE "P27"

4419	100K	B LN	12MM	STEREO P27
------	------	------	------	------------

**HORIZONTAL SOLID PLASTIC D SHAFT 15MM METAL BUSHING WITH THREADS 12MM PCB SNAP IN STEREO**



STYLE "P28"

4417	_10K	5B LN	9MM	HORIZONTAL P28
4418	_10K	5C R/A	9MM	HORIZONTAL P28
4420	_50K	B LN	9MM	HORIZONTAL P28

**HORIZONTAL SOLID PLASTIC D SHAFT 15MM BUSHING 9MM PCB SNAP IN**

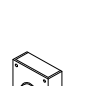

STYLE "P29"

4497	_10K	B LN	9MM	HORIZONTAL P29
------	------	------	-----	----------------

**HORIZONTAL SOLID PLASTIC KNURLED SHAFT 2L NO BUSHING 9MM PCB SNAP IN**



STYLE "P30"

4388	100K	B LN	9MM	DETENT KNURLED P30
------	------	------	-----	--------------------

**VERTICAL SOLID PLASTIC KNURLED SHAFT 20MM 9MM BODY PCB SNAP IN**



STYLE "P31"

4385	100K	5C R/A	12MM	STEREO P21
4545	_50K	LN	12MM	STEREO DETENT P21
4562	_10K	LN	12MM	STEREO DETENT P21
4569	_10K	LN	12MM	STEREO P21
4570	_20K	5C R/A	12MM	STEREO P21
4571	_50K	LN	12MM	STEREO P21



SERVICE PARTS CATALOGUE

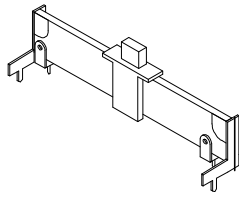

**3996**

*20K SLD MON WHT KB V 30M DT*

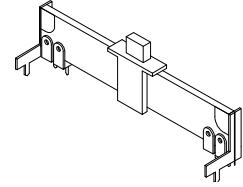

**3997**

*20K SLD BLK KB V 30M DT STER*

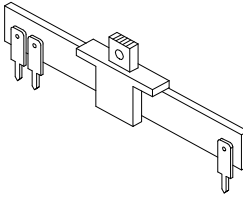

**3999**

*20K 1B 30MM OPEN VERT SLIDE POT*

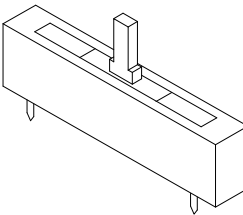

**4510**

*25K SLD LIN NIB SFT V 30M SNAP IN*

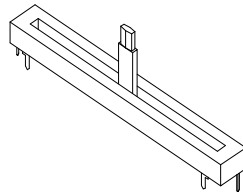

**4574**

*10K SLD 1B S V 60M WHT SFT*

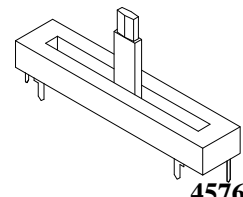

**4576**

*20K SLD 1B V 30M DT MONO*

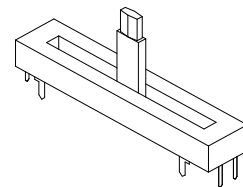

**4575**

*20K SLD V 30M DT STER*

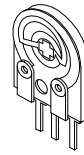

**4524**

*4K7 TRIM POT VERTICAL*

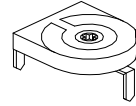

**4525**

*--1K TRIM POT*

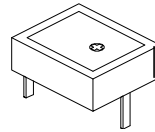

**4529**

*470R TRIM POT*

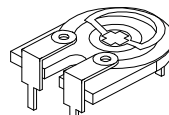

**4541**

*100R TRIM POT ENCLOSED HORIZONTAL*



**4520**

*10K TRIM POT (ENCLOSED)*

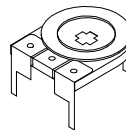

**largexx**

*standard large horizontal*



**enclose**

*small horizontal enclosed*

SEQ	PRODUCT CODE	REPLACEMENT PRODUCT	DESCRIPTION
---	-----	-----	-----
10A	4395		_2K 5C R/A 16MM P22
10A	4557		_2K 5C R/A 16MM P13
10A	4560		_2K 5C R/A 16MM P12
10A	4384		_5K B LIN 9MM P25
10A	4543		_5K LIN 1" P02
10A	4382	4418?SEE N	_10K 5C R/A 9MM P25
10A	4390		_10K AUD 16MM DETENT P22
10A	4392		_10K B LIN 9MM P20
10A	4394		_10K AUD 16MM DETENT P19
10A	4400	SEE SERVIC	_10K 25A AUD 16MM DETENT P15
10A	4403		_10K 5B LIN 16MM P14
10A	4404		_10K 5B LIN 16MM +DPDT SWITCH P08
10A	4409		_10K 5C R/A 16MM P14
10A	4411		_10K 10A AUD 16MM P14
10A	4412		_20K 15C R/A 9MM P32
10A	4417		_10K 5B LIN 9MM HORIZONTAL P28
10A	4418		_10K 5C R/A 9MM HORIZONTAL P28
10A	4428		_10K 3B LIN 9MM DETENT P32
10A	4431		_10K 5C R/A 12MM STEREO P34
10A	4432		_10K B LIN 9MM P32
10A	4434		_10K B LIN 9MM DETENT P32
10A	4436		_10K B LIN 12MM STEREO P34
10A	4438		_10K B LIN 12MM STEREO DETENTP34
10A	4457	N/A	_10K LIN 1" P01
10A	4467		_10K B LIN 12MM KNRLSHFT P36
10A	4468	4530	_10K R/A 1" P01
10A	4472		_10K B LIN 9MM P35
10A	4473		_10K 5C R/A 9MM P35
10A	4497		_10K B LIN 9MM HORIZONTAL P29
10A	4518		_10K LIN 12MM HORIZONTAL STP26
10A	4537		_10K B LIN 9MM DETENT P25
10A	4558		_10K 1B LIN 16MM P13
10A	4561	4402	_10K 1B LIN 16MM P11
10A	4562		_10K LIN 12MM STEREO DETENTP21
10A	4566		_10K B LIN 9MM P25
10A	4569		_10K LIN 12MM STEREO P21
10A	4389		_20K 1B LIN 16MM E432B STEREO P24
10A	4391		_20K 5C R/A 9MM P20
10A	4423		_20K 15AAUDIO 9MM P32
10A	4426		_20K 4B LIN 9MM P32
10A	4440		_20K B LIN 12MM STEREO DETENTP34
10A	4447		_20K 15A AUD 12MM STEREO P34
10A	4449		_20K AUD 1" P01
10A	4470		_20K 5C R/A 9MM P35
10A	4564		_20K 1B LIN 18MM STEREO P17
10A	4567		_20K 5C R/A 9MM P25
10A	4570		_20K 5C R/A 12MM STEREO P21
10A	4393		_50K B LIN 9MM P20
10A	4405		_50K 20A AUD 16MM P14

SEQ	PRODUCT CODE	REPLACEMENT PRODUCT	DESCRIPTION
---	-----	-----	-----
10A	4406		_50K 5B LIN 16MM P14
10A	4407		_50K 20A AUD 16MM +DPDT SWITCH P08
10A	4416		_50K B LIN 18MM STEREO P17
10A	4420		_50K B LIN 9MM HORIZONTAL P28
10A	4433		_50K B LIN 9MM P32
10A	4435		_50K B LIN 9MM DETENT P32
10A	4437		_50K B LIN 12MM STEREO P34
10A	4439		_50K B LIN 12MM STEREO DETENTP34
10A	4441		_50K 4B LIN 12MM STEREO P34
10A	4456	N/A	_50K R/A 1" P01
10A	4471		_50K B LIN 9MM P35
10A	4539	N/A, OLD P	_50K AUD 1" P02
10A	4545		_50K LIN 12MM STEREO DETENTP21
10A	4546		_50K B LIN 9MM DETENT P25
10A	4568		_50K B LIN 9MM P25
10A	4571		_50K LIN 12MM STEREO P21
10A	4385		100K 5C R/A 12MM STEREO P21
10A	4388		100K B LIN 9MM DETENT KNURL P30
10A	4410		100K 10C R/A 16MM P14
10A	4419		100K B LIN 12MM HORIZONTAL STP27
10A	4424		100K 1B LIN 9MM P32
10A	4430		100K 4B LIN 12MM STEREO P34
10A	4443		100K 5C R/A 9MM P32
10A	4446	N/A NO SUB	100K R/A 1" +100K P05
10A	4469		100K B LIN 9MM P35
10A	4474		100K B LIN 12MM KNRLSHFT P36
10A	4475		100K 5C R/A 12MM KNRL ST P37
10A	4507		100K LIN 1" P03
10A	4535	N/A	100K LIN 1" P02
10A	4544	N/A	100K R/A 1" P02
10A	4445	N/A	200K R/A 1" +2X2K P06
10A	4414		250K 5B LIN 18MM CENTER TAP P16
10A	4533	N/A	250K AUD 1" P02
10A	4422		500K AUD 1" P02
10A	4425		500K 15AAUDIO 9MM P32
10A	4491		_4M R/A 1" P03
10A	4487		_10K 10A AUD 60MM STEREO S01
10A	4489		_10K B LIN 60MM S01
10A	4495	4496	_10K LIN 30MM S10
10A	4496	N/A	_10K LIN 30MM S10
10A	4534		_10K B LIN 60MM STEREO S02
10A	4574		_10K 1B LIN 60MM S15
10A	3994		_20K 1B LIN 30MM TALL SHAFT S09
10A	3995		_20K 1B LIN 30MM STEREO DETENTS13
10A	3996		_20K LIN 30MM DETENT S12
10A	3998		_20K 1B LIN 20MM DETENT S04
10A	3999		_20K 1B LIN 30MM OPN S06
10A	4514		_20K 15A AUD 100M CHASSIS MOUNTS03
10A	4488		_50K B LIN 60MM S01

SEQ	PRODUCT CODE	REPLACEMENT PRODUCT	DESCRIPTION
---	-----	-----	-----
10A	4582		_50K LIN 60MM S15
10B	4520		_10K TRIM POT
10B	4521		_47K TRIM POT
10B	4522		__4K7 TRIM POT
10B	4525		__1K TRIM POT
10B	4528		__2K2 TRIM POT
10B	4529		470R TRIM POT
10B	4541		100R TRIM POT
10B	4524		__4K7 TRIM POT V
10C	4527		ROT GRY 20MM 4BIT ENCODER P31
10C	4580		ROT BIN 18MM 1BIT ENCODER P18
10C	4581		ROT GRY 18MM 4BIT ENCODER P23
10C	4583		ROT GRY 18MM 5BIT ENCODER P33
10C	4592	*SEE NOTE*	ROT GRY 18MM 3BIT ENCODER P23
10D	4476		L-PAD 8R 50WATT



## 4 Band Code

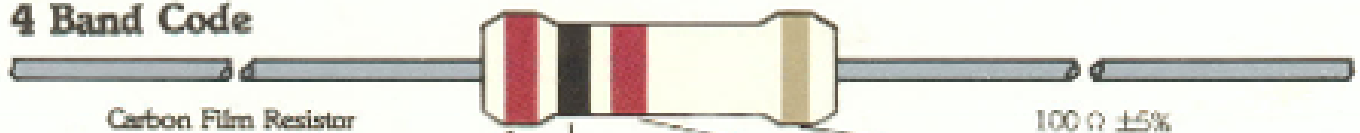

Color	1st Band	2nd Band	3rd Band	Multiplier	Tolerance
Black	0	0	0	1	
Brown	1	1	1	10	$\pm$ 1% (F)
Red	2	2	2	100	$\pm$ 2% (G)
Orange	3	3	3	1K	
Yellow	4	4	4	10K	
Green	5	5	5	100K	$\pm$ 0.5% (D)
Blue	6	6	6	1M	$\pm$ 0.25% (C)
Violet	7	7	7	10M	$\pm$ 0.10% (B)
Grey	8	8	8		$\pm$ 0.05%
White	9	9	9		
Gold				0.1	$\pm$ 5% (J)
Silver				0.01	$\pm$ 10% (K)

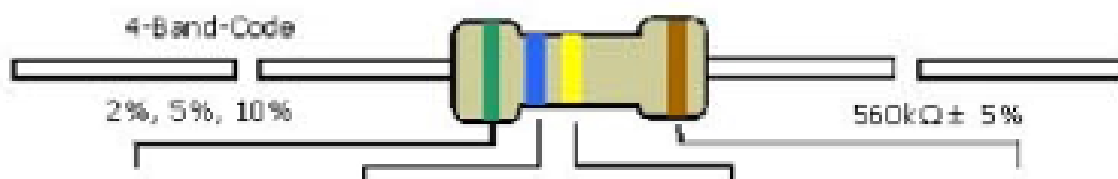
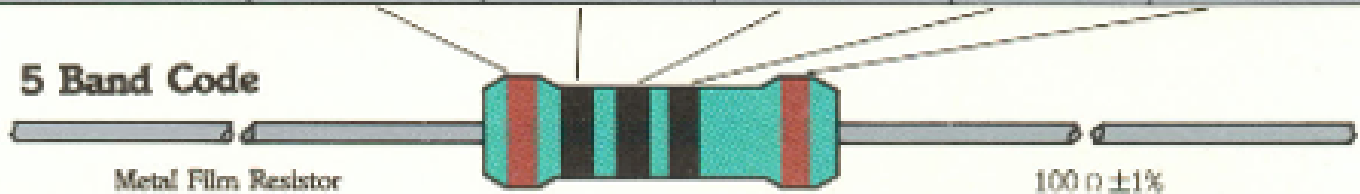

COLOR	1st BAND	2nd BAND	3rd BAND	MULTIPLIER	TOLERANCE
Black	0	0	0	1 $\Omega$	
Brown	1	1	1	10 $\Omega$	$\pm$ 1% (F)
Red	2	2	2	100 $\Omega$	$\pm$ 2% (G)
Orange	3	3	3	1K $\Omega$	
Yellow	4	4	4	10K $\Omega$	
Green	5	5	5	100K $\Omega$	$\pm$ 0.5% (D)
Blue	6	6	6	1M $\Omega$	$\pm$ 0.25% (C)
Violet	7	7	7	10M $\Omega$	$\pm$ 0.10% (B)
Grey	8	8	8		$\pm$ 0.05%
White	9	9	9		
Gold				0.1	$\pm$ 5% (J)
Silver				0.01	$\pm$ 10% (K)



SEQ	PRODUCT CODE	REPLACEMENT PRODUCT	DESCRIPTION
11A	4401	SEE NOTES	_50K 1B LIN 16MM P11
11A	3818		EMI SUPPRESSION FERRITE BEAD T&R
11A	4597		22AWG STRAN TC WIR JMP
11A	4599		22AWG SOLID SC WIR T&R JMP
11A	5298		22AWG SOLID SC WIR RAD JMP
11A	5299		24AWG SOLID SC WIR RAD JMP
11B	5039	N/A	_5.W R020 1% BLK RES
11B	4660		5.0W 0R047 5% BLK RES
11B	4959		5.0W 0R068 1% BLK RES
11B	4745		5.0W 0R1 5% BLK RES
11B	4749		5.0W 0R15 5% BLK RES
11B	4719		5.0W 0R18 5% BLK RES
11B	4715		5.0W 0R20 5% BLK RES
11B	5040		_20W 0R2 5% BLK RES
11B	4698		2.0W 0R27 10% T&R RES
11B	4729		5.0W 0R27 5% BLK RES
11B	4730		10.W 0R27 10% BLK RES
11B	4786		1.0W 0R51 5% T&R RES
11B	4677		1/2W 1R 5% T&R RES
11B	4682		1/2W 1R 5%PHILIPS SMAL T&R RES
11B	4694		5.0W 1R8 5% BLK RES
11B	4712		18.W 1R8 10% BLK RES
11B	4723		10.W 1R8 5% BLK RES
11B	4703		2.0W 2R 5% T&R RES
11B	4727		10.W 2R 5% BLK RES
11B	4688		1/2W 2R2 5% T&R RES
11B	4911		1/4W 2R2 5% T&R RES
11B	4642		1/2W 2R7 5% T&R RES
11B	4649		2.0W 2R7 5%10MM BODY T&R RES
11B	4687		10.W 2R7 5% BLK RES
11B	4905		1/4W 2R7 5% T&R RES
11B	4669		5.0W 3R3 5% BLK RES
11B	4918		1/4W 3R3 5% T&R RES
11B	4711		15.W 3R9 10% BLK RES
11B	4734		5.0W 3R9 5% BLK RES
11B	4741		10.W 3R9 5% BLK RES
11B	4748		2.0W 3R9 5% T&R
11B	4666		1/2W 4R7 5% T&R RES
11B	4866		1/4W 4R7 5% T&R RES
11B	4915		15.W 5R 10% BLK RES
11B	4684		10.W 5R6 5% BLK RES
11B	4733		5.0W 5R6 5% BLK RES
11B	4813		1/4W 6R2 5% T&R RES
11B	4651		1/2W 7R5 5% T&R RES
11B	4700		10.W 8R2 5% BLK RES
11B	4781		30.W 8R 10% BLK RES
11B	5012		15.W 8R2 5% BLK RES
11B	4605		1/8W 10R 5% T&R RES
11B	4675		1/2W 10R 5% T&R RES

11 Resistors Jumpers etc.

SEQ	PRODUCT CODE	REPLACEMENT PRODUCT	DESCRIPTION
11B	4739		10. w 10R 5% BLK RES
11B	4750		5.0w 10R 5% BLK RES
11B	4875		1/4w 10R 5% T&R RES
11B	4916		15. w 10R 10% BLK RES
11B	4930		1/4w 10R 5% .2"U T&R RES
11B	5035		_20w 10R 10% (LONG-LEADS) BLK RES
11B	4672		5.0w 12R 5% BLK RES
11B	4702		10. w 12R 5% BLK RES
11B	4815		1/4w 12R 5% T&R RES
11B	4896		1/4w 15R 5% T&R RES
11B	4612		1/2w 18R 5% T&R RES
11B	4785		40. w 18R 10% BLK RES
11B	4812		1/4w 18R 5% T&R RES
11B	4603		1/8w 22R 5% T&R RES
11B	4618		1/2w 22R 5% T&R RES
11B	4706		10. w 22R 5% BLK RES
11B	4709		5.0w 22R 5% BLK RES
11B	4818		1/4w 22R 5% T&R RES
11B	4858		25. w 22R 10% BLK RES
11B	5013		15. w 22R 5% BLK RES
11B	4710	CHECK INC	25. w 25R 10% BLK RES
11B	4740		10. w 27R 5% BLK RES
11B	4782		40. w 27R 10% BLK RES
11B	4882		1/4w 27R 5% T&R RES
11B	2040		1/4w 33R FUSIBLE T&R RES
11B	4616	CHECK INC	1/2w 33R 5% T&R RES
11B	4783		40. w 33R 10% BLK RES
11B	4816		1/4w 33R 5% T&R RES
11B	5023		15. w 33R 5% BLK RES
11B	4604		1/4w 33R2 1% T&R RES
11B	4704		5.0w 33R 5% BLK RES
11B	4899		1/4w 39R 5% T&R RES
11B	4759		30. w 44R 10% BLK RES
11B	4600		1/8w 47R 5% T&R RES
11B	4613		1.0w 47R 5% T&R RES
11B	4817		1/4w 47R 5% T&R RES
11B	4957		1/4w 47R 5% .2"U T&R RES
11B	6134		1/4w 47R 5%MINI T&R RES
11B	4637		1/8w 68R 5% T&R RES
11B	4811		1/4w 68R 5% T&R RES
11B	4912		1/4w 75R 5% T&R RES
11B	4658		1/2w 82R 5% T&R RES
11B	4602		1/8w 100R 5% T&R RES
11B	4652		1/2w 100R 5% T&R RES
11B	4692		5.0w 100R 5% BLK RES
11B	4735		1.0w 100R 5% T&R RES
11B	4852		1/4w 100R 5% T&R RES
11B	4921		1/4w 100R 5% .2"U T&R RES
11B	4732	SEE INC. S	5.0w 120R 5% BLK RES

11 Resistors Jumpers etc.

SEQ	PRODUCT CODE	REPLACEMENT PRODUCT	DESCRIPTION		
11B	4897		1/4w 120R	5%	T&R RES
11B	4987		1/4w 120R	5%MINI	T&R RES
11B	4659		1/2w 150R	5%	T&R RES
11B	4765	CHECK INC	2.0w 150R	5%	BLK RES
11B	4859		1/4w 150R	5%	T&R RES
11B	4984		1/4w 150R	5%MINI	T&R RES
11B	4752		1/4w 158R	1%	T&R RES
11B	4696	N/A	10.w 180R	5%	BLK RES
11B	4724		5.0w 180R	5%	BLK RES
11B	4819		1/4w 180R	5%	T&R RES
11B	6103		1/4w 196R	1%MINI MF	T&R RES
11B	4795		7.0w 200R	5%	BLK RES
11B	4909		1/4w 200R	5%	T&R RES
11B	4932		1/4w 200R	5% .2"U	T&R RES
11B	4657	2022 CLOSE	1/2w 220R	5%	T&R RES
11B	4857		1/4w 220R	5%	T&R RES
11B	4944		1/4w 220R	5% .2"U	T&R RES
11B	4958		2.0w 220R	10%	T&R RES
11B	4977		1/4w 220R	5%MINI	T&R RES
11B	6152		1/4w 221R	1%MINI MF	T&R RES
11B	4884		1/4w 240R	5%	T&R RES
11B	4770		1/4w 249R	1%	T&R RES
11B	4667		1/2w 270R	5%	T&R RES
11B	4867		1/4w 270R	5%	T&R RES
11B	4945		1/4w 270R	5% .2"U	T&R RES
11B	4986		1/4w 270R	5%MINI	T&R RES
11B	4757		10.w 300R	5%	BLK RES
11B	4798		1/4w 300R	5%	T&R RES
11B	6150		1/4w 301R	1%MINI MF	T&R RES
11B	4789		1/4w 324R0	0.1% ***	T&R RES
11B	4655		1/2w 330R	5%	T&R RES
11B	4855		1/4w 330R	5%	T&R RES
11B	5010		1/4w 330RX9	5% 10PIN	SIP RES
11B	5033		3.0w 330R	5%	T&R
11B	4881		1/4w 360R	5%	T&R RES
11B	4736		5.0w 390R	5%	BLK RES
11B	4872		1/4w 390R	5%	T&R RES
11B	4950		1/4w 390R	5% .2"U	T&R RES
11B	6153		1/4w 392R	1%MINI MF	T&R RES
11B	4690		1/2w 442R	1%	T&R RES
11B	4621		1/2w 470R	5%	T&R RES
11B	4689		2.0w 470R	5%	BLK RES
11B	4713		1.0w 470R	5%	T&R RES
11B	4821		1/4w 470R	5%	T&R RES
11B	4933		1/4w 470R	5% .2"U	T&R RES
11B	4980		1/4w 470R	5%MINI	T&R RES
11B	5029		1/4w 499R	1%	T&R RES
11B	5015		1/4w 475R0	0.1% ***	T&R RES
11B	4670		1/2w 510R	5%	T&R RES

11 Resistors Jumpers etc.

SEQ	PRODUCT CODE	REPLACEMENT PRODUCT	DESCRIPTION		
---	-----	-----	-----		
11B	4691		1/4W 510R	5%	T&R RES
11B	4671		1/2W 560R	5%	T&R RES
11B	4871		1/4W 560R	5%	T&R RES
11B	4799		1/4W 562R	1%	T&R RES
11B	5014		1/4W 562R0	0.1% ***	T&R RES
11B	4994		1/4W 590R	1%	T&R RES
11B	6151		1/4W 619R	1%MINI MF	T&R RES
11B	4891		1/4W 620R	5%	T&R RES
11B	4922		1/4W 620R	5% .2"U	T&R RES
11B	5019		1/4W 620R	5%MINI	T&R RES
11B	4673		1/2W 680R	5%	T&R RES
11B	4743		1/4W 681R0	0.1% ***	T&R RES
11B	4873		1/4W 680R	5%	T&R RES
11B	4923		1/4W 680R	5% .2"U	T&R RES
11B	4680		7.0W 750R	5% STANDOFF	BLK RES
11B	4716		5.0W 750R	5%	BLK RES
11B	4869		1/4W 750R	5%	T&R RES
11B	4924		1/4W 750R	5% .2"U	T&R RES
11B	4822		1/4W 820R	5%	T&R RES
11B	4925		1/4W 820R	5% .2"U	T&R RES
11B	4742		10.w 910R	5%	BLK RES
11B	4892		1/4W 910R	5%	T&R RES
11B	5017		2.0W 910R	5%	T&R RES
11B	4758		1/4W 953R	1%	T&R RES
11B	4726		5.0W 1K	5%	BLK RES
11B	4823		1/4W 1K	5%	T&R RES
11B	4913		1.0W 1K	5%	T&R RES
11B	4934		1/4W 1K	5% .2"U	T&R RES
11B	4981		1/4W 1K	5%MINI	T&R RES
11B	6110		1/4W 1K0	1%MINI MF	T&R RES
11B	4996		1/4W 1K070	0.1% ***	T&R RES
11B	4585		1/4W 1K2	5%MINI	T&R RES
11B	4654		1/2W 1K2	5%	T&R RES
11B	4701	CHECK INC	10.w 1K2	5%	BLK RES
11B	4854		1/4W 1K2	5%	T&R RES
11B	4998		5.0W 1K2	5%	BLK RES
11B	5037		5.0W 1K2	5% STANDOFF	BLK RES
11B	4802		1/4W 1K21	1%	T&R RES
11B	6111		1/4W 1K21	1%MINI MF	T&R RES
11B	4889		1/4W 1K3	5%	T&R RES
11B	4769		1/4W 1K4	1%	T&R RES
11B	4624		1/2W 1K5	5%	T&R RES
11B	4718		5.0W 1K5	5%	BLK RES
11B	4824		1/4W 1K5	5%	T&R RES
11B	4935		1/4W 1K5	5% .2"U	T&R RES
11B	4988		1/4W 1K5	5%MINI	T&R RES
11B	4791		1/4W 1K54	1%	T&T RES
11B	4614		1/2W 1K6	5%	T&R RES
11B	4993		1/4W 1K87	1%	T&R RES

11 Resistors Jumpers etc.

SEQ	PRODUCT CODE	REPLACEMENT PRODUCT	DESCRIPTION
11B	4625		1/2W 1K8 5% T&R RES
11B	4683		1.0W 1K8 5% T&R RES
11B	4738		5.0W 1K8 5% BLK RES
11B	4825		1/4W 1K8 5% T&R RES
11B	4975		3.0W 1K8 5% T&R RES
11B	5005		2.0W 1K8 5% T&R RES
11B	6105		1/4W 1K8 5%MINI T&R RES
11B	6144		1/4W 1K91 1%MINI T&R RES
11B	4631		1/2W 2K 5% T&R RES
11B	4808		1/4W 2K 5% T&R RES
11B	4946		1/4W 2K 5% .2"U T&R RES
11B	6113		1/4W 2K 5%MINI T&R RES
11B	4919		1/4W 2K05 1%-NO SUBS- T&R RES
11B	6148		1/4W 2K05 1%MINI MF T&R RES
11B	4647		1/2W 2K2 5% T&R RES
11B	4693		5.0W 2K2 5% BLK RES
11B	4705		2.0W 2K2 5% BLK RES
11B	4847		1/4W 2K2 5% T&R RES
11B	6104		1/4W 2K2 5%MINI T&R RES
11B	4714		1/4W 2K21 1% T&R RES
11B	4587		1/4W 2K32 1% T&R RES
11B	4883		1/4W 2K49 1% T&R RES
11B	6114		1/4W 2K49 1%MINI MF T&R RES
11B	4588		1/4W 2K43 1% T&R RES
11B	4664		1/2W 2K7 5% T&R RES
11B	4731		5.0W 2K7 5% BLK RES
11B	4864		1/4W 2K7 5% T&R RES
11B	4936		1/4W 2K7 5% .2"U T&R RES
11B	5006		1.0W 2K7 5% T&R RES
11B	4764		1/4W 2K740 0.1% *** T&R RES
11B	4805		1/4W 2K87 1% T&R RES
11B	4635		1/2W 3K 5% T&R RES
11B	4804		1/4W 3K 5% T&R RES
11B	6124		1/4W 3K 5%MINI T&R RES
11B	6156		1/4W 3K01 1%MINI MF T&R RES
11B	6206		1/4W 3K01 1% T&R RES
11B	4788		1/4W 3K160 0.1% *** T&R RES
11B	4992		1/4W 3K16 1% T&R RES
11B	4626		1/2W 3K3 5% T&R RES
11B	4826		1/4W 3K3 5% T&R RES
11B	4938		1/4W 3K3 5% .2"U T&R RES
11B	6136		1/4W 3K3 5%MINI T&R RES
11B	6205		1/4W 3K40 1% T&R RES
11B	5022		1/4W 3K57 1% T&R RES
11B	4596		1/2W 3K6 5%PHILIPS SMAL T&R RES
11B	4744		5.0W 3K6 5% BLK RES
11B	4814		1/4W 3K6 5% T&R RES
11B	5032		5.0W 3K6 5% STANDOFF BLK RES
11B	5028		1/4W 3K74 1% T&R RES

SEQ	PRODUCT CODE	REPLACEMENT PRODUCT	DESCRIPTION
11B	4650	CHECK INC	1/2W 3K9 5% T&R RES
11B	4850		1/4W 3K9 5% T&R RES
11B	5030		1.0W 3K9 2% T&R
11B	4756		1/4W 4K120 0.1% *** T&R RES
11B	4774		1/4W 4K12 1% T&R RES
11B	4910		1/4W 4K3 5% T&R RES
11B	4793		1/4W 4K590 0.1% *** T&R RES
11B	4627		1/2W 4K7 5% T&R RES
11B	4681		1.0W 4K7 5% T&R RES
11B	4827		1/4W 4K7 5% T&R RES
11B	4943		1/4W 4K7 5% .2"U T&R RES
11B	4982		1/4W 4K7 5%MINI T&R RES
11B	4639		1/4W 4K99 1% T&R RES
11B	6128		1/4W 4K99 1%MINI MF T&R RES
11B	4893		1/4W 5K1 5% T&R RES
11B	4939		1/4W 5K1 5% .2"U T&R RES
11B	6138		1/4W 5K1 5%MINI T&R RES
11B	4778		1/4W 5K36 1% T&R RES
11B	6141		1/4W 5K6 5%MINI T&R RES
11B	4662	CHECK INC	1/2W 5K6 5% T&R RES
11B	4685		1.0W 5K6 5% T&R RES
11B	4862		1/4W 5K6 5% T&R RES
11B	4753		1/4W 5K9 1% T&R RES
11B	5001		1/4W 6K04 1% T&R RES
11B	4717		1/4W 6K19 1%MINI T&R RES
11B	4870		1/4W 6K2 5% T&R RES
11B	4628		1/2W 6K8 5% T&R RES
11B	4665		5.0W 8K2 5% BLK RES
11B	4828		1/4W 6K8 5% T&R RES
11B	4978		1/4W 6K8 5%MINI T&R RES
11B	5020		1/4W 6K8 5% .2"U T&
11B	4801		1/4W 6K98 1% T&R RES
11B	6121		1/4W 6K98 1%MINI MF T&R RES
11B	4887		1/4W 7K5 5% T&R RES
11B	4926		1/4W 7K5 5% .2"U T&R RES
11B	4787		1/4W 7K960 0.1% *** T&R RES
11B	5004		1/4W 8K06 1% T&R RES
11B	4663		1/2W 8K2 5% T&R RES
11B	4863		1/4W 8K2 5% T&R RES
11B	4955		1/4W 8K2 5% .2"U T&R RES
11B	4990		1/4W 8K2 5%MINI T&R RES
11B	4792		1/4W 8K25 1% T&R RES
11B	5027		1/4W 9K09 1% T&R RES
11B	6112		1/4W 9K09 1%MINI MF T&R RES
11B	4810		1/4W 9K1 5% T&R RES
11B	4762		1/4W 9K760 0.1% *** T&R RES
11B	5016		1.0W 9K760 0.5% *** T&R RES
11B	4629		1/2W 10K 5% T&R RES
11B	4768		5.0W 12K 5% BLK RES

11 Resistors Jumpers etc.

SEQ	PRODUCT CODE	REPLACEMENT PRODUCT	DESCRIPTION
11B	4800		1/4W 10K0 1% T&R RES
11B	4829		1/4W 10K 5% T&R RES
11B	4940		1/4W 10K 5% .2"U T&R RES
11B	4960		1/4W 10K0 1% .2"U T&R RES
11B	4983		1/4W 10K 5%MINI T&R RES
11B	4989		1/2W 10K 5%MINI T&R RES
11B	5011		1/4W _10KX9 2% 10PIN SIP RES
11B	5031		1.0W 10K0 5% T&R
11B	6116		1/4W 10K0 1%MINI MF T&R RES
11B	4860		1/4W 11K 5% T&R RES
11B	4656	CHECK INC	1/2W 12K 5% T&R RES
11B	4856		1/4W 12K 5% T&R RES
11B	4953		1/4W 12K 5% .2"U T&R RES
11B	4773		1/4W 12K1 1% T&R RES
11B	4901		1/4W 13K 5% T&R RES
11B	4775		1/4W 14K0 1% T&R RES
11B	5008		1/4W 14K7 1% T&R RES
11B	4630		1/2W 15K 5% T&R RES
11B	4830		1/4W 15K 5% T&R RES
11B	4979		1/4W 15K 5%MINI T&R RES
11B	4876		1/4W 16K 5% T&R RES
11B	4771		1/4W 17K8 1% T&R RES
11B	4997		1/4W 7K87 1% T&R RES
11B	4784		1/4W 17K40 0.1% *** T&R RES
11B	4831		1/4W 18K 5% T&R RES
11B	4954		1/4W 18K 5% .2"U T&R RES
11B	6125		1/4W 18K 5%MINI T&R RES
11B	5021		1/4W 18K7 1% T&R RES
11B	4807	6123	1/4W 20K0 1% T&R RES
11B	4885		1/4W 20K 5% T&R RES
11B	6123		1/4W 20K0 1%MINI MF T&R RES
11B	4777		1/4W 21K5 1% T&R RES
11B	4632		1/2W 22K 5% T&R RES
11B	4832		1/4W 22K 5% T&R RES
11B	6118		1/4W 22K 5%MINI T&R RES
11B	5024		1/4W 22K6 1% T&R RES
11B	4902		1/4W 24K 5% T&R RES
11B	4633		1/2W 27K 5% T&R RES
11B	4833		1/4W 27K 5% T&R RES
11B	4956		1/4W 27K 5% .2"U T&R RES
11B	6129		1/4W 27K 5%MINI T&R RES
11B	4890		1/4W 30K 5% T&R RES
11B	4941		1/4W 30K 5% .2"U T&R RES
11B	5003		1/4W 30K1 1% T&R RES
11B	4917		1/4W 31K6 1% T&R RES
11B	4640	CHECK INC	1/2W 33K 5% T&R RES
11B	4840		1/4W 33K 5% T&R RES
11B	4947		1/4W 33K 5% .2"U T&R RES
11B	6122		1/4W 33K 5%MINI T&R RES

11 Resistors Jumpers etc.



SEQ	PRODUCT CODE	REPLACEMENT PRODUCT	DESCRIPTION
11B	4907		1/4W 34K8 1% T&R RES
11B	6147		1/4W 34K8 1%MINI T&R RES
11B	4868		1/4W 36K 5% T&R RES
11B	4794		1/4W 37K90 0.1% *** T&R RES
11B	4853		1/4W 39K 5% T&R RES
11B	6117	6154? SEE	1/4W 39K 5%MINI T&R RES
11B	6154		1/4W 39K2 1%MINI MF T&R RES
11B	5002		1/4W 42K2 1% T&R RES
11B	5009		1/4W 40K2 1% T&R RES
11B	4878		1/4W 43K 5% T&R RES
11B	4908		1/4W 45K3 1% T&R RES
11B	4634		1/2W 47K 5% T&R RES
11B	4834		1/4W 47K 5% T&R RES
11B	4927		1/4W 47K 5% .2"U T&R RES
11B	6119		1/4W 47K 5%MINI T&R RES
11B	6149		1/4W 47K5 1%MINI MF T&R RES
11B	4803		1/4W 49K9 1% T&R RES
11B	4895		1/4W 51K 5% T&R RES
11B	4835		1/4W 56K 5% T&R RES
11B	4928		1/4W 56K 5% .2"U T&R RES
11B	5018		1/4W 56K 5%MINI T&R RES
11B	4761		1/4W 60K4 1% T&R RES
11B	4848		1/4W 62K 5% T&R RES
11B	6139		1/4W 62K 5%MINI T&R RES
11B	6142		1/4W 64K9 1%MINI T&R RES
11B	4636	CHECK INC	1/2W 68K 5% T&R RES
11B	4836		1/4W 68K 5% T&R RES
11B	4760		1/4W 75K 5% T&R RES
11B	5007		1/4W 78K7 1% T&R RES
11B	4586		1/4W 82K 5%MINI T&R RES
11B	4837		1/4W 82K 5% T&R RES
11B	4929		1/4W 82K 5% .2"U T&R RES
11B	4763		1/4W 82K50 0.1% *** T&R RES
11B	4772		1/4W 82K5 1% T&R RES
11B	4898		1/4W 91K 5% T&R RES
11B	4838		1/4W 100K 5% T&R RES
11B	4942		1/4W 100K 5% .2"U T&R RES
11B	6120		1/4W 100K 5%MINI T&R RES
11B	4914	CHECK INC	1/4W 110K 5% T&R RES
11B	4776		1/4W 113K 1% T&R RES
11B	4851		1/4W 120K 5% T&R RES
11B	4976		1/4W 120K 5% MINI T&R RES
11B	4894		1/4W 130K 5% T&R RES
11B	4991		1/4W 133K 1%MINI T&R RES
11B	5026		1/4W 143K 1% T&R RES
11B	6155		1/4W 143K 1%MINI MF T&R RES
11B	4638		1/2W 150K 5% T&R RES
11B	4790		2.0W 150K 5%10MM BODY T&R RES
11B	4839		1/4W 150K 5% T&R RES

11 Resistors Jumpers etc.

SEQ	PRODUCT CODE	REPLACEMENT PRODUCT	DESCRIPTION		
11B	4796		1/4W 180K	5%MINI	T&R RES
11B	4849		1/4W 180K	5%	T&R RES
11B	4949		1/4W 180K	5% .2"U	T&R RES
11B	4886		1/4W 200K	5%	T&R RES
11B	6137		1/4W 200K	5%MINI	T&R RES
11B	4641		1/2W 220K	5%	T&R RES
11B	4668		2.0W 220K	5%10MM BODY	T&R RES
11B	4841		1/4W 220K	5%	T&R RES
11B	6126		1/4W 220K	5%MINI	T&R RES
11B	6130		1/4W 240K	5%MINI	T&R RES
11B	6145		1/4W 249K	1%MINI	T&R RES
11B	4679		1/2W 270K	5%	T&R RES
11B	4879		1/4W 270K	5%	T&R RES
11B	4972		1/4W 270K	5% .2"U	T&R RES
11B	6135		1/4W 270K	5%MINI	T&R RES
11B	4906		1/4W 300K	5%	T&R RES
11B	4842		1/4W 330K	5%	T&R RES
11B	4865		1/4W 390K	5%	T&R RES
11B	6146		1/4W 392K	1%MINI	T&R RES
11B	4643	CHECK INC	1/2W 470K	5%	T&R RES
11B	4843		1/4W 470K	5%	T&R RES
11B	6127		1/4W 470K	5%MINI	T&R RES
11B	6143		1/4W 499K	1%MINI	T&R RES
11B	4874		1/4W 560K	5%	T&R RES
11B	6106		1/4W 620K	5%MINI	T&R RES
11B	4880		1/4W 680K	5%	T&R RES
11B	4903	CHECK INC	1/4W 750K	5%	T&R RES
11B	4861		1/4W 820K	5%	T&R RES
11B	4844		1/4W 1M	5%	T&R RES
11B	4948		1/4W 1M	5% .2"U	T&R RES
11B	4797		1/4W 1M2	5%	T&R RES
11B	4820		1/4W 1M5	5%	T&R RES
11B	4845		1/4W 2M2	5%	T&R RES
11B	4846		1/4W 3M3	5%	T&R RES
11B	4888		1/4W 4M7	5%	T&R RES
11B	4951		1/4W 4M7	5% .2"U	T&R RES
11B	6132		1/4W 8M2	5%MINI	T&R RES
11B	4809		1/4W 10M	5%	T&R RES
11B	4751		1/4W 22M	5%	T&R RES
11C	4780		2.0W 0R15	5% MIN FUSIBLE	T&R RES
11C	2037		1/4W 10R	FUSIBLE	T&R RES
11C	2038		1/4W 11R3	FUSIBLE	T&R RES
11C	2039		1/4W 22R0	FUSIBLE	T&R RES
11C	2041		1/4W 39R0	FUSIBLE	T&R RES
11C	2042		1/4W 47R0	FUSIBLE	T&R RES
11C	2043		1/4W 75R	FUSIBLE	T&R RES
11C	2044		1/4W 101R0	FUSIBLE	T&R RES
11C	2045		1/4W 151R	FUSIBLE	T&R RES
11C	2046		1/4W 241R	FUSIBLE	T&R RES

11 Resistors Jumpers etc.

SEQ	PRODUCT CODE	REPLACEMENT PRODUCT	DESCRIPTION
11C	2047		1/4W 271R FUSIBLE T&R RES
11C	2048		1/4W 471R FUSIBLE T&R RES
11C	2049		1/4W 681R FUSIBLE T&R RES
11C	2050		1/4W 1K FUSIBLE T&R RES
11C	2051		1/4W 1K5 FUSIBLE T&R RES
11D	2005		1.0W 0R47 5%FLAME PROOF T&R RES
11D	2006		1.0W 1R 5%FLAME PROOF T&R RES
11D	2007		1/4W 1R 5%FLAME PROOF T&R RES
11D	2008		1.0W 10R 5%FLAME PROOF T&R RES
11D	2009		1/4W 10R 2%FLAME PROOF T&R RES
11D	2010		1/8W 10R0 2%FLAME PROOF T&R RES
11D	2011		1/4W 11R3 1%FLAME PROOF T&R RES
11D	2012		1/8W 15R 2%FLAME PROOF T&R RES
11D	2013		1/8W 22R1 1%FLAME PROOF T&R RES
11D	2014		1/8W 33R 2%FLAME PROOF T&R RES
11D	2015		1/4W 33R2 1%FLAME PROOF T&R RES
11D	2016		1/8W 39R 2%FLAME PROOF T&R RES
11D	2017		1/4W 47R5 1%FLAME PROOF T&R RES
11D	2018		1/8W 75R 2%FLAME PROOF T&R RES
11D	2019		1/8W 100R0 1%FLAME PROOF T&R RES
11D	2020		1/8W 150R 2%FLAME PROOF T&R RES
11D	2021		1/4W 200R 1%FLAME PROOF T&R RES
11D	2022		1.0W 220R 5%FLAME PROOF T&R RES
11D	2023		1/8W 220R0 1%FLAME PROOF T&R RES
11D	2024		1/8W 249R 2%FLAME PROOF T&R RES
11D	2025		1/8W 274R 1%FLAME PROOF T&R RES
11D	2026		1/4W 332R0 1%FLAME PROOF T&R RES
11D	2027		1/4W 390R 5%FLAME PROOF T&R RES
11D	2028		1/8W 475R 1%FLAME PROOF T&R RES
11D	2029		1/4W 590R 1%FLAME PROOF T&R RES
11D	2030		1/8W 681R 1%FLAME PROOF T&R RES
11D	2031		1/8W 820R 5%FLAME PROOF T&R RES
11D	2032		1/4W 1K 2%FLAME PROOF T&R RES
11D	2033		1/8W 1K 2%FLAME PROOF T&R RES
11D	2034		1/8W 1K5 5%FLAME PROOF T&R RES
11D	2035		1/4W 2K21 1%FLAME PROOF T&R RES
11D	2036		1/4W 36K0 1%FLAME PROOF T&R RES

PIN-OUTS

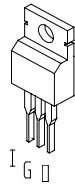
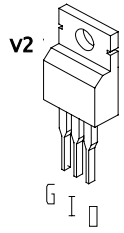

V1

TJ

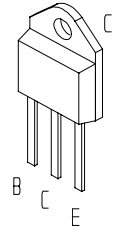
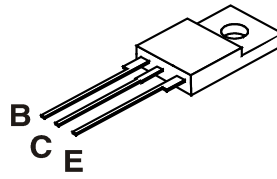

TK

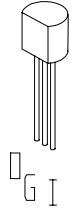
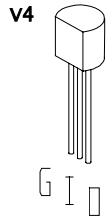

V3

TL

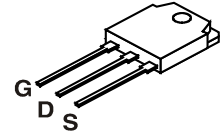
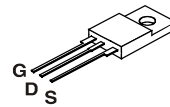

TM

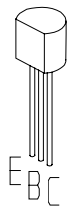
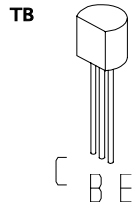

TA

TN

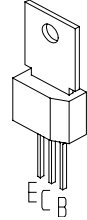
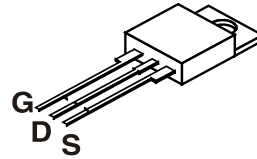

TO

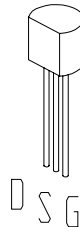
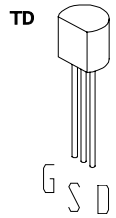

TC

TP

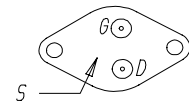
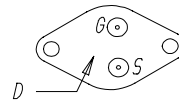

TQ

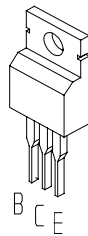
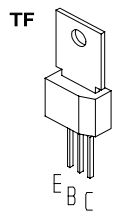

TE

TH

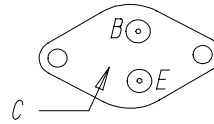

TI

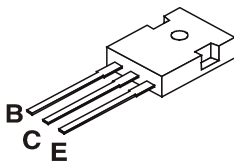

TG

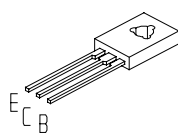

SEQ	PRODUCT CODE	REPLACEMENT PRODUCT	DESCRIPTION
12A	5101		BC550C T092 NPN TRAN T&R TB
12A	5102		BC560C T092 PNP TRAN T&R TB
12A	5103		MPSA06 T092 NPN TRAN T&R TA
12A	5104		MPSA56 T092 PNP TRAN T&R TA
12A	5107		2N5551 T092 NPN TRAN T&R TA
12A	5108		2N5401 T092 PNP TRAN T&R TA
12A	5109		MPSA43 T092 NPN TRAN TA
12A	5111	CHECK INC	MPSA17 T092 NPN TRAN T&R TA
12A	5113		MPSA42 T092 NPN TRAN T&R TA
12A	5114		MPSA92 T092 PNP TRAN T&R TA
12A	6780		MPSA56 T092 PNP TRAN TA
12A	6785		MPSA18 T092 NPN TRAN TA
12A	6789		2N3904 T092 NPN TRAN TA
12A	6790	N/A SEE NO	2N3906 T092 PNP TRAN TA
12A	6854		2N6517 T092 NPN TRAN TA
12A	5105		MPSA13 T092 NPN DARL T&R TA
12A	5116		BC264D T092 N JFET T&R TD
12A	5118		2N5485 T092 NCH JFET T&R TC
12A	5119		2N5638 T092 NCH JFET T&R TC
12A	5122		J109 T092 NCH JFET T&R TC
12A	6456		BF872 TO202 PNP TRAN TO
12A	6457		BF871 TO202 NPN TRAN TO
12A	6607	SEE NOTE	TIP111 TO220 NPN TRAN TE
12A	6612		TIP116 TO220 PNP TRAN TE
12A	6774		BD139 TO126 NPN TRAN TG
12A	6787		BD237 TO126 NPN TRAN TG
12A	6788		BD238 TO126 PNP TRAN TG
12A	6808		MJE15032 TO220 NPN TRAN TE
12A	6809		MJE15033 TO220 PNP TRAN TE
12A	6810		MJF15030 T221D NPN TRAN TJ
12A	6811		MJF15031 T221D PNP TRAN TJ
12A	6873		MJE340 TO126 NPN TRAN TG
12A	6874		MJE350 TO126 PNP TRAN TG
12A	6891		TIP50 TO220 NPN TRAN TE
12A	6893		MJE5730 TO220 PNP TRAN TE
12A	6906		BDT41C TO220 NPN TRAN TE
12A	6907		BDT42C TO220 PNP TRAN TE
12A	6908	6921	BD647 TO220 NPN TRAN
12A	6913	SEE INC.ST	2N6045 BD649 TO220 NPN TRAN DARL TE
12A	6926		BD140 TO126 PNP TRAN TG
12A	6803A	6802	BDV66D USE FOR 40B,40K,80B,80W ONLY
12A	D2058	2SD2058	D2058 TO220 PNP TRANSISTOR
12A	5117	6928	MTH15N20 TO218 NCH MFET T
12A	6730		IRF830 TO220 NCH MFET TN
12A	6737		MTP12P10 TO220 PCH MFET TN
12A	6752		MTP10N15L TO220 NCH MFET TN
12A	6762		IRFZ34N TO220 NCH MFET
12A	6777		MTA2955 T221D PCH MFET TL
12A	6778		MTA3055E T221D NCH MFET TL

SEQ	PRODUCT CODE	REPLACEMENT PRODUCT	DESCRIPTION
---	-----	-----	-----
12A	6781		MTW14P20 TO247 PCH MFET TM
12A	6782		IRFP31N50L TO247 NCH MFET TM
12A	6853		IRFZ44R NCH MFET TN
12A	6904	SEE INC.ST	IRF5210 TO220 PCH MFET TN
12A	6914	6967	IRFP350 TO247 NCH MFET TM
12A	6923		MTP2P50E TO220 PCH MFET TN
12A	6925		MTP8P20 TO220 PCH MFET TN
12A	6928		IRFP250 TO247 NCH MFET TM
12A	6930	6781	IRF720 TO220 NCH MFET TN
12A	6931		IRFP140N TO247 NCH MFET TM
12A	6932		IRFP9140N TO247 PCH MFET TM
12A	6933		MTP23P06 TO220 PCH MFET TN
12A	6947		SPW17N80C3 TO247 NCH MFET TM
12A	6953		IRF4905 TO220 PCH MFET
12A	6954		IRF3205 NCH MFET TN
12A	6966		IRL2910 NCH MFET 100V TN
12A	6967		IRFP23N50L TO247 NCH MFET TM
12A	6480	6991	2SA1302 T03P PNP TRAN PWR
12A	6791	6865	2N3055 TO3 NPN TRAN TH
12A	6801	6900	MJ15015 TO3 NPN TRAN TH
12A	6900		YS6900 (22) TO3 NPN TRAN TH
12A	6909		MJ21196 TO3 NPN TRAN TH
12A	6988		MJL21194 TO3P NPN TRAN TK
12A	6991		MJL21193 TO3P PNP TRAN TK
12A	7004		2SA2121-0 TO3P PNP TRAN TK
12A	6792	N/A	MJ2955 TO3 PNP TRAN TH
12A	6800		MJ15016 TO3 PNP TRAN TH
12A	6905	6927	MJ15025 TO3 PNP TRAN TH
12A	6910		MJ21195 TO3 PNP TRAN TH
12A	6927		YS6927 (23) TO3 PNP TRAN TH
12A	6750		2SJ48 TO3 PCH MFET TQ
12A	6751		2SK133 TO3 NCH MFET TQ
12A	6769		IRF9231 TO3 P CHAN MOSFET
12A	6734		IRG4PC50w TO247 NPN TRAN IGBT TM
12A	6758		IRG4PH40UD TO247 30A 1200VIGBT TM
12B	5106		MPSA63 TO92 PNP DARL T&R TA
12B	5112		MPSA29 100V TO92 NPN DARL T&R TA
12B	6814		MJF6668 T221D PNP TRAN DARL TJ
12B	6815		MJF6388 T221D NPN TRAN DARL TJ
12B	6885	SEE INC.ST	MJE271 TO126 PNP TRAN DARL TG
12B	6779		MJH11018(22) TO218 NPN TRAN DARL TI
12B	6802		MJH11017(23) TO218 PNP TRAN DARL TI
12B	6902		TIP142 TO218 NPN TRAN DARL TE
12B	6903		TIP147 TO218 PNP TRAN DARL TE
12B	6911	6903	BDX54C TO220 PNP TRAN DARL TE
12B	6912		BDX53C TO220 NPN TRAN DARL TE
12B	6916		TIP107 TO220 PNP TRAN DARL TE
12B	6917	6903	BDV64B TO218 PNP DARL TI
12C	6924		2SK2837 TO247 NCH MFET TM

SEQ	PRODUCT CODE	REPLACEMENT PRODUCT	DESCRIPTION
---	-----	-----	-----
12D	3796		ELASTOMER PAD TSIL 1.0X0.8
12D	3797		TO-247 THERMO CONDUCTIVE PAD
12D	3814		TO3 THERMAL CONDUCTOR ELASTOMER
12D	3815		TO3 PREGREASED MICA 56-03-2AP
12D	3823		TO-220 THERMO PAD SMALL HOLE
12D	3830		TO218 PREGREASED MICA 56-78-2AP
12D	3846		TO220 THERMO PAD LARGE HOLE 56359B
12D	3850		TO-220 PLASTIC TRANSISTOR INSULATOR
12D	3866		ELASTOMER PAD TSIL 3 1.2X6.0
12D	3884		SARCON THERMAL GASKET 4.55"X1.00"
12D	3916		TO3 SIL-PAD REPLACES MICA
12D	3929		ELASTOMER PAD 15GTR 1.75 X 1.25
12D	3959		TO220 THERMO PAD STICK-ON
12D	3960		TO247 THERMO PAD STICK-ON
12D	9928		TO-220 CERAMIC INSULATOR
12D	9929	N/A	TO-3P CERAMIC INSULATOR 0.080

SERVICE PARTS CATLOGUE

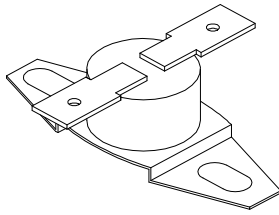

**3409** THERMO SW N/CLOSED OP/184F CL/144F

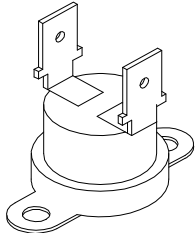

**3411** THERMO SW N/CLOSED OP/180F CL/155F

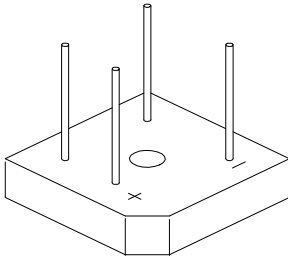

**6419** BRIDGE 35A 400V WIRE LEAD GI3504

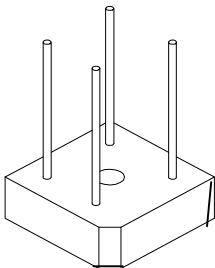

**6422** BRIDGE 8A 200V WIRE LEAD PBPC803

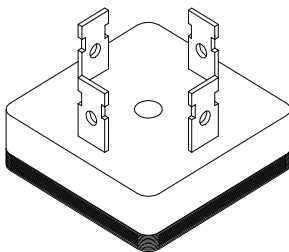

**6423** BRIDGE 35A 200V SUB 6428

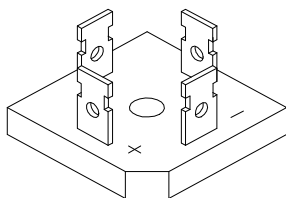

**6428** BRIDGE 35A 400V 250" TUB GBPC 3504



SEQ	PRODUCT CODE	REPLACEMENT PRODUCT	DESCRIPTION
---	-----	-----	-----
13A	6464		470K 10% 1/4W THERMISTOR 0.2 T&R
13A	6467		_10K 10% THERMISTOR TO-92 NTC
13A	6468	6477	100K 10% 1W0 THERMISTOR&SUB 6477*
13A	6469		__1K 5% 0W0 THERMISTOR
13A	6472		__4K7 3% 0W0 THERMISTOR
13A	6473		_68K 3% 0W0 THERMISTOR
13A	6474		_10R 3% 0W0 THERMISTOR PTC
13A	6477		100K 5% 1/4W THERMISTOR T&R 0.2
13A	6482		115R 20% 0W0 THERMISTOR PTC
13A	6489		__5R 20% THERMISTOR-SURGR NTC
13A	6491		0R32 20% 0W92 0.75AMP PTC AUTOFUSE
13A	6494		0R10 20% 2W1 1.85AMP PTC AUTOFUSE
13A	6495		0R06 20% 2W5 2.5 AMP PTC AUTOFUSE
13A	6496		0R20 20% 2W5 1.1 AMP PTC AUTOFUSE
13A	6499		0R15 20% 1W7 1.35AMP PTC AUTOFUSE
13A	6501		0R25 20% 0W92 0.95AMP PTC AUTOFUSE
13A	4595		VARISTOR 23J 275V MOV 7MM
13B	6419		BRIDGE 35A 400V WIRE LEAD GI3504
13B	6770		BRIDGE 50A 400V WIRE LEAD SIP
13B	6772		BRIDGE 25A 400V WIRE LEAD SIP
13B	6775		BRIDGE 10A 600V WIRE LEAD SIP

SEQ	PRODUCT CODE	REPLACEMENT PRODUCT	DESCRIPTION
---	-----	-----	-----
14A	5123		NJM431L T092 S 2V0 REG TR V4
14A	6728		MC78L05ACP T092 P 5V0 REG TR V4
14A	6731		7824 TO220 P 24V0 REG
14A	6732		MC79L05ACP T092 N 5V0 REG V4
14A	6738		MC7805CT TO220 P 5V0 REG V1
14A	6741		MC78L12CP T092 P 12V0 REG V3
14A	6742		MC79L12CP T092 N 12V0 REG V4
14A	6746		MC7912CT TO220 N 12V0 REG V2
14A	6747		MC7812CT TO220 P 12V0 REG V1
14A	6756		500MA TO220 P 12V0 REG V1
14A	6855		NJM7805FA TO220 P 5V0 REG IS V1
14A	6856		NJM7815FA TO220 P 15V0 REG IS V1
14A	6857		NJM7915FA TO220 N 15V0 REG IS V2
14A	6871		MC7915CT TO220 N 15V0 REG V2
14A	6872		MC7815CT TO220 P 15V0 REG V1
14E	2467	SERV. DEPT.	F4A 5X20MM FUSE

SEQ	PRODUCT CODE	REPLACEMENT PRODUCT	DESCRIPTION
15A	6743		NE572N IC COMPANDER
15A	6753		SGS IC POWER AMP DEVICES
15A	6754		NJM072BL IC DUAL OPAMP INLINE
15A	6755		LM3876T IC 40 WATT POWER AMP
15A	6757		LM3886 IC 85 WATT POWER AMP
15A	6759	SEE NOTE	NJM4580L IC DUAL OP AMP SIL8
15A	6798		MC4741CP IC QUAD OP AMP
15A	6804		MC33079P IC QUAD OP AMP
15A	6823		CA3080E IC OP AMP TO5
15A	6839		741CP1 IC OP AMP
15A	6840		MC33078P IC DUAL OP AMP
15A	6867		LM339N IC QUAD COMPARATOR
15A	6878		TL071CP IC FET OP AMP
15A	6882		TL072CP IC FET DUAL OP AMP
15A	6884		NE5532N IC DUAL OP AMP
15A	6889		TL074CN IC QUAD O/A T.I ONLY
15A	6894		LM3916 IC LED DISPLAY DRIVER
15A	6895		BA6822S IC LED VU METER C
15A	6899		LM318N IC OP AMP
15A	6950		TLE2062CP IC LOW CUR DUAL OP AMP
15A	6987		NJM2901N IC DUAL COMPARATOR
15A	6882TI	6882	TL072CP IC DUAL O/A TEXASI ONL
15A	6600		LM556 IC DUAL TIMER
15A	6639		L6561 IC POWER FACTOR
15A	6745		LM13600N IC XCONDUCTANCE AMP
15A	6813	SEE INC.ST	LM3915 IC LED DRIVER
15A	6935		1455P1 IC SINGLE TIMER
15A	6999		THAT 2180LB IC VCA SIP
15A	6601		4015 IC DUAL 4BIT REGULATOR
15A	6602		4018 IC DIVIDE BY N COUNTER
15A	6603		74HC14N IC HEX INV SCHMID
15A	6604		4069 IC HEX INVERTER
15A	6605		74HC86N IC QUAD 2INP XOR
15A	6936		4007 IC COMPLIMENTARY PAIRS
15A	6949		4093BCP IC QUAD 2I/P SCH/TRIG
15A	6959		4052 IC DUAL 1\4 CMOS SWITC
15A	6963		4053 IC 3 1 OF 2 CMOS
15A	6606		74LS00 IC QUAD 2 INPUT POS. G
15A	6610		74LS393 IC DUAL 4 BIT
15A	6937		74HC373N IC OCTAL LATCH 3 STAGE
15A	6942		74HC139 IC DUAL 2OF4 DECODER
15A	6943		74HC374N IC OCTAL DTYPE LATCH
15A	6962		74HC30 IC 8-INPUT NAND GATE
15A	6964		74HC74N IC DUAL FLIPFLOP
15A	6980		MC74HC595AN IC 8 BIT SHIFT REGISTE
15A	6995		74HC597N IC 8BIT SHRE6 PARE IN
15A	7001		74HC4051N IC 8TO1 CMOS SWITCH
15A	6641		DS1233D-10 IC RESET SENSE
15A	6749	CHECK INC.	MN3101 IC DELAY CLOCK DRIVER

15 ICs etc.

SEQ	PRODUCT CODE	REPLACEMENT PRODUCT	DESCRIPTION
---	-----	-----	-----
15A	6883		TC4427CPA IC FET DUAL DRIVER
15A	6887		IR2110 IC HILO FET DRIVER
15A	6945		745188 PROM IC PREPROG. FOR AP/MXR
15A	6946		27C64 200NS IC PREPROG. FOR LP-304
15A	6948		27C64 200NS IC PREPROG. FOR LP-608
15A	6961		80C51BH IC CPU/ROM FOR LP-304
15A	6970		AT24C02 IC EEPROM 128 BYTES
15A	6981		27C512 PROM IC YORKVILLE 16X16 PRG
15A	6982		27C512 PROM IC YORKVILLE 32 PROGRA
15A	6983		27C010 PROM IC YS STEREO/MONO PGM
15A	6984		IC 128KX8 IC SRAM 70NS
15A	6992		1365-102 IC DIGITAL REVERB ASIC
15A	6993		1250-101 IC SRAM 32KX8
15A	6996		68HC705P9CP IC MICROCOMPUTER
15A	7000		DS1868-10 IC DIGITAL POT
15B	3507		"28 PIN X .6"" I.C DEEP SOCKET"
15B	3550		44PIN I.C PLCC SOCKET
15B	3555		40 PIN DUAL IN-LINE IC SOCKET
15B	3557		84 PIN I.C PLCC SOCKET
15B	3562		16 PIN SOCKET W3116T WINSLOW
15B	3564		8-PIN I.C SOCKETS
15B	3570		14 PIN SCKT CLOSED FRAME DIP ONLY
15B	3571		"28 PIN X .6"" I.C. SOCKET"
15B	3629		SNAP IEC PWR SOC W/.250TAB FOR .04
15B	3663		SNAP IEC PWR SOC W/.250TAB FOR .060
15B	3791		16 AMP IEC PANEL MOUNT SOCKET
15C	3506		32PIN IC DEEP SOCKET X0.6"
15C	6994		44PIN CRYSTAL CODEC I.C PLCC
15C	6939		12MHZ CRYSTAL HC49\FOX120
15C	6940		16MHZ CRYSTAL VERT 2-PIN.25"CASE
15C	6997		_4MHZ CRYSTAL HC495

SEQ	PRODUCT CODE	REPLACEMENT PRODUCT	DESCRIPTION
---	-----	-----	-----
16A	8615		4-40 X 1/8" HEX SPACER ALUMINUM
16A	8663		11/64 NYLON SPACER (MICRO PLASTIC)
16A	8607		3/16 NYLON SPACER OD 1/8 X ID .063
16A	8866		#6 NYLON SPACER OD.250XID.140X.187
16A	3742	N/A	.250 SPACER ID.170 OD.31 ALUMINUM
16A	3752		SNAP IN 1/4 SPACER RICHCO
16A	8629		10-32 X 1/4 SPACER PHENOLIC
16A	8656		.171 X 1/4 NYLON SPACER #SP42
16A	8851		.250 SPACER ID.190 OD.31 ALUMINUM
16A	3751		SNAP IN 5/16 SPACER RICHCO
16A	3744		SNAP IN .375 SPACER RICHCO
16A	3749		.375 SPACER ID.170 OD.31 NYLON
16A	3833		8 X 3/8 (250 OD, .171 ID)NY SPACER
16A	3739		CUSTOM .4 LED SPACER
16A	3741		.5 SPACER ID-.171 OD-.25 #912-500
16A	3743		SNAP ON 0.5" SPACER RICHCO
16A	3851		1/2 PCB PLASTIC SPACER
16A	3859		1/2 PLASTIC HEX SPACER #4
16A	3865		1/2 PLASTIC HEX SPACER #6
16A	8664		4-40 X 0.5 SWAGE SPACER (ROUND)
16A	8665		6X1/2 METAL SPACER FOR GUITABEC PLT
16A	8668		#6 X 5/8 PLASTIC SPACER #13SP065
16A	8580		CUSTOM .625 SPACER
16A	3858		3/4 PLASTIC HEX SPACER #4
16A	8626		10-32 7/8 HEX SPACER ALUM
16A	4007		CUSTOM .9 LED SPACER
16A	8657		6-32 X 3/8" HEX SPACER ALUMINUM
16A	8658		3/16 SPACER ID .110/OD .25 ALUM
16A	8669		4-40 X 5/8" HEX SPACER ALUMINUM
16A	8505		4-40 X 1/2" HEX SPACER ALUMINUM
16A	3567	N/A	XSISTR SPRING CLIP #56379-SOT93
16B	3888		12"RCA SINGLE CABLE 0'/90' BLACK

SEQ	PRODUCT CODE	REPLACEMENT PRODUCT	DESCRIPTION
---	-----	-----	-----
17A	5190		MBS4992 T092 8V5 DIAC T&R
17A	6448		BT139 TO220 16A TRIAC 500V
17A	6453		2N6161 TO263 30A TRIAC 400V
17A	6470		MAC15A6FP TO220 15A TRIAC 400V
17A	6517		STM-BTB-600BRG TO220 ??A TRIAC 600V
17A	5191		MCR100-6 T092 0.8A SCR 600V
17A	6424		2N5169 TO263 20A SCR 200V
17A	6478		AS35FN-T092 TEMPERATURE SENSOR
17A	6481		0.5A 60 PTC CURRENT LIMITER

SEQ	PRODUCT CODE	REPLACEMENT PRODUCT	DESCRIPTION
18A	6443	CHECK INC	MOC3041 OPTO-COUPLER TRIAC DRIV
18A	6849		MOC3021 OPTO-COUPLER
18A	6858		NSL-32SR2 OPTO-COUPLER LDR
18A	6859		NSL-28AA OPTO-COUPLER
18A	6860		VTL5C8 OPTO-COUPLER
18A	6862		MOC3011 OPTO-COUPLER
18A	6876		NSL-28 OPTO-COUPLER
18A	6880		4N35 OPTO-COUPLER
18A	6881	N/A	H11A817C OPTO-COUPLER IC CSA
18A	6941		MOC5008 OPTO-COUPLER

SERVICE PARTS CATALOGUE

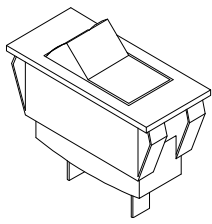

- 2460** 8.00 AMP SWITCH BREAKER BLUE
- 2461** 8.00 AMP SWITCH BREAKER RED NEON
- 3590** 12.0 AMP SWITCH BREAKER WHITE
- 3591** 4.00 AMP SWITCH BREAKER WHITE

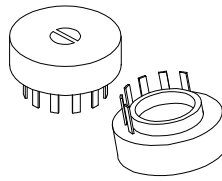

- 3686** SP5T ROTA SW PCMT V BREAK B4 MAKE

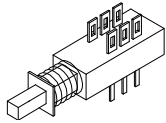

- 3421** DPDT PUSH SW PCMT MAKE B4 BREAK
- 3436** DPDT PUSH SW PCMT H BREAK B4 MAKE

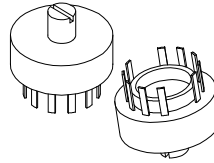

- 3687** DP3T ROTA SW PCMT V MAKE B4 BREAK

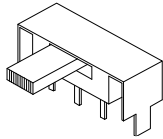

- 3424** DPDT SLID SW PCMT H GOLD CONTACTS

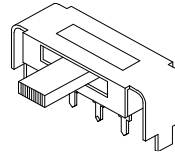

- 3689** DP3T SLID SW PCMT SILVER CONTACTS

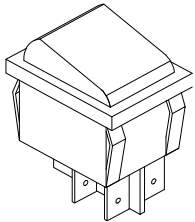

- 3472** SPST ROKR SW QUIK 250" RED NEON

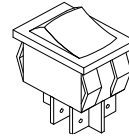

- 3691** DPDT ROKR SW QUIK 180" AC/POWER
- 3698** SPST ROKR SW QUIK 180" AC PWR BL/BL

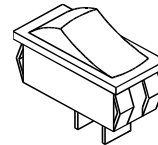

- 3695** SPST ROKR SW QUIK 250" WHITE/BLACK
- 3587** DPDT ROKR SW QUIK 250" AC/PWR SEMKO

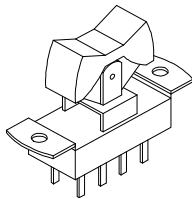

- 3475** DPDT ROKR SW PCMT GREY UID
- 3476** DPDT ROKR SW PCMT WHIT UID

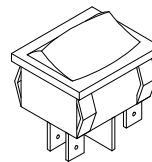

- 3701** DPST ROKR SW QUIK 180" AC/POWER EUR

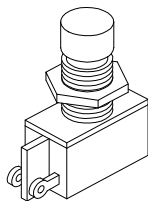

- 3588** SPST FOOT SW LUG MOMENTARY ON



SEQ	PRODUCT CODE	REPLACEMENT PRODUCT	DESCRIPTION
---	-----	-----	-----
19A	3475		DPDT ROKR SW PCMT GREY UID
19A	3476		DPDT ROKR SW PCMT WHIT UID
19A	3522		DPDT PUSH SW PCMT V MINI SNAP-
19A	3533		DPDT SLID SW LUG 6STRAIT CONTACTS
19A	3554		DPDT TOGGLE SW QUICK .250" CARLING
19A	3396		4POSITION DIP SW KAP1104E
19A	3400		SPDT PUSH SW PCMT H MOMENTARY MINIA
19A	3407		4PDT SLID SW PCMT V GOLD CONTACTS
19A	3421	SEE NOTES	DPDT PUSH SW PCMT MAKE B4 BREAK
19A	3424		DPDT SLID SW PCMT H GOLD CONTACTS
19A	3425		DPDT PUSH SW PCMT MAKE B4 BREAK
19A	3429		SPDT ROKR SW QUIK 180' AC PWR BL/BL
19A	3430		DPST ROKR SW PCMT AC/POWER BLK SEMK
19A	3436		DPDT PUSH SW PCMT H BREAK B4 MAKE
19A	3437	3522	DPDT PUSH SW PCMT V MINI UGT 3522
19A	3439		SP SERIES VERTICAL MOM PCB SWITCH
19A	3440		4PDT MINI VERT ALT SWITCH
19A	3442		SPTT SLID SW
19A	3469		DP3T ROKR SW PCMT V BLUE
19A	3585		DPDT ROKR SW QUIK 250" AC/PWR IEC65
19A	3587		DPDT ROKR SW QUIK 250"AC/PWR ON-OFF
19A	3588		SPST FOOT SW LUG MOMENTARY ON
19A	3689		DP3T SLID SW PCMT SILVER CONTACTS
19A	3698		SPST ROKR SW QUIK 180" AC PWR BL/BL
19A	3702		DPST ROKR SW 187" AC PWR SEMKO
19A	3705		4P3T SLID SW PCMT H
19A	6544		DPDT TOGGLE SW QUICK .250" 6 TERM
19A	6548		2P3T SLID SW PCMT V
19B	3696		RELAY 1C 02AMP DC24 006MA PC-S
19B	3697		RELAY 2C 02AMP DC05 100MA PC-S
19B	3699		RELAY 1C 02AMP DC48 006MA PC-S
19B	3700		RELAY 2C 01AMP DC24 015MA PC-S
19B	3721		RELAY 1A 16AMP DC24 022MA PC-C
19B	3722		RELAY 1A 30AMP DC24 036MA PC-C
19B	3723		RELAY 1C 40AMP DC24 066MA PC-S
19B	3735		RELAY 1A 16AMP DC48 011MA PC-C
19B	3736		RELAY 1C 10AMP DC24 017MA PC-S
19B	3794	3723	RELAY 1C 40AMP DC24 066MA PC-S

SEQ	PRODUCT CODE	REPLACEMENT PRODUCT	DESCRIPTION
20A	1192	CH1192	AP6020 125VAC 60HZ T'RD
20A	1193		A4.4 PC MOUNT SWITCHING T'RD
20A	1194	CH1194	AP6040 125VAC 60HZ T'RD
20A	1195		CR5 120VAC 60HZ T'RD
20A	1202	SEE NOTES	400B/H XFMR
20A	1203		BLOC-80BE/S100GE/100KE XFMR
20A	1204		TS120B/TS140 XFMR
20A	1206		BM50CE,BLOC/40CE 230VAC 50HZ XFMR
20A	1210		PM16/22 SMPS, BOOST INDUCTOR
20A	1211		PM16/22 SMPS, T0230 XFMR
20A	1225	N/A	GS-90D XFMR
20A	1234	N/A	G-20/LP-304 LP-504D XFMR
20A	1235	N/A	PROCESSORS PC MOUNT < 1989 XFMR
20A	1237	1248	MP-8 AFTER MAY/94 (BOBBIN) XFMR
20A	1242		PROCESSOR PC MOUNT CE 220/125V XFMR
20A	1247		M8 PC MOUNT SWITCHING XFMR
20A	1248		SR-300 POWER TRANSFORMER T'RD
20A	1257		EF2200P 120VAC POWER TRANSFMR T'RD
20A	1261		M-12 120/240 50/60HZ TRFMR T'RD
20A	1279	N/A	BLOC-100K XFMR
20A	1283	N/A	BETA-150/EQ/ BLOC-150B/ MM-4 XFMR
20A	1285	N/A	PPW XFMR
20A	1287	CH1287?CHK	PPW/EPW 120VAC 60HZ T'RD
20A	1292	N/A	PS-600/X-3000 XFMR
20A	1299	N/A	6400/PM-100/S-150G/GS200B/150D XFMR
20A	1301	CH1196E?CK	AP-3000E 230V 245VAC T'RD
20A	1307	CH1198E?SE	AP-1200E 230V 245VAC T'RD
20A	1308		LT-70V LINE MATCHING XFMR
20A	1309		BLOC-40B/40K/40w/50B XFMR
20A	1310		AM100 XM100 BM100 100K 4200 XFMR
20A	1311	N/A	6401/TS-10/15/20/8/12/16201 XFMR
20A	1316		MM-6 XFMR
20A	1327		YCV80 POWER XFMR
20A	1328		CR12 120VAC 60HZ T'RD
20A	1330		YCV20 POWER 120VAC 60HZ XFMR
20A	1366	N/A	G1B/G1VC/G1SC EARLY VERSION XFMR
20A	1367	N/A	G2B/G2VC/G3/G3-VC XFMR
20A	1368		YVM10/YPM250 XFMR
20A	1397	CH1397	E160P DBL/INSL 120VAC T'RD
20A	1190E		PM16/22E SMPS, F1K XFMR
20A	1192E		AP6020E 230-245VAC 50HZ T'RD
20A	1193E		A4.4E SMPS PCMOUNT 50HZ XFMR
20A	1195E		CR5 230-245VAC 50HZ XFMR
20A	1197E		AP4040E 230-245VAC 50HZ T'RD
20A	1197J		VX2400J 100VAC 50HZ T'RD
20A	1198J		VX1200 100V 50/60HZ T'RD
20A	1199E		PM16/22 230-45VAC 50HZ T'RD
20A	1207E		400BE T'RD
20A	1246E	N/A	300KE 230V 245VAC T'RD

SEQ	PRODUCT CODE	REPLACEMENT PRODUCT	DESCRIPTION
---	-----	-----	-----
20A	1248E		SR-300E 230AC 50HZ T'RD
20A	1250E		MP-8DXE TRANSFORMER T'RD
20A	1251E		MP-8DE/10DS 230/245VAC 50HZ T'RD
20A	1251FE		SR6325 CE-APRVD 230/254 50HZ T'RD
20A	1253E		AP312E PWR TRAN T'RD
20A	1255E		EF500PCE PWR TRAN 230VAC T'RD
20A	1279J		BLOC-100KJ 100VAC 50/60HZ XFMR
20A	1288E		AP-3400E 230V 245VAC T'RD
20A	1300E		AP-3000E 230V 245VAC T'RD
20A	1306E		AP-1200E 230V 245VAC T'RD
20A	1309E		BM50CE,BLOC/40CE 230VAC 50HZ XFMR
20A	1309J		50K JAPANESE 100VAV XFMR
20A	1310J		100W, 100K 100VAC 50HZ XFMR
20A	1316E		MM-6E XFMR
20A	1318E		AP-812E T'RD
20A	1321J		VX800J 100VAC 50/60HZ T'RD
20A	1324E		YCV40 PWR TRAN 230VAC 50HZ XFMR
20A	1324J		YCV40 PWR TRAN XFMR
20A	1325E		YSM1P PWR TRAN 230VAC 50HZ T'RD
20A	1327E		YCV80CE PWR TRAN XFMR
20A	1327J		YCV80 POWER XFMR
20A	1327M		YCV80 O/P TRAN XFMR
20A	1328E		CR12 240VAC 50HZ T'RD
20A	1329E		YS115PCE 230-245VAC 50HZ XFMR
20A	1330E		YCV20 PWR TRAN 230VAC 50HZ XFMR
20A	1330J		YCV20 PWR TRAN 100VAC 60HZ XFMR
20A	1330M		YCV20 O/P TRAN XFMR
20A	1397E		E160PCE 230-245VAC 50HZ T'RD
20A	1398E		SUB CH1398E 62VSEC 230VAC 50HZ
20A	1402E		_????? 168VA 230VAC 50HZ T'RD
20A	A1310		YBA-1/4,YRM1/SC(ORIGINAL)PWR XFMR
20A	CH1196		AP4020 T'RD
20A	CH1197E		AP4040E 230-245VAC 50HZ T'RD
20A	CH1197U		AM-1 UNIVERSAL 204/245 60/50HZ T'RD
20A	CH1198		AP2020 120VAC 60HZ T'RD
20A	CH1199		PM16/22 120VAC 60HZ T'RD
20A	CH1207		XS400/H 120VAC 60HZ T'RD
20A	CH1250		MP-8DX TRANSFORMER T'RD
20A	CH1254		NX520P POWER TRANSFORMER T'RD
20A	CH1254E		NX520PCE PWR TRAN 230VAC T'RD
20A	CH1255		EF500P PWR TRAN 120VAC T'RD
20A	CH1255E		EF500PCE PWR TRAN 230VAC T'RD
20A	CH1256		LS800P PWR TRAN 120VAC T'RD
20A	CH1287		PPW/EPW 120VAC 60HZ T'RD
20A	CH1318		AP-812 120VAC 60HZ T'RD
20A	CH1320		TXP SERIES T'RD
20A	CH1321		AP800 120VAC 60HZ T'RD
20A	CH1324		YCV40 POWER 120-100VAC 50-60HZ XFMR
20A	CH1324M		YCV40 O/P TRAN XFMR

SEQ	PRODUCT CODE	REPLACEMENT PRODUCT	DESCRIPTION
---	-----	-----	-----
21A	3893		AAVID HEATSINK 5811B
21A	3795		#8 GROUND LUG ZIERICK 505-169
21A	9925		TINNERMAN CLIP 1/8" STUD SIZE ROUND
21A	9926	N/A	AAVID MAX CLIP MAX03
21A	9927	N/A	AAVID MAX CLIP MAX20
21A	CLP0016		CLIP 205X032 14-16AWG DISC/INSUL
21A	CLP0018		CLIP 250X032 18-22AWG DISCO/INSL
21A	9902	SUB LG-A1	GEL SET FOR LP-304
21A	8493		6-32 X 1 1/4 PEM STUD
21A	8494		6-32 X 1/2 PEM STUD FH-632-8CI
21A	8496		10-32X1/2 STEEL PEM STUD
21A	8498		6-32 X 3/8 STEEL PEM STUD
21A	8499		6-32X1 STEEL PEM STUD
21A	3546		14 CIR WAFER W/LCK VT 0.1"
21A	3580		12 CIR WAFER W/LCK VT 0.1"
21A	3583		_8 CIR WAFER W/LCK 0.1"
21A	4002		10 CIR WAFER W/LCK VT 0.1"
21A	4004		_9 CIR WAFER W/LCK VT 0.1"



Note: Alternative methods for determining what Pot or Knob  
 Use our QUICK REFERENCE Charts (available for many products) or look on the Circuit Board Layouts (we try to include a chart as well)

POT LISTING BY PRODUCT



MODEL NAME	VOLGAIN/DRIVE	LOW EQ	MID EQ	MID SWEEP	HIGH EQ	NOTCH/SCO OP	PRESENCE	RWFX SEND	MON SEND	AUX SEND	BAL/PAN	CHAN LEVEL	MAIN MAST.	MON MAST.	ZONE 1/2	HP X-FADE	EFX SEND	EFX RETN	EFX> MAIN	EFX> MON	MAIN EQ	MON EQ	AUX RETN	EFX SELECT	EFX modify	PHONES LEVEL	OTHER
<b>50KW</b>	4409#1 4406#2	4406			4406																						
<b>50B/100B/200B</b>	4409	4406	4406		4406																						
<b>100K</b>	4403 #1, 2 & 3	4406			4406			4403																			
<b>100W</b>	4409#1 4403#2	4406			4406																						
<b>200K</b>	4559(1&2)4561(3&4)	4563			4563			4561					4562														
<b>300K</b>	4564	4563			4416			4414					4564						4564				4564				
<b>400B</b>	4557											4558										3996x11					
<b>A4.4</b>	4749x2																										
<b>AM50</b>	4417#1 4418#2	4420			4420	4417		4417																			
<b>AM100</b>	4417#1 4418#2	4420	4420		4420	4419		4417																	4527		
<b>AM150</b>	4417#1 4418#2	4420	4420		4420	4419		4417						4419											4527		
<b>AP-1200</b>	4400x2																										
<b>AP-1212, etc.</b>	4559	4401	4402		4402			4561x2	4561x2		4402	4574	4582x3	4582x2				4563x2	4564x4	4564x2	4561x2	3995x9	3996x9	4564	4581	4564	
<b>AP2020/4020/4040</b>	4390x2	4401	4402		4402			4561x2	4561x2		4402	4574	4582x3	4582x2				4563x2	4564x2	4564x2	4561x2	3995x9	3996x9	4564	4581	4564	
<b>AP-3000/AP-3400</b>	4409x2																										
<b>AP6020/AP6040</b>	4390x2																										
<b>AP-800</b>	4390x2																										
<b>AP-812/312</b>	4567	4546	4537		4537			4566	4566		4537	4584	4579x2	4568				4568	4572	4566	3996x9	3996x9			4581x2	4568	
<b>BETA-150/EQ</b>	4400																										
<b>BLOC-100K</b>	4530 #1, 2 & 3	2x4530	2x4540		2x4531			4531					4540										3994x10				
<b>BM200 / BM200T</b>	4409	4406	4406		4406																						
<b>BM400</b>	4566												4502									3996x11					
<b>BM50 / BM100</b>	4409	4406	4406		4406																						
<b>CR5 / CR12 / CR670</b>	4497x2																										
<b>DJM806</b>	4569	4545	4562		4562			4384				4487/89	4487		4569x2	4534						3995x7			4581	4581	4571
<b>EX2 (eXcursion 2000)</b>	4537x3																										
<b>EF160</b>	4403																										
<b>EF500P</b>	4566 (mic & line)	4546			4537								4537														
<b>EP Processors</b>																											
<b>Unity™ Processors</b>																											2x4518
<b>EPW/ES700P</b>	4403				4389																						2x4518
<b>LP-608</b>	4580																										
<b>MS</b>																											
<b>M810M/1610</b>	4443	4435/4439(stereo)	4434		4434/4438(stereo)			4443	4433		4434	4432	4441	4441				4433				4435			4581	4581	4437
<b>MM-4</b>	4560	4563			4561									4563													
<b>MM-6</b>	4391	4393			4392			4393	4393				4393	4393						4393		3999x6					
<b>MP-10DS</b>	4570	4568	4566		4566			4566	4567		4566		4571	4566						4566		3995x9			4581x2		
<b>MP-6</b>	4560	4563			4561			4563	4563				4563	4563						4563	4563						
<b>MP-6T</b>	4567	4568			4568			4568	4567				4568	4568							4568	4568	3999x9				
<b>MP-8</b>	4560	4563			4561			4563	4563				4563	4563								4563	4563				
<b>MP-8D</b>	4567	4568			4566			4566	4567				4566	4566												4583	
<b>MP-8DX</b>	4391	4393	4392		4392			4393	4391				4393	4393							4568	4568	3999x9			4583	4581x2
<b>NX200S</b>	4403																										
<b>NX520P / NX550P</b>	4566 (mic & line)	4546			4537								4537														
<b>PM stereo chan's</b>	4569	4545	4562	4562	4562			4384x2	4384x2	4384	4537	4572															
<b>PM11/22</b>	4566	4537	4537	4385	4537			4384x2	4384x2	4384	4537	4584	4579x2	4568x2				4579x2	4518	4569x3	4566x6	3996x9	3998x18	4581x2		4569	
<b>PPW/PS210P</b>	4403																										
<b>PS110P</b>	4403																										
<b>PS210PX</b>	4403x2																										
<b>PS218P</b>	4403																										
<b>SR-300</b>	4390x2																										
<b>TX2P</b>	4388x4																										
<b>TX3P/TX4P</b>	4388x6																										
<b>TX8P</b>	4388x8																										
<b>XM50</b>	4418	4420	4420		4420																						
<b>XM100</b>	4418	4420	4420		4420	4417																					
<b>XS400(H/T) / XS800H</b>	8309	8309	8309		8309	8309							8309												8309		
<b>YS-115P/Y115P</b>	4403																										
<b>Y118PW</b>	4403																										
<b>YBA200</b>	4425	4425	4423		4424	4425							4425														
<b>YCV20</b>	4x4425	4425	4423		4424								4424														4424(range) 4425(res)
<b>YCV40/40T</b>	4425/4425	4425	4423		4424								4425														
<b>YCV80/80Q</b>	4425/4425	4425	4423		4424				4423				4425														
<b>YSM1P</b>	4497																										

# Yorkville Speaker Component Chart

## élite Series

Model	Speakers	Recone Kit	Horn Driver	Diaphragm	Tweeter	Bulb		
						YS #	Mfg. #	Rating
E10	10MB400	10MB400KIT	7398	7398KIT		3647	1141	12V,18W
E12	12/059Y8M	12/059Y8MKIT	7393					
E15	7392	7392KIT	7393	7393KIT				
E210	7399x2	7399KIT	7393	7393KIT				
E152	7400	7400KIT	7401	7401KIT				
E215	15/139Y8Mx2	15/139Y8MKIT	7402	7402KIT				
E2152 (2007 +)	L15K80Yx2	15K80R	7403	7401KIT				
E2152 (2005-2006)	L15K80Yx2	15K80R	7403	7401KIT				
E2152 (before 2004)	L15K80Yx2	15K80R	7403	7401KIT				
E160	L10/581 (sub 10MB400)	10/581R	N252XN	M-73		3643	93	12V,15W
EM378	12/059Y8M	12/059Y8MKIT	7401	7401KIT		3652	P45T	24V,55/50W
EF500P	15/138Y8M	15/138Y8MKIT	7401	7401KIT		3652	P45T	24V,55/50W
LS608	7458	7458KIT						
LS800P (before Jun/05)	18/063Y8M	18/063Y8MKIT						
LS800P (afterJun/05)	7459	7459KIT						
LS808	7458	7458KIT						
LS1208 (before Jun/05)	18/063Y4M	18/063Y4MKIT						
LS1208 (afterJun/05)	7460	7460KIT						
LS700P	7269 x 2							

## Unity Series

Model	Speakers	Recone Kit	Horn Driver	Diaphragm	Tweeter	Bulb		
						YS #	Mfg. #	Rating
U15	7404 wfr / 7405x3 mid	7404KIT / N/A	7402	7402KIT				
U215	7407 wfrx2 / 7405x3 mid	7407KIT / N/A	7402	7402KIT				
U15P	7439 wfr / 7405x3 mid	7439KIT / NA	7402	7402KIT				
UCS1P	7447	7447KIT						

## eXcursion Series

Model	Speakers	Recone Kit	Horn Driver	Diaphragm	Tweeter	Bulb		
						YS #	Mfg. #	Rating
EX1	7446	7446KIT						
EX1SAT	7328	7328KIT	7453	7453KIT				
EX2 (before Jun/05)	18/063Y8M	18/063Y8MKIT						
EX2 (afterJun/05)	7459	7459KIT						
EX2SAT	7409	7409KIT	7448	7448KIT				

## TX Series

Model	Speakers	Recone Kit	Horn Driver	Diaphragm	Tweeter	Bulb		
						YS #	Mfg. #	Rating
TX4	15/138Y8M	15/138Y8MKIT	DE750Y	DE-75KIT				
TX8	LF: 15/139Y8M x2, MF: HM210Z8	15/139Y8MKIT HM210Z8KIT	DE750Y	DE-75KIT				
TX9S current	7459x2	7459KIT						
TX9S (before Sept/2001)	L18P300x2	18P300R						

## NX Series

Model	Speakers	Recone Kit	Horn Driver	Diaphragm	Tweeter	Bulb		
						YS #	Mfg. #	Rating
NX25P	7295		7448	7448KIT		N/A	N/A	N/A
NX55P	7455		7461	7461KIT		3644	1156	12V, 24W
NX200S	7266							
NX300	7295	N/A	7461	7461KIT				
NX600	7455		7393	7393KIT				
NX750P	7410	7410KIT	7393	7393KIT				

## Yorkville Speaker Component Chart

### Adrenalin Series

Model	Speakers	Recone Kit	Horn Driver	Diaphragm	Tweeter	Bulb		
						YS #	Mfg. #	Rating
A15	7451		7450			3644	1156	12V, 24W
A215S	7449x2							

### YX Series

Model	Speakers	Recone Kit	Horn Driver	Diaphragm	Tweeter	Bulb		
						YS #	Mfg. #	Rating
YX10	SPK1000		DVR1001					
YX12	SPK1001		DVR1001					
YX15	SPK7457		DVR1001					
YX215	SPK7457		DVR1001					
YX18S	SPK1003							
YX15P	SPK1004		DVR1001					

### Coliseum Series

Model	Speakers	Recone Kit	Horn Driver	Diaphragm	Tweeter	Bulb		
						YS #	Mfg. #	Rating
CM1260	7317		HD120	HD120KIT		3647	1141	12V, 18W
C2560	7309		7272	7272KIT		3644	1156	12V, 24W
C2890	7330x2		DE-10	DE-10KIT		3647	1141	12V, 18W
C2890 (June/Sept 2006)*	7328x2		DE-10	DE-10KIT		3647	1141	12V, 18W
C2285	7282		DE-10	DE-10KIT				

\* when ordering speaker replacements for May 2006 production, please specify which speaker part number and impedance you need



**Traynor / Yorkville BackLine Speaker Component Chart****Traynor Backline**

Model	Speakers	Recone Kit	Horn Driver	Diaphragm	Tweeter	YS #	Mfg. #	Rating	Bulb
AM50T	7331				7417				
AM100T	SPK7470x2				7435				
AM150T	SPK7394x2		7395	7395KIT	7417				
K2	7462				7286				
K2 (after 07/2008)	7481				7286				
K4	woofer=7388, mid=7405x2				7286x2				
DB200	7347				7417				
DB200T	7284x2				7417				
DB400	7336				7435				
DB400T	7478x2				7435				
YCV20	7079								
YCV40	7080								
YCV40T	TUBE10 x 2								
YCV50BLUE	7081								
YCV80	7080 x 2								
YCV80Q	TUBE10 x 4								
YCX12	7080								
YCX212	7080x2								
YCX12WR/YCX12BLUE	7081								
YCS412 (A, B, A2 & B2)	7082x4								
YCS412V (A & B)	7084x4								
YBX1510	7406x2 + 7336		HD120	HD120KIT		3644	1156	12V 24W	
YCS50	7081								
YCS90	7083								

# Yorkville Older Speaker Component Chart

## Acoustic Master

Model	Speakers	Recone Kit	Horn Driver	Diaphragm	Tweeter	YS #	Bulb	
							Mfg. #	Rating
AM50	7331				7417			
AM100	SPK7470x2				7435			
AM150	SPK7394x2		7395	7395KIT	7417			

## Bass Master

Model	Speakers	Recone Kit	Horn Driver	Diaphragm	Tweeter	YS #	Bulb	
							Mfg. #	Rating
BM50 / XM50	7337							
BM100 / XM100	7347							
BM200 / XM200	7347				7417			
BM200T / XM200T	7284x2				7417			
BM400	7333				7417			
BC115	7333							
BC115X / XC115X	7333							
BC210	7281x2				7414			
BC410	7284x4		N252XN	M-73		3644	1156	12V,24W

## BLOC Series

Model	Speakers	Recone Kit	Horn Driver	Diaphragm	Tweeter	YS #	Bulb	
							Mfg. #	Rating
BLOC-20G	7322							
BLOC-50G	7323 (sub 7322)							
BLOC-100G	7321 (sub 7288)							
BLOC-100GT	7318 x2 (sub 7278)							
ROCKBLOC-D	7350 (sub 12PE31E8R)							
BLOC-40B	7322							
BLOC-80B	7320 (sub 7347)							
BLOC-150B	7352 (sub 7347)							
BLOC-250B	7344 (sub 7335)							
BLOC-115B	7344 (sub 7335)							
BLOC-40K	7322		7415	7434				
BLOC-40W	7322		7413					
BLOC-80W	7299		7413					
BLOC-100K	7319		7414	7434				

## BW Series

Model	Speakers	Recone Kit	Horn Driver	Diaphragm	Tweeter	YS #	Bulb	
							Mfg. #	Rating
BW-1	7365 (sub 7308)		TW-101	M-15				
BW-2	7431 (sub 7311)		TW-50	M-15				
BW-3	7385x4 (sub T-10BSPKR)		TW-105	M-16				
BW-4	7385x2 (sub T-10BSPKR)		TW-105	M-16				
BW-23	7365 (sub 7308)		TW-101	M-15	7428x3			

## Coliseum Series

Model	Speakers	Recone Kit	Horn Driver	Diaphragm	Tweeter	YS #	Bulb	
							Mfg. #	Rating
C860 pre-2002/post-2002	7332		N252XN/DE-10	M-73/DE-10KIT		3647	1141	12V,18W
C1200	7317				7411	N/A	N/A	N/A
C1260/C1290 pre-2002/post-2002	7279		N252XN/HD120	M-73/HD120KIT		3647	1141	12V,18W
C1560	7311		HD120	HD120KIT		3647	1141	12V,18W
C2260	7282		HD120	HD120KIT		3647	1141	12V,18W
C2290 pre-2002/post-2002	7282		N252/HD120	M-73/HD120KIT		3647	1141	12V,18W

## CS Series

Model	Speakers	Recone Kit	Horn Driver	Diaphragm	Tweeter	YS #	Bulb	
							Mfg. #	Rating
CS-4T			7428 x4					
CS-110T/MS-110T	Not available		7428					
CS-112H	7317		7306	7434				
CS-210H	Not available		7306	7434				
CS-1012H	Not available		7306	7434				
CS-105H	7311		7306	7434				
CS-120H	12PE31E8R		7306	7434		3647	1141	12V,20W
CS-115H	7308		7306	7434		3647	1141	12V,20W
CS-212H	Not available		7306	7434		3647	1141	12V,20W
CS-150H	L15/554		7421	7419		3644	1156	12V,24W
MS-112H	7294		7306	7434				
MS-115H	7311		7306	7434				

# Yorkville Older Speaker Component Chart

## élite Series

Model	Speakers	Recone Kit	Horn Driver	Diaphragm	Tweeter	YS #	Bulb	
							Mfg. #	Rating
E600/EM600	L10/750x2	10/750R	N481YK	M-65		3652x2	P45T	24V,55/50W
E168/EF168	L10/581 (sub 1	10/581R	N252XN	M-73		3643	93	12V,36W
EM168	L10/581 (sub 1	10/581R	N255	M-73		3643	93	12V,15W
E354/EF354	12PE31E4R	12PE31E4RKIT	D-24	D-24KIT		3652	P45T	24V,55/50W
E358/EF358/EM358	12PE31E8R	12PE31E8RKIT	D-24	D-24KIT		3652	P45T	24V,55/50W
E404/EF404	L15K81Y	15K81R	D-24	D-24KIT		3652	P45T	24V,55/50W
E408/EF408	L15K80Y	15K80R	D-24	D-24KIT		3652	P45T	24V,55/50W
EM408	15PL408R	15PL408RKIT	D-24	D-24KIT		3652	P45T	24V,55/50W
EF508	15/138Y8M	15/138Y8MKIT	7401	7401KIT		3652	P45T	24V,55/50W
EM508	15PE408R	15PE408RKIT	7401	7401KIT		3652	P45T	24V,55/50W
E604/EF604	L10/750x2	10/750R	D-24	D-24KIT		3652	P45T	24V,55/50W
E1004/EF1004	15PE408Rx2	15PE408RKIT	DE-45	DE-45KIT	7417x2	3652	P45T	24V,55/50W
E2004/EF2004	L15K80Yx2	15K80R	DE-75	7401KIT	D-32(KIT)	3652x2	P45T	24V,55/50W
E2104	L15K80Yx2	15K80R	7403	7401KIT		N/A	N/A	N/A
E2204	L15K80Yx2	15K80R	DE-75 / 750Y	7401KIT		N/A	N/A	N/A
LS908	18/029Y4M	18/029Y4MKIT						
LS1004	7458 x 2	7458KIT						
L368	LF - 12HPL64-8		HD120	HD120KIT		3651	1195	12V, 36W
	MF - 7289							
L418	LF - 152198R		DE600			3651	1195	12V, 36W
	MF - 7291							
L704	LF - 12HPL64-8 x 2		DE600			3651	1195	12V, 36W
	MF - 7289 x 2							
L804	LF - 152198R x 2		DE600			3651	1195	12V, 36W
	MF - 7289 x 2							
ES700P	7269 x 2							
M-160 early version	L10/580	10/581R	N252	M-73		3643	93	12V / 15W
	(sub 10MB400)							
M-160/M-160M	L10/581	10/581R	N252	M-73		3643	93	12V / 15W
	(sub 10MB400)							
EX-161	L10/581	10/581R	N252 Special	M-73		3643	93	12V / 15W
	(sub 10MB400)							
EX-161M	L10/581	10/581R	N255	M-73		3643	93	12V / 15W
	(sub 10MB400)							
EX-250	7384 (sub L10/750)		DE-15	DE-15KIT		3644	1156	12V / 24W
EX-350	12PE31E4R	12PE31E4RKIT	D-24	D-24KIT		3644	1156	12V / 24W
EX-350/8	12PE31E8R	12PE31E8RKIT	D-24	D-24KIT		3644	1156	12V / 24W
EX-350M/EX351M	12PE31E8R	12PE31E8RKIT	D-24	D-24KIT		3644 x2	1156	12V / 24W
ES2000B (sub)	18/063Y8M	18/063Y8MKIT						
ES2000B (mid/high cab)	7409		HD120	HD120KIT		3647	1141	12V 18W
M-400	L10/500x2	10/500R	7424	7425				
M-600	L10/750x2	10/750R	N481YK	M-65		3651x2	1195	12V,36W
S-400	L15/541	15/541R	7424	7425		2450	1.5A FUSE	
	7423	7420						
MX-401	L15K81Y	15K81R	7421	7419		3644 x2	1156	12V,24W
MX-401M	L15K80Y	15K80R	7421	7419		3644x2	1156	12V,24W
EX-401	L15K81Y	15K81R	D-24	D-24KIT		3644 x2	1156	12V, 24W
EX-401M	L15K80Y	15K80R	N481K	M-65		3651 x2	1195	12V,36W
EX-601	L10/750x2	10/750R	D-24	D-24KIT		3652	P45T	24V, 50/55W
MX-1000	L15K80Yx2	15K80R	N481K	M-65		3646	H4	12V,60W
MX-1000 pre-1/91	L15K80Yx2	15K80R	N481K	M-65	7417 x2	3646	H4	12V,60W
MX-1000 earliest version	7305x2 (sub L15K80Y)		N481K	M-65		3646	H4	12V,60W
EX-1000	15PE408Rx2	15PE408RKIT	DE-45	DE-45KIT	7417	3644	1156	12V, 24W
MX-2000	L15K80Yx2	15K80R	7433 + 7430	7412 + 7425	H6040	2x3652	P45T	24V,50/55W
EX-2000	L15K80Yx2	15K80R	DE-75	7401KIT		3652 x2	P45T	24V, 50/55W
SW-600 pre-6/91	L18/851	18/851R						
SW-600 pre-11/95	L18/751	18/751R						
SW-600 final	L18P540	18P540R						
SW-800 pre-6/97	L18/851	18/851R						
SW-800 final	L18Y800	18Y800R						
SW-900	RX-18	RX-18KIT						

# Yorkville Older Speaker Component Chart

## élite Series

Model	Speakers	Recone Kit	Horn Driver	Diaphragm	Tweeter	YS #	Bulb	
							Mfg. #	Rating
SW-900R pre-6/97	L18/851	18/851R						
SW-900R final	L18Y800	18Y800R						
SW-1000 pre-6/97	L18/851x2	18/851R						
SW-1000 final	L18Y800x2	18Y800R						
EPW	7269x2							
ES608	L18P540	18P540R						
ES808	L18Y800	18Y800R						
ES908	L18Y800	18Y800R						
ES1004	L18Y800x2	18Y800R						

## G Series (cabs)

Model	Speakers	Recone Kit	Horn Driver	Diaphragm	Tweeter	YS #	Bulb	
							Mfg. #	Rating
G1-212	7355x2 (sub 7317 or 7294)							
G1-215	7370x2 (sub 7319)							
G2-312	7369x3 (sub 7317 or 7294)							
G2-150	7387x2 (sub 7319)							
G3-412	7386x4 (sub G12M70P16)							
G1SC (combo)	7382x2 (sub 7317 or 7294)							

## ICS Crossovers

Model	Speakers	Recone Kit	Horn Driver	Diaphragm	Tweeter	YS #	Bulb	
							Mfg. #	Rating
ICS-2WX						3647	1141	12V,20W
ICS-3WX						3644	1156	12V,24W

## IS Series

Model	Speakers	Recone Kit	Horn Driver	Diaphragm	Tweeter	YS #	Bulb	
							Mfg. #	Rating
IS-112F/WHTF	7317				7411			
IS-115F/WHTF	7311		N252XN	M-73		3647	1141	12V,18W
IS-112	7317		7428					
IS-115	7311		7416	7434				
IS-112F/IS-112WHTF	7317				7411			
IS-115F/IS-115WHTF	7311		N252XN	M-73				

## K & KW Series

Model	Speakers	Recone Kit	Horn Driver	Diaphragm	Tweeter	YS #	Bulb	
							Mfg. #	Rating
50K & KB / 50W & KW	7322		7415					
100K & KB / 100W & KW	7288		N252XN	M-73				
200K / 200KB	7352		N252XN	M-73				

## Mono Block cabs

Model	Speakers	Recone Kit	Horn Driver	Diaphragm	Tweeter	YS #	Bulb	
							Mfg. #	Rating
1150	7307 (sub 7308)							
2150	7365x2 (sub 7308)							

Also see YC-188, YCV-215, YCV-18 & YCV-18B Mono Block cabs under "Y Series"

## NX Series

Model	Speakers	Recone Kit	Horn Driver	Diaphragm	Tweeter	YS #	Bulb	
							Mfg. #	Rating
NX12	7279		HD120	HD120KIT		3647	1141	12V,18W
NX20	12HPL64-8	12HPL64-8KIT	HD120	HD120KIT		3647	1141	12V,18W
NX25	7456		7393	7393KIT		N/A	N/A	N/A
NX520P	12/150Y4M	12/150Y4MKIT	HD120	HD120KIT		N/A	N/A	N/A
NX250/P	7279 or 7285		HD120	HD120KIT				
NX350	12HPL64-8	12HPL648RKIT	HD120	HD120KIT				
NX550P	12/150Y4M	12/150Y4MKIT	HD120	HD120KIT				
NX84	7328		DE-10	DE-10KIT		3647	1141	12V 18W
NX88	7329		DE-10	DE-10KIT		3647	1141	12V 18W

## Yorkville Older Speaker Component Chart

### Performance Series

Model	Speakers	Recone Kit	Horn Driver	Diaphragm	Tweeter	YS #	Bulb	
							Mfg. #	Rating
*YS-110 / YS-110M pre-4/92	7318				7428			
*YS-112 pre-4/92	7317				7428x2			
YS-110 / YS-110M*	7318		7411					
YS-112*	7317		7411					
YS-112M	7317		7416	7434		3644	1156	12V, 24W
YS-115 / YS-115M	7311		7416	7434		3647	1141	12V,18W
YS-153	7355		N252 Special	M-73	7417	3652	P45T	24V,50/55W
YS-253	7311x2		N252XN	M-73	7417	3652	P45T	24V,50/55W
YS-118PW	7268							
Y110/Y110M	7318		7411					
Y112	7317		7411					
Y112M	7317		HD120	HD120KIT		3644	1156	12V, 24W
Y115/YF115/ Y115M	7311		HD120	HD120KIT		3647	1141	12V,18W
Y115P	7316		N252XN/DE-10	M-73/DE-10KIT	7417			
Y150/YF150/Y150M	7309		7272	7272KIT	7417	3644	1156	12V,24W
Y253	7311x2		HD120	HD120KIT	7417	3652	P45T	24V,50/55W
Y118S	7277							
Y118PW	7268							

### Pulse Series

Model	Speakers	Recone Kit	Horn Driver	Diaphragm	Tweeter	YS #	Bulb	
							Mfg. #	Rating
P-8	7332		N252XN	M-73		3647	1141	12V,18W
P-10 / P-10M	7278		N252XN	M-73		3647	1141	12V,18W
P-12 / P-12M	7279		N252XN	M-73		3647	1141	12V,18W
P-15	7311		N252XN	M-73		3647	1141	12V,18W
P-153	7308		7283	7283KIT	7417	3644	1156	12V,24W
P-253	7308 x2		7272	7272KIT	7417	3652	P45T	24V,50/55W
P-283	7345 x2		7283	7283KIT	7417	3644	1156	12V,24W
PPW	7273							
HP-150	7308		7283	7283KIT		3644	1156	12V,24W
P-15W	7335							
P-18W	7276							
PS218P	7267 x2							
PPW	7273 x2							
TL8	7332		DE-10	DE-10KIT		3647	1141	12V,18W
TL10	7278		DE-10	DE-10KIT		3647	1141	12V,18W
TL12 / TM12	7285		DE-10	DE-10KIT		3647	1141	12V,18W
TL315	7443		7283	7283KIT	7417	N/A	N/A	N/A
TL3215	7308 x2		7272	7272KIT	7417 x2	N/A	N/A	N/A
TR315	7442		DE-10	DE-10KIT	7417	3652	P45T	24V, 50/55W
TL352/TM352	7445		DE600	DE600KIT	7417	N/A	N/A	N/A
TL3215	7308x2		7272	7272KIT	7417 x2	N/A	N/A	N/A
TL3252	7443x2		DE-72P	DE-75KIT	N/A	N/A	N/A	N/A
TS18	7276	7276KIT						
TS18H	PS46Y8M	PS46Y8MKIT						
PL8	7332		HD120	HD120KIT		3647	1141	12V,18W
PL10 / PM10	7278		N252 Special	M-73		3647	1141	12V,18W
PL12 / PM12	7279		N252 Special	M-73		3647	1141	12V,18W
PL315	7443		7283	7283KIT	7417	3644	1156	12V,24W
PL315/4	7444		7283	7283KIT	7417	3644	1156	12V,24W
PL3215	7308 x2	7314	7272	7272KIT	7417 x2	3652	P45T	24V, 50/55W
PR315	7442		N252 Special	M-73	7417	3652	P45T	24V, 50/55W
PR418	LF: 7263, MF: 7264		N252	M-73	CP16	3647	1141	12V,18W
PS18	7276							
PS110P	7266							
PS210PX	7265 x2							
PS218P	7267 x2							

### RVS Series (combos)

Model	Speakers	Recone Kit	Horn Driver	Diaphragm	Tweeter	YS #	Bulb	
							Mfg. #	Rating
RVS-1 (and RVS-1ES ext. cab)	7369x2 (sub 7317 or 7294)							
RVS-III	L15P02 (N/A, no sub)							

## Yorkville Older Speaker Component Chart

### RW Series

Model	Speakers	Recone Kit	Horn Driver	Diaphragm	Tweeter	YS #	Bulb	
							Mfg. #	Rating
RW-112	7317		7428					
RW-115	7311		7416	7434				

**Sound Crew Series**

Model	Speakers	Recone Kit	Horn Driver	Diaphragm	Tweeter	YS #	Bulb Mfg. #	Rating
4530R	L15P06 (sub L15K80Y)	15P06R						
4560R	L15P06 (sub L15K80Y)	15P06R						
4812R	L12P11W	12P11R	7306	7434				
4823R			TW-101 (N/A)	M-15	4x7414			
the FILL	L15/554	15/554R	EC175(sub D24)					
the WEDGE	L15/554	15/554R	EC175(sub D24)					
the BASS	L15P06 (sub L15K80Y)	15P06R						
the MID	L12P11W	12P11R						
HORN 1			EC175(sub D24)					
HORN 2			EC320(sub DE75)					

**Stage Series**

Model	Speakers	Recone Kit	Horn Driver	Diaphragm	Tweeter	YS #	Bulb Mfg. #	Rating
S-100G	G12M70P4							
S-150G	G12M70P8 x2							
S-212G	G12M70P4 x2							
S-412G	G12M70P8 x4							
S-120B	7320							
S-120BX	7320							
S-200B	7347							
S-400B	7333							
S-410B	7274 x2, 7275 x2							
S-115B	7333							
S-100K	7299		7413					

**TS Series**

Model	Speakers	Recone Kit	Horn Driver	Diaphragm	Tweeter	YS #	Bulb Mfg. #	Rating
TS-10	7340 (N/A, no sub)							
TS-15	7340 (N/A, no sub)							
TS-20	???? (sub 7322)							
TS-25	7303 (sub 7317 or 7294)							
TS-25B	7370 (sub 7319)							
TS-50	7369 (sub 7294)							
TS-115 (cab for TS-50B head)	7431 (sub 7333)							
TS-60B	7431 (sub 7333)							
TS-75	L15P02 (N/A, no sub)							
TS-75ES	L15P02 (N/A, no sub)							
TS-100	7369x2 (sub 7294)							
TS-120B	7308							
TS-120BES	7308							
TS-140	7357x2 (N/A, no sub)							
TS-200 (head w/practice spkr)	???? 6-inch 8R (N/A, no sub)							
TS-98 (cab for TS-200 head)	???? (sub T-10BSPKR)							

**TX Series**

Model	Speakers	Recone Kit	Horn Driver	Diaphragm	Tweeter	YS #	Bulb Mfg. #	Rating
TX8S	L18Y800 x2	18Y800R						
TX2M	12/059Y8M	12/059Y8MKIT	DE750Y	DE-75KIT				
TX5M	15/138Y8M	15/138Y8MKIT	DE750Y	DE-75KIT				
TX3	12/059Y8M	12/059Y8MKIT	DE750Y	DE-75KIT				

**Yorkville Older Speaker Component Chart****XM / XS Series**

Model	Speakers	Recone Kit	Horn Driver	Diaphragm	Tweeter	YS #	Bulb Mfg. #	Rating
XM50/50C	7337							
XM100/100C	7347							
XM200/200C	7347				7417			
XS400/400C	7336				7418			
XC115	7333		HD120	HD120KIT				
XC210	7281x2		HD120	HD120KIT				
XC410	7284x4		HD120	HD120KIT				
XC115	7333							
XC115X	7333							

<i>Y Series (combos)</i>								Bulb
Model	Speakers	Recone Kit	Horn Driver	Diaphragm	Tweeter	YS #	Mfg. #	Rating
YBA-2/2B (Bass Master)	7370 (sub 7319)							
YBA-4 (Bass Master)	7431 (sub 7333)							
YBA-5 (Mark II)	7397 (sub 7333)							
YGA-1 (Signature Amp)	???? (sub 7319)							
YGM-1/2/3 (Guitar Mate)	7372 (sub 7317 or 7294)							
YSR-2 (Signature Reverb)	????x4 (sub 7275)							
YB-18	???? (sub 7276)							
YB-18A	???? (sub 7276)							
YC-188	7395 (sub L18Y800)							
YC-610	7363x6 (sub 7275)							
YC-810	7363x8 (sub 7275)							
YCV-212	7396x2 (N/A, no sub (16R))							
YCV-215	7397x2 (sub 7333)							
YCV-18	7395 (sub L18Y800)							

<i>Y Series (combos)</i>								Bulb
Model	Speakers	Recone Kit	Horn Driver	Diaphragm	Tweeter	YS #	Mfg. #	Rating
YCV-18B	7395 (sub L18Y800)							
YF-10	7363 x4 (sub 7275)							
YF-12	7386x4 (sub G12M70P16)							
YGC-412	?x2+?x2 (sub 7317 or 7294)							
YN-412	7367x4 (*N/A, no sub)							
YR-412	????x4 (sub 7294)							
YS-15	7370 (sub 7319)							
YSC-4A	7362x4 (sub 7317 or 7294)							
YT-12	7367x2 (*N/A, no sub)							
YT-15	7370x2 (sub 7319)							

\* The 7367 (Phillips "Norelco") had a very distinctive sound., however another 12 inch 25-100W, 8 ohm speaker, e.g. the 7317 or 7294, will work.

<i>YCS Series</i>								Bulb
Model	Speakers	Recone Kit	Horn Driver	Diaphragm	Tweeter	YS #	Mfg. #	Rating
YCS412	7082x4							
YCS412V	7084x4							

<i>YSC Series</i>								Bulb
Model	Speakers	Recone Kit	Horn Driver	Diaphragm	Tweeter	YS #	Mfg. #	Rating
YSC-1	7385x6 (sub T-10BSPKR)							
YSC-2	7362x4 (sub 7317)							
YSC-3	7385x4 (sub T-10BSPKR)							
YSC-4	7362x4 (sub 7317)							
YSC-5	Lansing D-120 (sub N/A)							
YSC-6	7367 (*sub N/A)							
YSC-7	7367x2+ ??x2 (sub 7294)							
YSC-7A	7385x2+7394x2 (see YSC1)				7413x2			
YSC-8	7385x4+7384x2 (see YSC1)							
YSC-9	7402+7403 (sub 7311/7279)		TW-100	M-15				
YSC-10	7365 (sub 7308)		TW-101	M-15	7413x2			
YSP-1					7413x5			
TRIJECTOR	7334 (sub 7335)		N480	M-65 (sub 7335)	7428x2			
EXTENDER	7335							

<i>Yorkville Series</i>								Bulb
Model	Speakers	Recone Kit	Horn Driver	Diaphragm	Tweeter	YS #	Mfg. #	Rating
50B	7337							
100B	7347							
200B	7347							
400B	7333							
210B	7281 x2		7414	7434				
410B	7284 x4		N252XN	M-73				
115B	7333							
115BX	7333							
BC115	7333							
BC210	7281 x2		7414	7434				
300K	7338x2		N252XNx2	M-73				



**WEB:** [www.yorkville.com](http://www.yorkville.com)

**WORLD HEADQUARTERS  
CANADA**

**Yorkville Sound**  
550 Granite Court  
Pickering, Ontario  
L1W-3Y8 CANADA

Voice: (905) 837-8481  
Fax: (905) 837-8746

**U.S.A.**

**Yorkville Sound Inc.**  
4625 Witmer Industrial Estate  
Niagara Falls, New York  
14305 USA

Voice: (716) 297-2920  
Fax: (716) 297-3689



**Quality and Innovation Since 1963**  
Printed in Canada