

OVERHAUL PROPELLER SHAFTS

Dismantle

1. Place the vehicle on a suitable ramp.
2. Remove the propeller shaft from the vehicle.
3. Note the alignment markings on the sliding member and the propeller shaft.

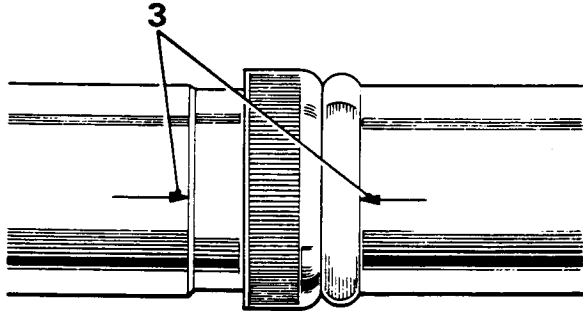

ST1000M

4. Unscrew the dust cap and withdraw the sliding member.

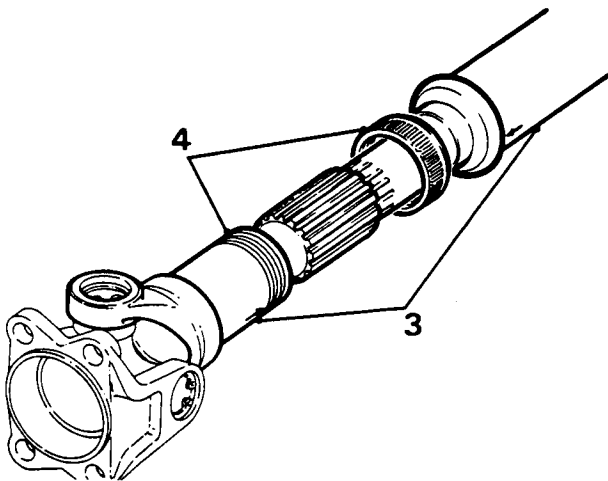

RR1515M

5. Clean and examine the splines for wear. Worn splines or excessive back-lash will necessitate propeller shaft renewal.

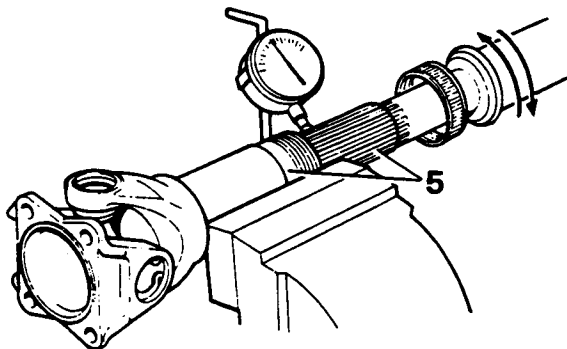

ST1002M

6. Remove paint, rust, etc. from the vicinity of the universal joint bearing cups and circlips.

NOTE: Before dismantling the propeller shaft joint, mark the position of the spider pin lubricator relative to the journal yoke ears to ensure that the grease nipple boss is re-assembled in the correct running position to reduce the possibility of imbalance.

7. Remove the circlips, and grease nipple.

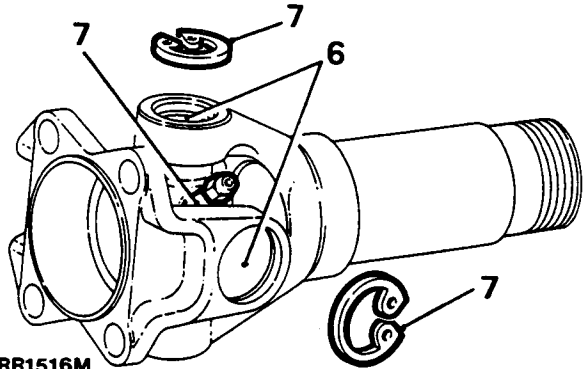

RR1516M

8. Tap the yokes to eject the bearing cups.
9. Withdraw the bearing cups and spider and discard.
10. Repeat instructions 5 to 8 at opposite end of propeller shaft.
11. Thoroughly clean the yokes and bearing cup locations.

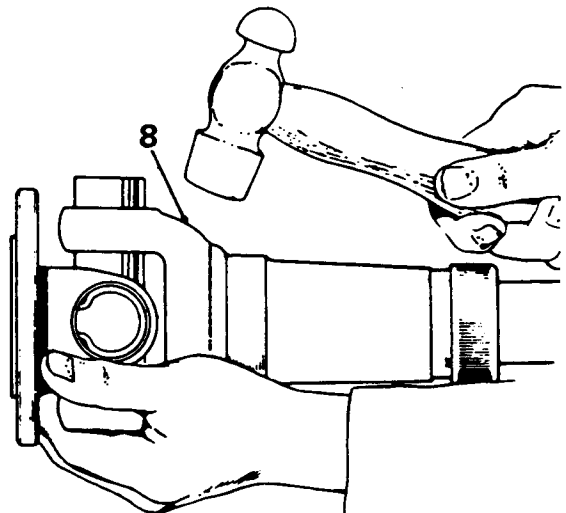

ST1004M

Assemble

12. Remove the bearing cups from the new spider.
13. Check that all needle rollers are present and are properly positioned in the bearing cups.
14. Ensure bearing cups are one-third full of fresh lubricant. See Lubrication chart.
15. Enter the new spider complete with seals into the yokes of the sliding member flange.

Continued

16. Partially insert one bearing cup into a flange yoke and enter the spider trunnion into the bearing cup taking care not to dislodge the needle rollers.
17. Insert the opposite bearing cup into the flange yoke. Using a vice, carefully press both cups into place taking care to engage the spider trunnion without dislodging the needle rollers.
18. Remove the flange and spider from the vice.
19. Using a flat faced adaptor of slightly smaller diameter than the bearing cups press each cup into its respective yoke until they reach the lower land of the circlip grooves. Do not press the bearing cups below this point or damage may be caused to the cups and seals.

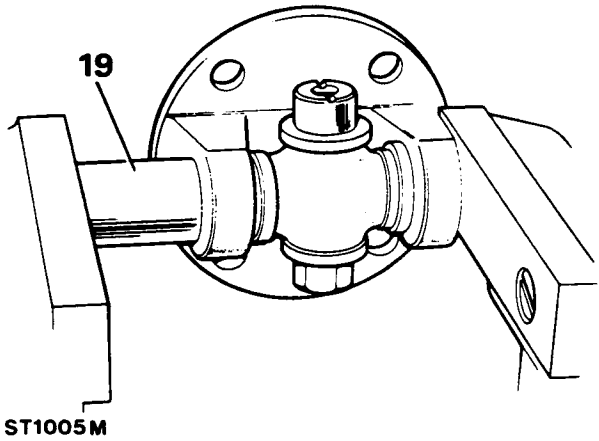

20. Fit the circlips.
21. Engage the spider in the yokes of the sliding member. Fit the bearing cups and circlips as described in instructions 15 to 20.

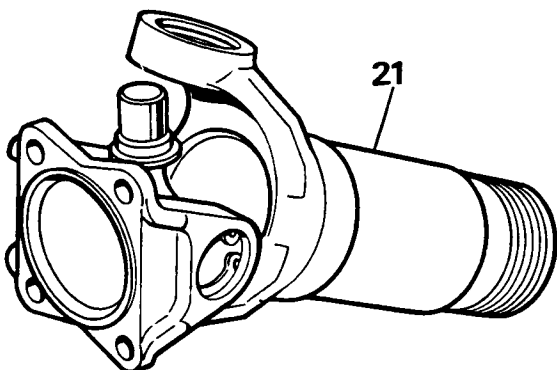

ST1006M

22. Lubricate the sliding member spines and fit the sliding member to the propeller shaft ensuring that the markings on both the sliding member and propeller shaft align.
23. Fit the tighten the dust cap.
24. Fit the grease nipples to the spider and the sliding member and lubricate.
25. Apply instructions 15 to 20 to the opposite end of the propeller shaft.
26. Fit the grease nipple and lubricate.
27. Fit the propeller shaft to the vehicle.

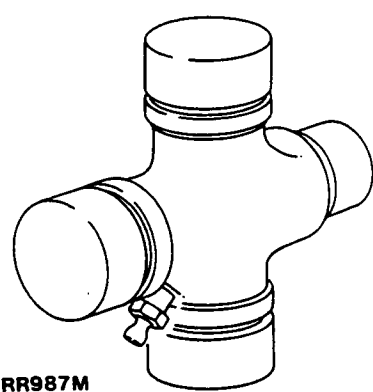

RR987M

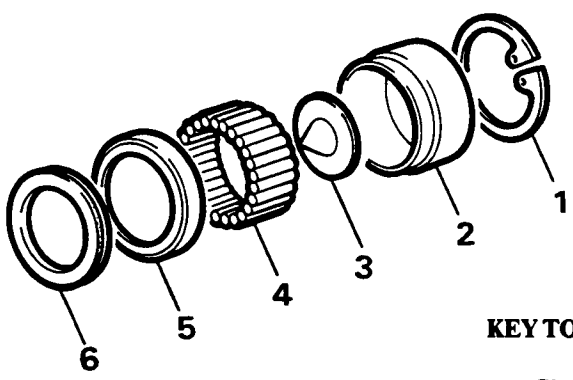

KEY TO SPIDER ASSEMBLY

1. Circlip
2. Bearing cup
3. Nylatron washer
4. Needle rollers (27 per cup)
5. Seal retainer
6. Seal

NOTE: When renewing joints use only 03EHD series replacement spider packs.