

CIRCULATE TO:-	
SERVICE MGR.	X
RECEPTION	X
WORKSHOP	X
PARTS	X

TECHNICAL INFORMATION RECALL ACTION



MODEL		SUBJECT		01/12/96
Discovery - All derivatives		Front Right Hand Door Latch Loads - Inconsistent		A/B/D 456
Discovery - All derivatives		AFFECTED VEHICLES		
Discovery - All derivatives		LJ	156137 to 200000	
		LJ	500032 to 537985	
		LJ	700000 to 707210	

DETAIL

To overcome inconsistent front right hand door latch operating loads which could be identified as 'bounce' when the door is closed and to prevent any further customer annoyance Land Rover are implementing a campaign to check the operation of the door latch. The result of this check will introduce a new extended length screw fitted to the upper exterior latch fixing, and in extreme cases the fitment of a new latch. Investigations by Land Rover Engineers have found that due to a tolerance build up during vehicle manufacture the outer frame leg may contact the upper corner of the latch in the interior of the door. The fitment of the extended length screw eliminates this contact and reduces the latch operating load. The procedure below should be followed carefully to determine the level of fix applied to a vehicle that exhibits this concern.

ACTION REQUIRED

At the first opportunity either, Pre-delivery Inspection, warranty remedial work, service interval inspect all vehicles. Vehicles that are currently held in your sales compounds, showroom, used vehicles on forecourts and demonstrators should all be inspected prior to customer despatch.

PARTS INFORMATION

STC 3763 Latch upper fixing 1 off
MTC 7593 Front right hand latch 1 off
MUC 1822 Latch gasket 1 off
AFU 1069 Washer 2 off

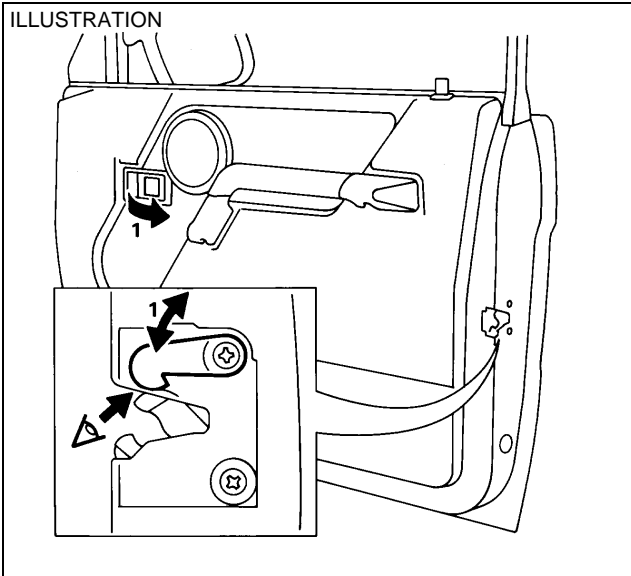

PROCEDURE

Initial Inspection Checks

1. With the door open and unlocked, slowly pull the exterior release handle until it is fully extended through its travel, very slowly allow the handle to return to its rest position. During this operation check that the 'pawl' which holds the plastic coated striker claw does not stick in its uppermost position in the latch and that the movement of the 'pawl' is unrestricted. Some restriction/roughness may be felt if the latch load is restricted during the handle movement.
2. Repeat this operation with the interior release handle.
3. Repeat checks 1 & 2 with the window lowered to its full extent.

Continued.....

WARRANTY
A = UK B = USA/Canada
D = Europe/Rest of World

COMP. CODE
A/B/D 456

SRO
UK Only
Option code A - Inspect and fit new fixing 00.10 hour
Option code B - Inspect, fit new latch and fixing 01.75 hour

USA/Canada/Europe and rest of World
76.37.89/26 Inspect and fit new fixing 00.10 hour
76.37.12/03 Inspect, fit new latch and fixing 01.75 hour

TECHNICAL INFORMATION RECALL ACTION



Page 2 of 3	SUBJECT Front Right Hand Door Latch Loads - Inconsistent	01/12/96 A/B/D 456
MODEL Discovery - All derivatives Discovery - All derivatives Discovery - All derivatives	AFFECTED VEHICLES LJ 156137 to 200000 LJ 500032 to 537985 LJ 700000 to 707210	

4. If no restriction is felt and the pawl moves freely in the latch fit **new** screw STC 3763 and washer AFU 1069 to the upper latch fixing on the door shut face, tighten to 4 Nm.

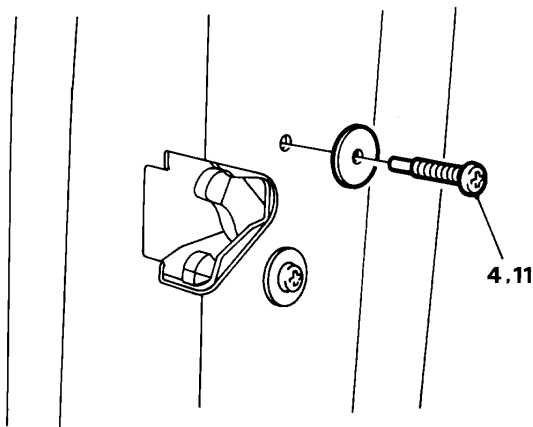

5. If during the check it is found that resistance is felt, again with the door unlocked, open the door very slowly with the exterior release handle and release the handle slowly to its rest position then close the door. Repeat this operation six times and check that the door does not bounce open clear of the striker on the 'B' post.
6. If the door exhibits a 'bounce condition' this is evidence of a latch load that is inconsistent and the latch will require replacement.

Latch Replacement

7. Carefully remove door trim pad.
8. Carefully lift water curtain to avoid damage in areas that will provide access to the interior of the door.
9. Remove glass frame and latch. Discard latch.
Note: In markets where there is no return procedure for warranty parts, displaced latches should be rendered inoperative but retained for 3 months for inspection.
10. Prior to fitting a new latch open out the latch fixing hole in the door panel to 12 mm diameter. Remove any sharp edges from around the hole.

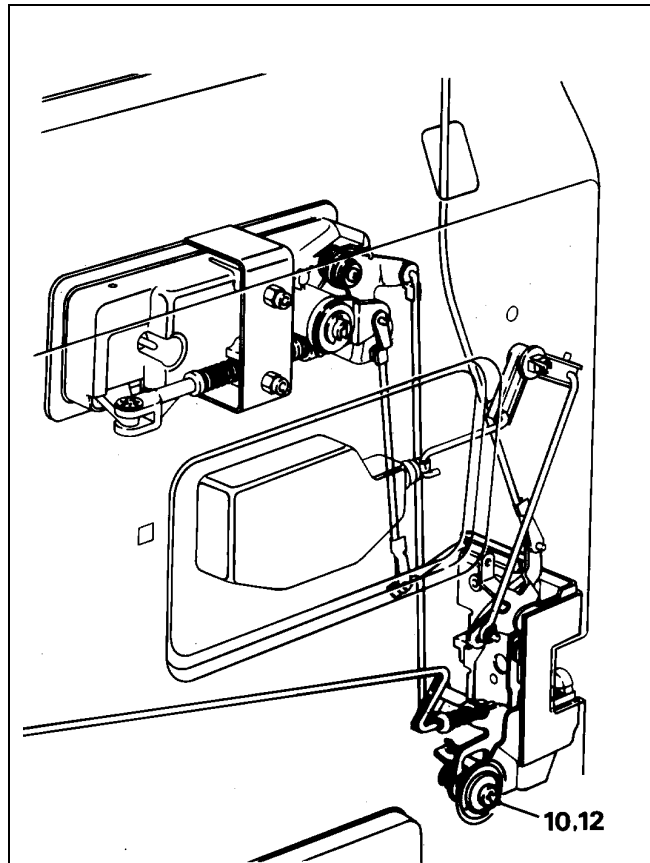

11. Fit a new latch, Part number MTC 7593 and gasket MUC 1822 to the door panel. The new extended length screw STC 3763 and washer AFU 1069 **MUST** be fitted to the upper latch fixing on the shut face of the door.
12. Prior to securing the latch to the inner door panel a new washer AFU 1069 must be used under the hexagon head screw.
13. Rebuild the door as described in section 76 of the workshop manual noting the following care points.
- When resetting the latch, check the setting of the central door locking actuator plate. This is critical to the sill button operation and the functional setting of the latch.
 - After the replacement of the glass frame and prior to refitting the door trim pad check the alignment of the glass frame to door aperture to ensure no water leaks or wind noise is evident.

TECHNICAL INFORMATION RECALL ACTION



Page 3 of 3	SUBJECT Front Right Hand Door Latch Loads - Inconsistent	01/12/96 A/B/D 456
MODEL Discovery - All derivatives Discovery - All derivatives Discovery - All derivatives	AFFECTED VEHICLES LJ 156137 to 200000 LJ 500032 to 537985 LJ 700000 to 707210	

14. Repeat the detail checks of the door latch operation to ensure that it is fully functional.
15. Carefully refit the water curtain ensuring that no gaps are evident that will permit water ingress.
16. **IMPORTANT:** Apply a small amount of yellow paint to the latch throat, (refer to illustration) on the shut face of the door to prevent this fix being completed unnecessarily by another dealer.

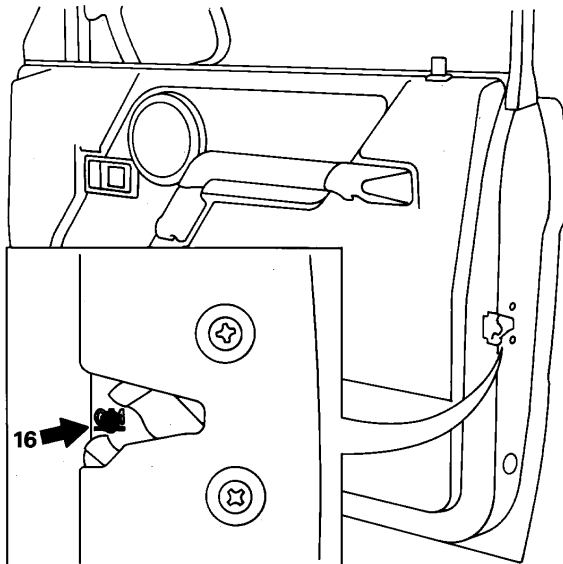

17. Whilst the vehicle is in the workshop check the functionality of the front left hand and both rear side doors. Refer to bulletins 76/21/96 and 76/22/96.