

TECHNICAL BULLETIN



MODEL/DERIVATIVE:

Range Rover
Discovery Series II
Defender

Bulletin N°: 0029
CDS. ref: L8623bu
Issue: 1
Date: 15.11.2000

AFFECTED RANGE:

All V8 derivatives with Bosch Engine Management System in VIN ranges:

Range Rover - XA 410483 to 1A 446786

Discovery Series II - Introduction of model to XA 907212 (System 1)

Discovery Series II - Introduction of model to 1A 296165 (System 2)

Defender - XA 159810 to YA 199999

Defender - YA 600000 to 1A 602857

PROBLEM:

ENGINE WILL NOT START / STARTS INTERMITTENTLY

The engine will not start due to the starter motor becoming inoperative.

CAUSE:

Poor electrical connection between the main battery lead and the starter motor solenoid.

ACTION:

At the final VINs above, the torque setting for the battery lead connection to the starter motor was increased from 10 Nm to 18 Nm.

Where a customer complaint as above is confirmed, secure the battery lead connection to the starter motor as follows:

1. Disconnect earth lead from battery.
2. Raise vehicle, (Discovery and Defender only).
3. Locate battery lead to starter motor solenoid connection, (arrowed in illustration).
4. Tighten solenoid nut to the new torque of 18 Nm.
5. Lower vehicle, (if necessary) and reconnect battery earth lead.

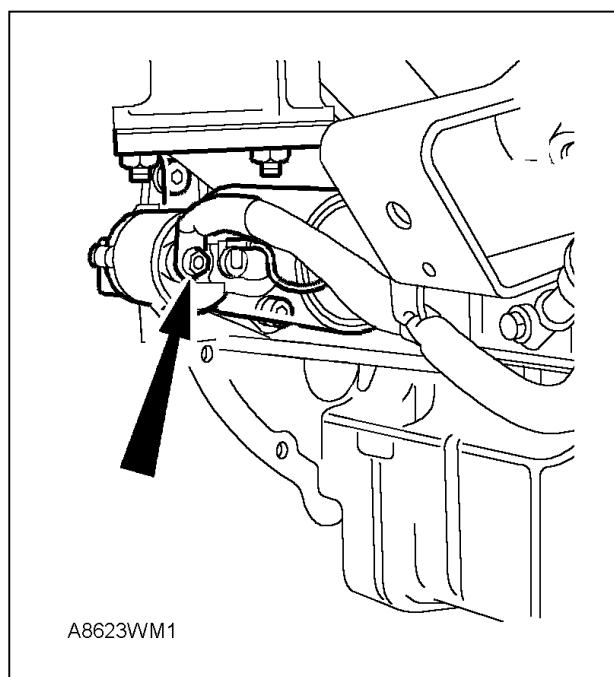

PARTS INFORMATION:

Not applicable

WARRANTY CLAIMS:

Use Complaint Code: 7C1L

Use S.R.O.: 86.60.89/27

Time allowance: Range Rover - 0.10Hrs

Discovery and Defender - 0.20Hrs