

# Locks & Alarm

---

## ALARM SYSTEM

Your vehicle is fitted with a sophisticated electronic anti-theft alarm and engine immobilisation system. There are also a number of additional security features, some of which are selectable options and some are standard features of the vehicle. In order to ensure maximum security and operating convenience, you are strongly advised to gain a full understanding of the features and alternatives available, by thoroughly reading this section of the handbook.

IMPORTANT INFORMATION
FOR MAXIMUM SECURITY ALWAYS SUPERLOCK THE VEHICLE USING THE REMOTE HANDSET (except when passengers are to be left inside or if it is necessary to leave a window or sunroof open).

## LOCKING

### *With the remote handset:*

Press the lock (padlock symbol) button once:

- all doors are superlocked (see 'Superlocking')
- engine immobilised
- perimeter alarm activated (protects the doors, bonnet and taildoor)
- interior space protection activated

The direction indicator lights flash three times to confirm that the vehicle is secure and the anti-theft alarm indicator light (in the instrument panel) starts to flash.

### *With the key:*

Insert the key and turn the door lock towards the rear of the vehicle:

- all doors locked (not superlocked)
- engine immobilised
- perimeter alarm activated (protects the doors, bonnet and taildoor)
- NO INTERIOR SPACE PROTECTION

The direction indicator lights flash once to confirm that the vehicle is secure and the anti-theft alarm indicator light (in the instrument panel) starts to flash.

## UNLOCKING

### *With the remote handset:*

- Press the unlock (Land Rover) button once to disarm the alarm and unlock the driver's door only (see 'Single point entry').
- Press the unlock button twice to disarm the alarm and unlock ALL the doors.

In either case, the direction indicator lights flash once and the interior lights illuminate.

### *With the key:*

While the doors can be unlocked using the key, this method is NOT RECOMMENDED - depending on the specification of the vehicle the alarm may not be disarmed.

**NOTE:** *If the handset does not operate after the vehicle has been parked for a long period, unlock the driver's door with the key and then try again. If the handset still fails to operate, enter the EKA code using the procedure shown later in this section.*

## Locks & Alarm

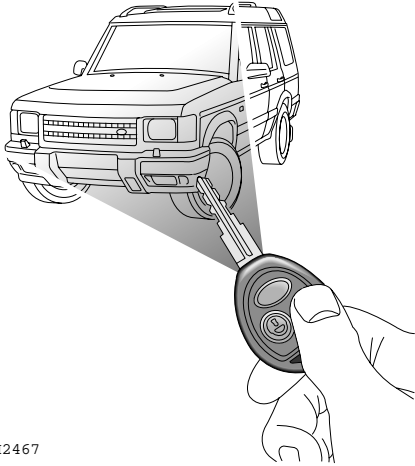

H2467

### Using the remote handset

While it is not necessary to point the handset at the vehicle, the handset must be within range of the vehicle when a button is pressed. Note that the operating range may vary depending upon handset battery condition and may sometimes be limited by physical and geographical factors beyond your control. From a security point of view, it may not be wise to unlock unless you are within a few feet of the vehicle.

### Superlocking

Provided all the doors are fully closed, the Superlocking feature is activated automatically whenever the vehicle is locked using the remote handset. Superlocking immobilises the interior door handles, thereby preventing an intruder from gaining entry by smashing a window and reaching inside the vehicle to operate the door handles.

Note that locking with the key will not activate superlocking.

### WARNING

*For safety, NEVER use Superlocking if passengers are to remain inside the vehicle - in an emergency they would not be able to escape.*

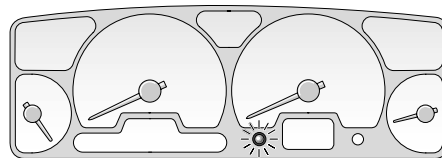

H2546

### Anti-theft alarm indicator light

This light provides information about the status of the alarm system, as follows:

#### *When the vehicle is locked:*

The light flashes rapidly while the alarm is arming itself. After ten seconds, the light adjusts to a slower frequency and continues to flash as an anti-theft deterrent until the alarm is disarmed.

#### *If the engine is immobilised (even though the alarm has been disarmed):*

The light flashes slowly until the engine is remobilised.

#### *If the alarm has been triggered:*

The light will flash rapidly when the alarm is disarmed until the starter switch is turned to position II.

#### *If the remote handset battery power is low:*

The light will flash rapidly for ten seconds after the handset has been used when the driver's door is opened.

## *Locks & Alarm*

---

### **Mislock**

If the driver's door is not fully closed when the handset lock button is pressed, the alarm sounder or vehicle horn will sound once, indicating a mislock. In this case, none of the doors will lock and the alarm system will not be armed.

If a passenger door or other aperture is not fully closed when the handset lock button is pressed, the alarm sounder or vehicle horn will sound once, indicating a mislock. However, the 'partial arming' attributes of the security system will enable as much of the system to be armed as possible (all fully closed door or bonnet apertures will be protected, but an open door will not!). As soon as the open aperture is closed, the system will automatically revert to a fully armed state.

**NOTE:** *If a mislock occurs as a result of an open door, the superlocking and interior space protection features will not be activated.*

**NOTE:** *Your Land Rover dealer can disable the mislock audible warning.*

### **If the alarm sounds**

If the alarm is triggered, the alarm sounder or vehicle horn will sound for 30 seconds before switching off and resetting itself to the same protection status that existed prior to the alarm being triggered.

To silence the alarm, press either button on the remote handset.

### **Headlight courtesy delay (if fitted)**

When locking the vehicle, the remote handset can be used to illuminate the headlights for 30 seconds. At night this will make it easier for you to unlock the garage, or walk to your house in safety. Operate this feature at the same time as you lock the car, by keeping the handset LOCK button pressed for more than 2 seconds (the doors lock and alarm system arms in the usual way).

To extinguish the lights before the 30 second illumination period has expired, press the lock button again.

**NOTE:** *This feature can be disabled by a Land Rover dealer.*

### **Single point entry**

This is a personal security feature, which enables the driver's door only to be unlocked, leaving the other doors in a locked state. It can be operated by the remote handset as follows:

Press the unlock button once to unlock the driver's door, press a second time (within one minute) to unlock the remaining doors.

**NOTE:** *This feature can be disabled by a Land Rover dealer.*

## Locks & Alarm

---

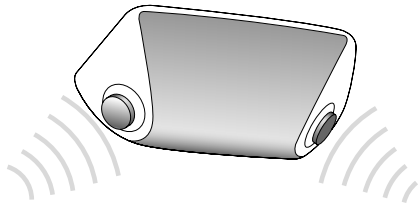

H2468

### Interior space protection

Interior space protection is designed to protect the interior of the vehicle from intrusion (entry by a thief through a smashed window, for example). Two pairs of sensors monitor the interior space and activate the alarm if air movement is detected in the passenger compartment.

#### Using the handset:

Interior space protection is activated automatically whenever the remote handset is used to set the alarm and can ONLY be deactivated with the handset.

#### Key operation:

Using the key will NOT activate (or deactivate) interior space protection.

**NOTE:** The feature cannot be activated if a door is open, or if the starter switch is turned on.

### WARNING

**Never activate interior space protection if windows or sunroof are to be left open, or if passengers or animals are to be left inside the vehicle - any movement will activate the alarm.**

---

### Speed-related locking (if fitted)

This security feature locks all the doors automatically when the vehicle speed exceeds 4 mph (7 km/h), and unlocks the doors as soon as the starter switch is turned off (provided the doors had previously been locked by the speed related feature).

Note that this feature is not selectable by the driver, and that operation of the door locks by any other means (interior locking switch on the fascia panel, for example) will disable the speed-related locking function for the remainder of the journey, or until the starter switch is turned off and on again.

**NOTE:** This feature can be selected or deselected by a Land Rover dealer.

## Locks & Alarm

### ENGINE IMMOBILISATION

Engine immobilisation is an important aspect of the security system, and includes a feature known as 'passive immobilisation'. This is designed to safeguard the vehicle from theft, should the driver forget to lock the doors and prevents the engine from being started unless the GENUINE handset key is inserted into the starter switch. Engine immobilisation is automatic whenever any of the following conditions occur.

- The vehicle is locked using handset or key.
- Thirty seconds after the starter switch has been turned off AND the driver's door opened.
- Five minutes after the starter switch is turned off, or the alarm system is disarmed.

**The engine will be re-mobilised automatically whenever the genuine handset key is inserted into the starter switch and turned to position 'II'.**

### EMERGENCY KEY ACCESS

If the handset is damaged, or fails to operate, the engine can be re-mobilised by using the key to enter a unique four number emergency key access code. The code is recorded on the Security Information card and is entered as follows:

### IMPORTANT INFORMATION

When entering a code:

- ENSURE each key movement is carried out with care and precision and turned to the full extent of its travel.
- After turning the key to either the lock or unlock positions, make sure it is FULLY returned to the centre (vertical) position.
- An interval of 10 seconds or more between key turns, or the key being held in a locked or unlocked position for 5 seconds or more will cancel an entry attempt, in which case you must start again with operation 1.



**1. Ensure that all doors are closed, then using the key turn the driver's door lock to the UNLOCK position (towards the front of the car) and hold in this position for at least 5 seconds until the alarm sounder sounds once). Then return the key to the centre position. It is now possible to use the key to enter the separate numerical values of the four numbers that make up the emergency key access code.**



**2. Enter the FIRST number of the code.** If the first number is 4, turn the key (towards the front of the car) to the UNLOCK position 4 times. Ensure the key is FULLY returned to the centre position after each turn.

## Locks & Alarm

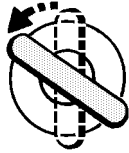

**3. Enter the SECOND number of the code.** If the second number is 3, turn the key (towards the rear) to the LOCK position 3 times.

Remember; the key must be FULLY returned to the centre position after each turn.



**4. Enter the THIRD number of the code.** If the third number is 12, turn the key to the UNLOCK position twelve times, ensuring that the key is

FULLY returned to the centre position after each turn.



**5. Enter the FOURTH number of the code.** If the fourth number is 1, turn the key to the LOCK position once. Ensure the key is FULLY

returned to the centre position.



**6.** Finally, turn the key to the unlock position once more. If the code has been entered correctly, a double 'bleep' will sound (a single 'bleep'

indicates that the code has been entered incorrectly).

**NOTE:** If the Mislock audible warning has been deselected (by a Land Rover dealer), the alarm sounder will not sound when an EKA code has been entered. Instead, the alarm indicator light on the instrument panel will flash once (for one second) to indicate a successful code entry.

There is now a **five minute delay** before the alarm and engine immobiliser are deactivated. **DO NOT OPEN THE DOOR OR ATTEMPT TO ENTER THE VEHICLE YET!**

**7.** Through the driver's door window, observe the anti-theft alarm indicator light on the instrument panel. If code entry was successful, this light will continue flashing (once every two seconds) for the five minute delay period.

**DO NOT OPEN THE DOOR OR ATTEMPT TO ENTER THE CAR** until the full delay period has elapsed - this will be indicated by the anti-theft alarm indicator light extinguishing.

**8.** Now open the door, insert the key into the starter and turn the switch to position 'II' IMMEDIATELY! If the starter switch is not turned to position 'II' within 30 seconds of the indicator light extinguishing, the engine will automatically immobilise again.

***If an incorrect code has been entered:***

If an incorrect code has been entered, the alarm sounder will sound once and the anti-theft alarm indicator light will continue to flash. In this case, return to operation '1' and re-enter the code.

After three failed entry attempts, the security system invokes a delay period of ten minutes during which the system will not accept any further attempts to enter a code.

IMPORTANT INFORMATION
Memorise the emergency key access code or keep the Security card on your person in case of emergencies. NEVER leave the card in the vehicle.

## Locks & Alarm

---

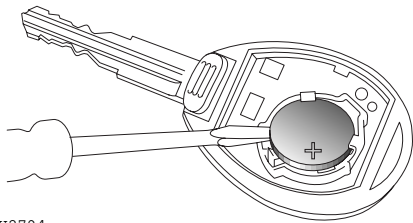
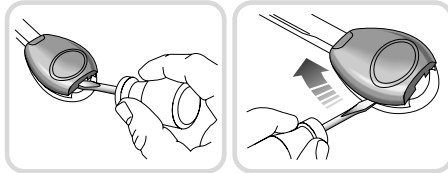

H2794

### REMOTE HANDSET BATTERY

The battery should last for approximately three years dependent upon use. When the battery needs replacing it will be apparent from the following symptoms:

- A gradual deterioration in range and performance.
- The alarm indicator light in the instrument panel will flash rapidly for 10 seconds after the driver's door is opened.

Always fit a Land Rover STC 4080 or a Panasonic CR2032 replacement battery (available from a Land Rover dealer) and adopt the following replacement procedure:

- 1) With the handset face down, insert the blade of a small flat-bladed screwdriver into the slot at the rear of the handset (see inset) and prise the back upwards.
- 2) Insert the screwdriver blade as shown in the right hand inset and then carefully slide it along the joint towards the key to release the back of the handset.
- 3) Use a small flat-bladed screwdriver to prise the battery from its mounting (see illustration), taking care to avoid touching the circuit board or the metal battery contacts.
- 4) Fit the new battery, ensuring that correct polarity is maintained ('+' side facing up). Finger marks will adversely affect battery life; if possible, avoid touching the flat surfaces of the battery and wipe them clean before fitting.
- 5) Press the two halves of the handset firmly together and ensure that both halves are fully joined to prevent dirt or moisture from entering the handset.

The handset is now ready for use.

### WARNING

*The handset contains delicate electronic circuits and must be protected from impact and water damage, high temperatures and humidity, direct sunlight and the effects of solvents, waxes and abrasive cleaners.*

---

## Locks & Alarm

---

### KEY AND HANDSET NUMBERS

You have been supplied with two remote handsets with integral keys which operate all locks.

The key number is stamped on a tag attached to the key ring. Check that the key number has been entered in the space provided on your Security card.

If the remote handset is lost, contact a Land Rover dealer, who can supply replacement units.

### WARNING

*Keep the Security card and spare handset in a safe place - NOT IN THE VEHICLE!*

---

### Interior door handles and door sill locking buttons

From inside the vehicle, each door can be individually locked by depressing the appropriate door sill button. However, doors cannot be unlocked by raising the sill button.

Use the door handles to unlock, as follows:

- First operation of the door handle unlocks the door.
- Second operation of the door handle opens the door.

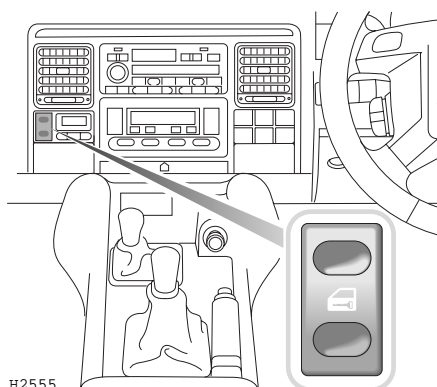

### Interior locking switch

This is a personal security feature which allows the driver to lock (or unlock) all the doors from inside the vehicle (while driving or with the vehicle stationary). Press the lower part of the switch to lock (the alarm will not be armed), and the upper part to unlock.

**NOTE:** *If the locks have already been superlocked, the switch will not release the locks.*



## Locks & Alarm

---

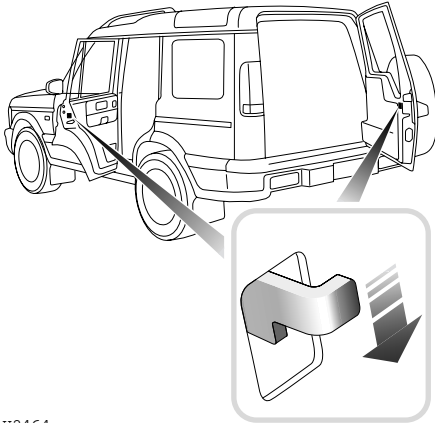

H2464

### CHILD-PROOF LOCKS

Move the locking levers on the rear doors and taildoor down to engage the child locks.

With the child-proof locks engaged, neither the rear doors nor the taildoor can be opened from inside the vehicle, thereby avoiding the risk of a door being opened accidentally while the vehicle is moving.

### WARNING

***NEVER leave children unsupervised in the vehicle.***

---

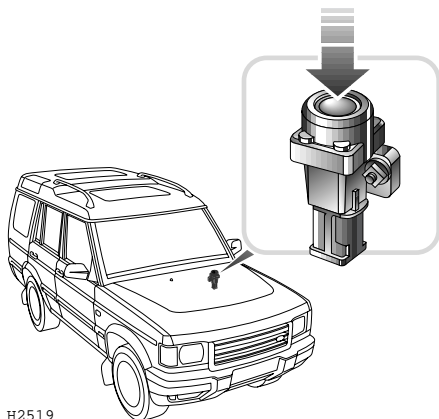

H2519

### DOOR LOCKING CUT-OFF SWITCH

An inertia switch, operational only with the starter switch in position 'II' and the alarm disarmed, prevents the doors centrally locking (or if the doors are locked, will unlock them) in the event of an accident or sudden impact.

When the switch operates, the direction indicator lights flash (if market permits), until the system is reset by turning the starter switch on and off, and opening and closing the driver's door.

Note that doors cannot be locked again until the switch is reset.

The inertia switch also cuts off the fuel supply (see '*Fuel cut-off switch*').

### WARNING

***Always check for fuel leaks before resetting the switch!***

---