

LAND ROVER

AUDIO SYSTEM





BY APPOINTMENT
TO HER MAJESTY THE QUEEN
MANUFACTURERS OF
LAND ROVER VEHICLES
LAND ROVER, WARWICK



BY APPOINTMENT
TO HER MAJESTY THE QUEEN
MANUFACTURERS OF
LAND ROVER VEHICLES
LAND ROVER, WARWICK



BY APPOINTMENT
TO HER MAJESTY THE QUEEN
MANUFACTURERS OF
LAND ROVER VEHICLES
LAND ROVER, WARWICK



BY APPOINTMENT
TO HER MAJESTY THE QUEEN
MANUFACTURERS OF
LAND ROVER VEHICLES
LAND ROVER, WARWICK



FREELANDER

AUDIO SYSTEM

Publication Part No. LRL0673NAS

© Land Rover 2003

All rights reserved. No part of this publication may be reproduced, stored in a retrieval system or transmitted in any form, electronic, mechanical, recording or other means without prior written permission from Land Rover.



As part of Land Rover environmental policy, this publication is printed on paper made from chlorine free pulp.

Introduction

For your convenience, this handbook is divided into sections, each dealing with a different aspect of the unit. These are listed on the contents page and you will find it worthwhile to take a little time to read each one, and get to know your audio unit as soon as you possibly can. The more you understand before you drive, the greater the satisfaction once you are seated behind the steering wheel.

* An asterisk appearing within the text, identifies features or items of equipment that are fitted as options.

IMPORTANT

The specification of each vehicle will vary according to territorial requirements and also from model to model within the vehicle range. Some of the information published in this handbook, therefore, may not apply to your particular vehicle.

Land Rover operates a policy of constant product improvement and therefore reserves the right to change specifications without notice at any time. Whilst every effort is made to ensure complete accuracy of the information in this handbook, no liabilities for inaccuracies or the consequences thereof can be accepted by the manufacturer or the dealer, except in respect of personal injury caused by the negligence of the manufacturer or the retailer.

Contents

Visteon Control Panel

Radio Reception	3
Care of Compact Discs	4
Control Panel	5
Radio Remote Controls	6
General Operation	7

Radio Operation

Radio Operation	10
-----------------------	----

CD Operation

CD Operation	16
--------------------	----



Radio Reception

RADIO RECEPTION

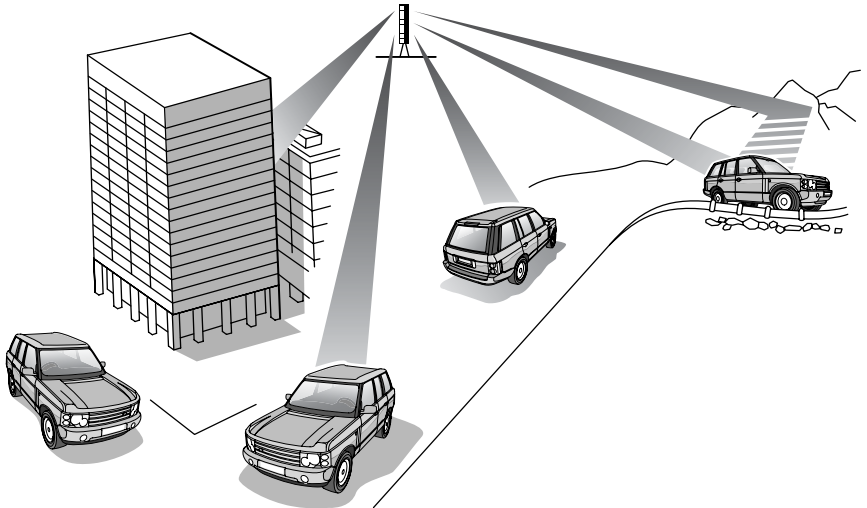

ICE 0222

Distortion, interference and lack of signal clarity, are often attributed to a fault in the radio - this is rarely the case.

Problems of this kind are usually caused by phenomena such as atmospheric conditions, signal strength, hilly terrain, tall buildings, bridges and even electrical interference from power lines.

Please remember: A car radio receives signals while the vehicle is in motion (unlike a domestic set) - constantly changing direction and moving away from, or nearer to, the transmitter whilst negotiating terrain with widely differing reception characteristics. Some interference is to be expected from time to time.

FM transmitters can only broadcast over a limited range and good, clear signals will only be received in the immediate area of the transmitter. When travelling, it may be necessary to re-tune the radio from time to time, to offset the effects of moving from one transmitter area to another.

While RBDS automatic retuning eases this problem, some manual retuning may still be needed (especially for local stations) in areas of weak reception.

The broadcast range for good stereo reception (usually within a 30 to 40 miles radius of the transmitter) is noticeably less than it is for mono.

FM Signals (like light waves) travel in a straight line, so large obstacles, such as tall buildings, can shield the car from the signal causing distortion or loss of reception (known as dead spots).

Distortion can also occur if FM signals received directly from the transmitter mix with signals which have been reflected by obstructions such as mountains, hills and tall buildings (this is known as multi-path distortion).

Care of Compact Discs

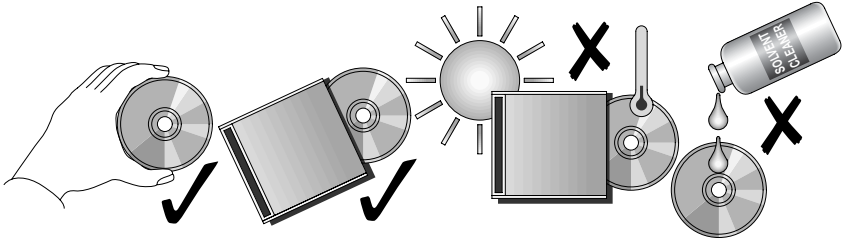

ICE 0022

CARE OF COMPACT DISCS

Dirt, dust, condensation and heat can damage discs. Always observe the following precautions:

NEVER touch the playing surface (the unlabelled side) of a disc. Handle discs by holding the outer edges, or the edge of the central hole and the outer edge, between finger and thumb.

ALWAYS return discs to their boxes after use to prevent contamination (dirt detracts from the sound quality).

NOTE: Some music CD manufacturers are using data encryption to 'copy-protect' their recordings and prevent the production of pirate copies. These CD's differ from the internationally agreed CD audio standard, RedBook, which is the standard that serves as the operating basis for all CD players and changers.

Copy-protected CD's may not play in your Audio unit or CD changer or may be played subject to various limitations, e.g., sound quality may be impaired.

If you do experience a problem, try the CD in other players before contacting the CD vendor.

NEVER leave the disc or the box exposed to excessive heat or direct sunlight.

NEVER use a solvent or abrasive cleaner. Dust or dirt should be removed from the playing surface by wiping with a clean, dry, lint-free cloth. Always wipe in a straight line from the centre to the edge of the disc.

If minor scratches on the surface of a compact disc cause skipping or mistracking, use CD restorer polish to remove the scratches and improve the performance of the disc. When using CD restorer polish, always follow the manufacturer's instructions.

Control Panel

CONTROL PANEL

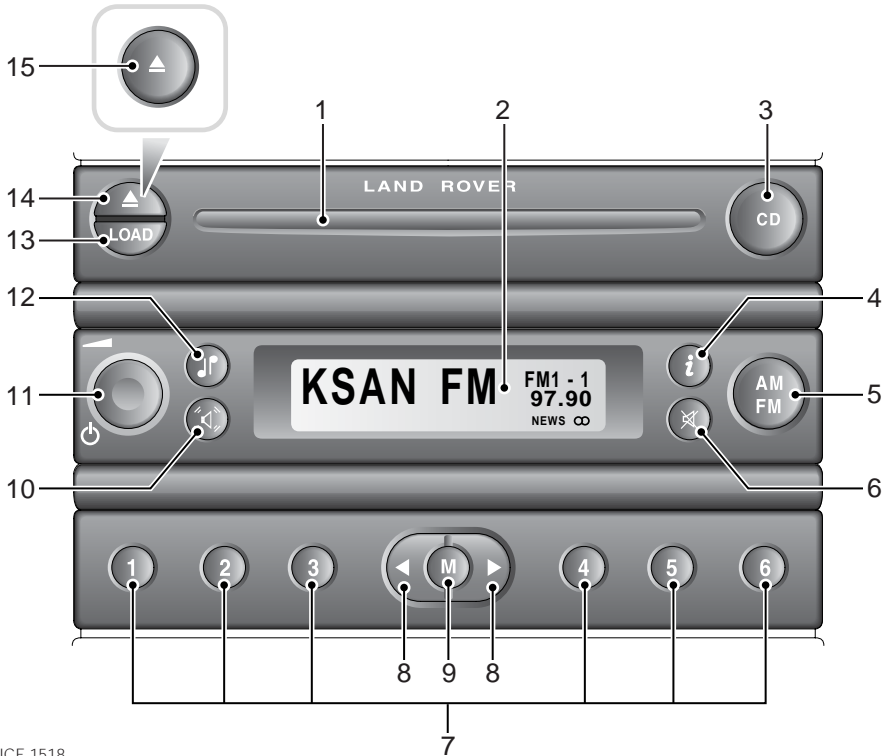

ICE 1518

- 1. CD slot**
 - 2. Display**
 - 3. CD mode selector**
Press to change to CD mode.
 - 4. i button**
Press to activate the news feature on FL5.
On FL3 press to activate SCAN.
 - 5. Waveband selector and Autostore**
Press to change wavebands. Press and hold to Autostore.
 - 6. Mute control**
 - 7. Radio pre-set/CD disc select buttons**
For storing radio stations and entering the security code. CD disc selection (FL5).
 - 8. Seek/select buttons**
Press to seek/select.
 - 9. Menu button**
Press to access menu functions.
 - 10. Fade/balance control**
 - 11. On/off and volume control**
 - 12. Tone control**
Press to activate the tone menus.
 - 13. CD load button (FL5)**
Press to begin CD loading.
 - 14. CD eject button (FL5)**
 - 15. CD eject button (FL3)**
- NOTE:** FL3 refers to the single disc player, and FL5 refers to the six disc player.

Radio Remote Controls

RADIO REMOTE CONTROLS *

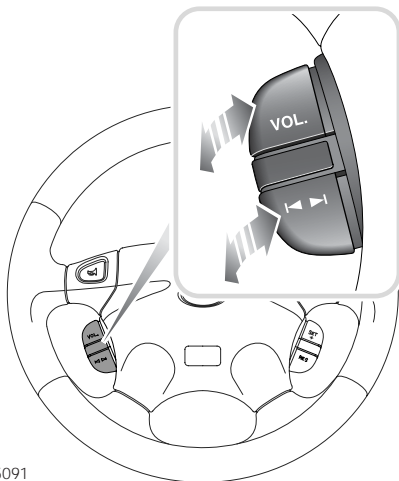

H5091

Volume control

VOL Lift or press to increase or decrease the volume.

Search control

 Lift or press to move up or down to the next, or previous pre-set radio stations on the selected waveband.

Lift and hold to seek up through the current band stopping at any station with a strong signal. Press and hold to seek down through the selected wave band.

In CD mode, lift the control to move to the next track on the disc, or press to return to the start of the current track, and press again to return to the start of the previous track.

In CD mode, lift and hold to fast forward through the track currently playing. Press and hold to rewind the track currently playing.

General Operation

GENERAL OPERATION

Switching On and Off

Press the On/Off button (11).

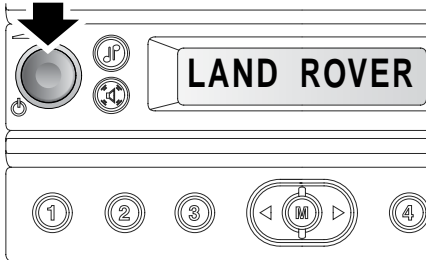

ICE 1460

Additional options for switching on/off:

Via ignition: In order to switch on via the ignition, the unit must have been switched off previously via the ignition.

With the ignition switched off, the unit can be switched on via the On/Off button. The unit switches off automatically after 1 hour to conserve battery power.

To deactivate the unit, either switch off the ignition or press the On/Off button.

Adjusting the volume

Turn the rotary control (11). The volume is increased or decreased.

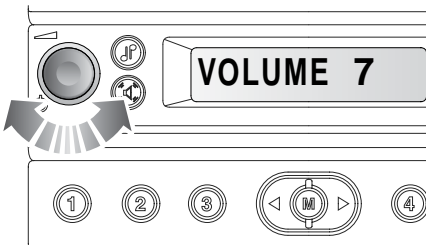

ICE 1459

The unit has five additional features associated with volume control:

Automatic volume control (AVC)

This function automatically adjusts the volume level to compensate for engine and road noise. To activate the function:

A

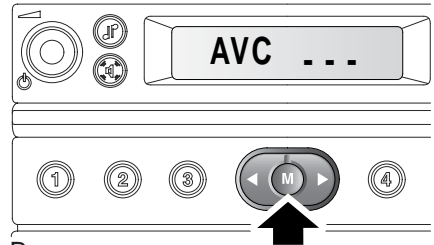

B

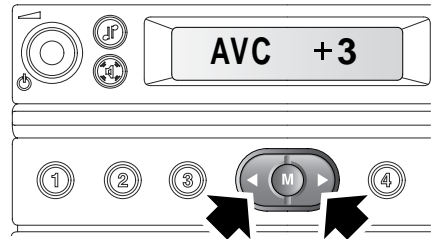

ICE 1450

- A. Press the **M** button (9) repeatedly until the AVC display appears.
- B. Press the seek control buttons (8) to adjust the level of compensation, including **AVC OFF**. The higher the selected number, the greater the compensation.

General Operation

Audio distortion reduction (CLIP)

This function automatically detects sound distortion and adjusts the volume level until the distortion is eliminated. An attempt to increase volume whilst the CLIP function is active may not result in increased volume.

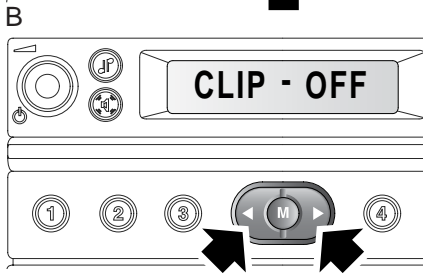
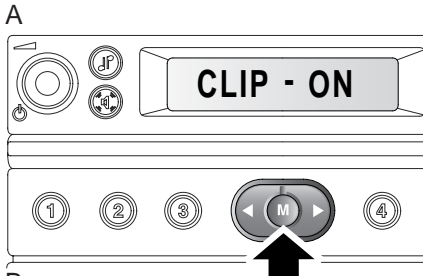

ICE 1452

To activate/deactivate the function:

- A. Press and hold the **M** button (9) for approximately 8 seconds until the display changes, then press repeatedly until CLIP is displayed.
- B. Use the seek control buttons (8) to turn the function on or off.

Combined treble and bass control

Press the tone control (12) once for bass and twice for treble, then use the rotary control (11) to adjust the levels.

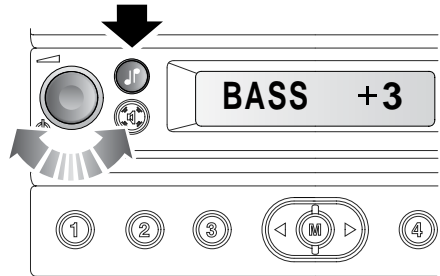

ICE 1454

The levels are indicated in the display.

Fade and balance control

Press the fade/balance control (10) once for fade (front to rear) and twice for balance (side to side). Use the rotary control (11) to make adjustments.

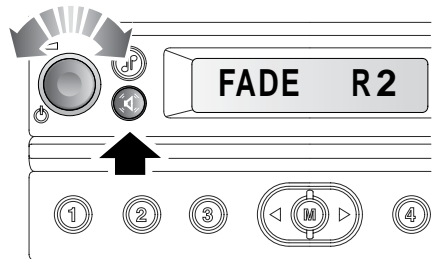

ICE 1456

The levels are indicated in the display.

General Operation

Mute function

Press the mute button (6) to silence the audio unit. Press it again, or adjust the volume level, to restore sound.

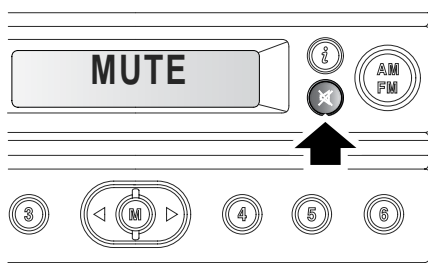

ICE 1458

Radio Operation

RADIO TUNING

Waveband selector

Press the waveband selector button (5) repeatedly to scroll through available wavebands or Autostore radio stations, see 'AUTO-STORE', page 12. The display indicates the selection made.

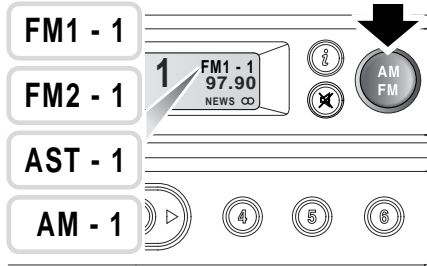

ICE 1519

NOTE: The FL5 unit has an extra 6 pre-sets available via Autostore in AM mode.

Press the waveband selector button during CD play to return to radio reception.

Seek/select buttons

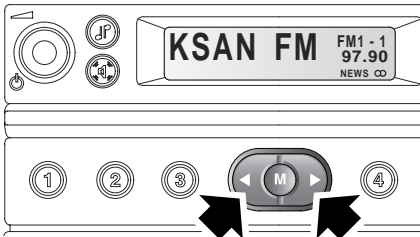

ICE 1520

During radio reception, press either seek/select button (8) to locate the next strong station up or down the selected waveband.

Manual tuning

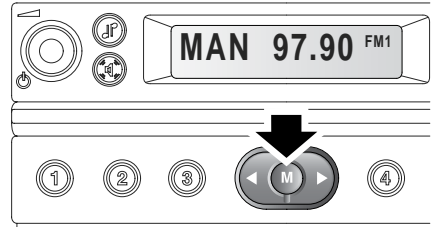

ICE 1464

Press the **M** button (9) once and the above display will appear.

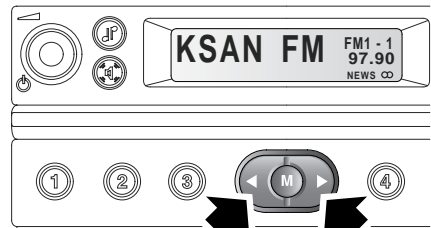

ICE 1520

Pressing either of the seek/select buttons (8) causes frequency changes (either up or down) one step at a time.

Fast manual tuning

By keeping either seek/select button (8) depressed, the waveband is scanned rapidly up and down until the button is released.

Radio Operation

Scan tuning

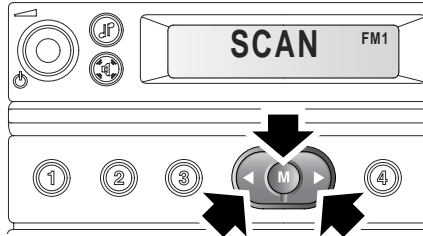

Press the **M** button (9) repeatedly until the above display appears. Use the seek/select buttons (8) to scan up/or down the waveband selected.

Scan flashes in the display and each station is played for a few seconds in turn.

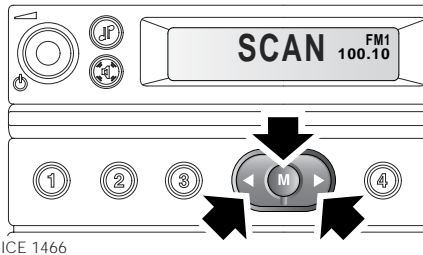

Press the **M** button (9) or a seek/select button (8) again to continue listening to a station.

STATION PRE-SET BUTTONS

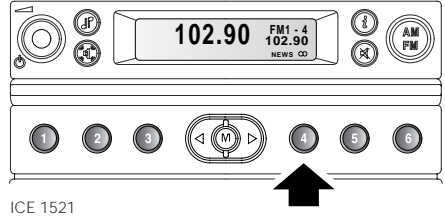

The six pre-set buttons (7) can be used to manually store up to 30 stations on FL5 and 24 on FL3 - six on each of the AM, FM1, FM2 and FM Autostore wavebands (FL5 has Autostore on both AM and FM bands).

Programming the pre-sets

- Select a waveband, see 'Waveband selector', page 10.
- Tune to the station required, see 'Manual tuning', page 10.
- Press and hold one of the pre-set buttons. The radio will mute while the frequency you have chosen is stored on the pre-set.
- Release the pre-set as soon as radio sound is restored and the new frequency details are displayed.

NOTE: Once the pre-sets have been programmed, they will be retained by the audio unit until they are re-programmed.

Operating the pre-sets

Once the pre-set buttons have been programmed, operation is simple: select the desired waveband, then press the pre-set button of your choice.

Radio Operation

AUTO-STORE

Auto-store enables you to rapidly tune and store the strongest FM and AM radio signals in a single operation. This facility is particularly useful if you are in an unfamiliar area and have little knowledge of local transmitter frequencies.

NOTE: Autostore is not available for the AM band on FL3 units.

Programming auto-store

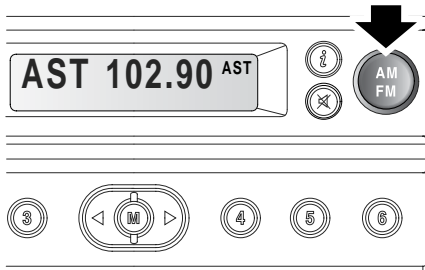

ICE 1468

Press and hold the AM/FM button (5).

The radio mutes and the display shows **AST** flashing.

Auto-store scans the waveband to find the six strongest frequencies and then stores them in order of signal strength, overwriting any stations already stored. Radio sound is restored once the operation is complete.

If auto-store is unable to find six strong stations, the remaining pre-sets stay unchanged.

NOTE: The auto-store waveband can also be used to store stations manually.

Operating auto-store

To tune to one of the auto-store frequencies, select auto-store using the waveband selector button (5), then press the pre-set button of your choice.

Radio Operation

NEWS BROADCASTS (FL5 only)

On the FM waveband, the Radio Broadcast Data System (RBDS) facility enables your radio to receive news broadcasts from other local radio stations that are linked to the same network as the station to which it is tuned.

News (FM waveband only)

If this feature is selected, any news broadcast by a linked selected station will automatically interrupt normal operations.

The display alternates between the station name and **NEWS**.

PROGRAMME TYPE (PTY) SELECTION*

Specific types of programme, such as sport, pop music, classical music, etc., can be selected using the PTY function on the FL5 units. The PTY is broadcast by the RBDS transmitter, provided that the transmitter is equipped with this function. The selected transmitter programme type can be displayed or a search for a specific PTY transmitter can be performed.

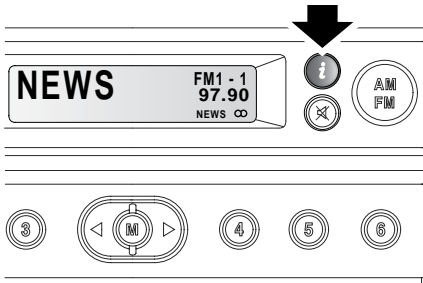

ICE 1522

To select this feature:

1. Press the **i** button (4) and **NEWS** will appear in the display.
2. Press the **i** button (4) again to disable the news feature.

Note: The FL3 radio does not have the news feature. If the **i** button (4) is pressed in radio mode the scan feature will operate see 'Scan tuning', page 11. If the **i** button (4) is pressed in CD mode the scan feature will operate see 'Track Scanning (FL5 only)', page 20.

Radio Operation

Programme type selection (PTY)*

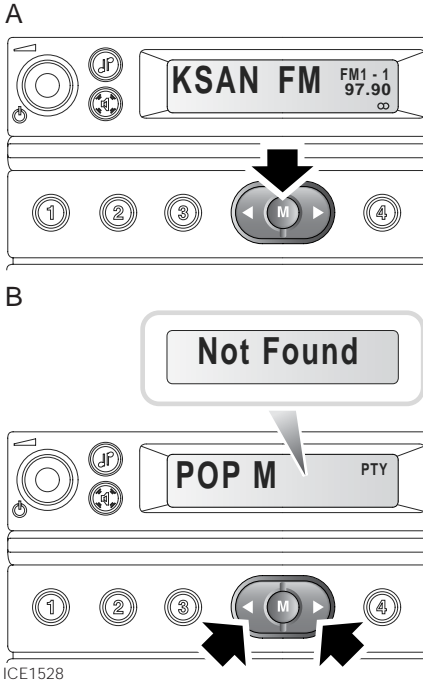

- A. Press the **M** button (9) repeatedly until a PTY display appears.
- B. From this position, similar programme types can be searched for by pressing the seek/select buttons (8) to locate other stations broadcasting programmes of the same type.

If unsuccessful, **Not Found** is displayed and the radio returns to the original station.

Changing programme type selection (PTY)*

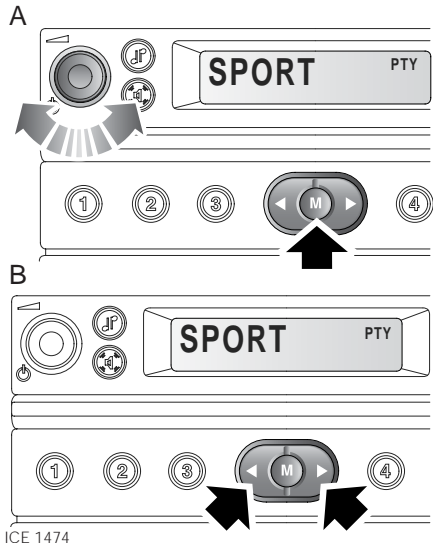

- A. Press the **M** button (9) repeatedly until a PTY display appears then, use the left rotary control (11) to select the required programme type.
- B. Use the seek/select buttons (8) to search for a station broadcasting the selected programme type.

While searching, the audio unit displays the programme type requested and **PTY** flashes in the display. When a programme is found, the station name and the programme type flash alternately in the display.

If unsuccessful, **Not Found** is displayed and the radio returns to the original station.

If required, use the seek/select buttons (8) to find another station.

Radio Operation

Programme Types

Examples of programme types are:

NONE	No programme type defined
NEWS	News services
INFORM	Information
SPORTS	Sport
TALK	Talk
ROCK	Rock music
CLS ROCK	Classic rock music
ADLT HIT	Adult hits
SOFT RCK	Soft rock music
TOP 40	Top 40 (chart music)
COUNTRY	Country music
OLDIES	Oldies
SOFT	Soft music
NOSTALGA	Nostalgia
JAZZ	Jazz music
CLASSICL	Classical music
R&B	R&B (Rhythm and Blues)
SOFT R&B	Soft R&B
LANGUAGE	Language (other than English)
REL MUSIC	Religious music
REL TALK	Religious talk
PERSNLTY	Personality
PUBLIC	Public
COLLEGE	College
Positions 24 -28	These PTY types have not yet been allocated, and are reserved for use in the future.
WEATHER	Weather information
TEST	Emergency test
ALERT!	Emergency information

NOTE: *TEST and ALERT emergency broadcast stations may not be available currently. When the ALERT stations are available they will broadcast important information in the event of an emergency. TEST will broadcast a test signal for the emergency information to allow the public and emergency services to ensure that emergency procedures can be practised without causing alarm.*

CD Operation

CD OPERATION

WARNING

CD units are designed to play commercially produced 12 cm audio compact discs only. Due to technical incompatibility, recordable (CD-R) and rewritable (CDRW) discs may not function correctly when used in Land Rover CD players.

Irregularly shaped CDs, and CDs with a scratch-protection film, should not be used.

For the best possible sound quality, use CDs that are clean and in good condition. Please contact your Land Rover Dealer for further information.

If this is done with no CD present, then the display shows **NO DISC**.

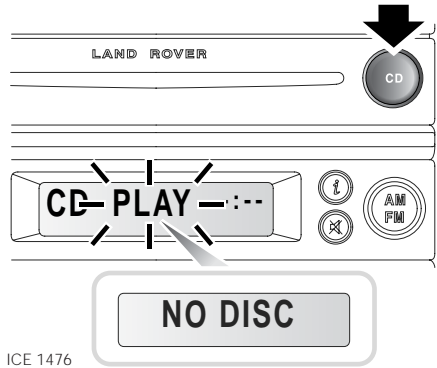

ICE 1476

Loading a CD (Single-play unit)

Switch on the audio unit by pressing the rotary control (11) and insert a CD.

CD PLAY flashes in the display, radio reception is interrupted and CD playback starts.

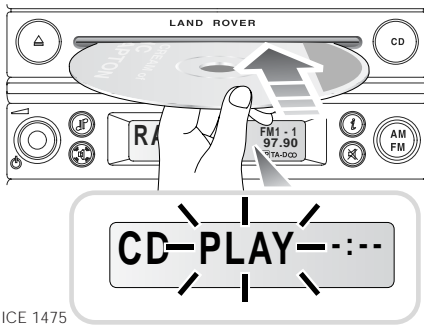

ICE 1475

If the unit is switched on in radio mode with a CD already in the unit, press the CD button (3) to start play.

CD Operation

Loading a single CD (Multi-play unit)

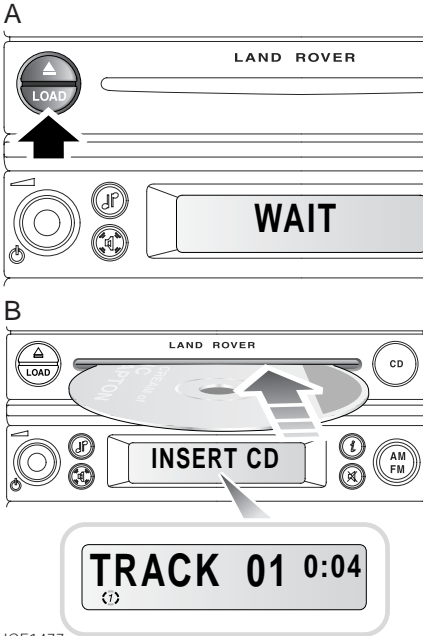

ICE1477

- A. Press the **LOAD** button (13) and **WAIT** will appear in the display.
- B. When this changes to **INSERT CD**, insert a CD into the audio unit. **WAIT** appears and Playback starts automatically. The display then shows which track is being played.

Loading multiple CD's

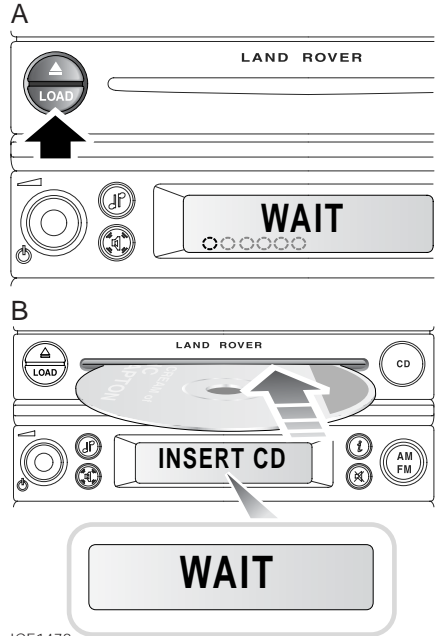

ICE1478

- A. Press and hold the **LOAD** button (13) until **WAIT** appears in the display.
- B. When this changes to **INSERT CD**, insert a single CD into the audio unit. The CD will be drawn into the player automatically.

NOTE: Do not force the CD into the player, as this may damage the unit.

Once the CD is loaded, the display changes to **WAIT** and then **INSERT CD** appears again to confirm that another CD may be loaded. When loading less than six CD's, press the **CD** button (3) to stop loading and start play of the last CD loaded.

CD Operation

Multi-play CD unit capacity

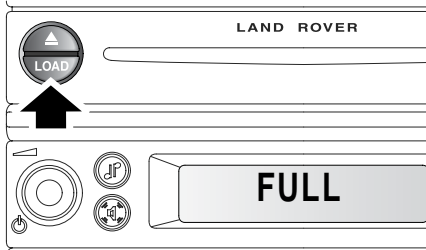

ICE1479

The display shows **FULL** if six CDs have been loaded and the **LOAD** button (13) is pressed again.

If two or more CDs are loaded one after the other, playback will start with the last CD inserted.

Disc selection

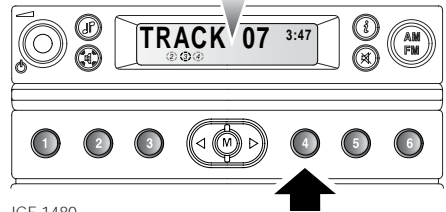
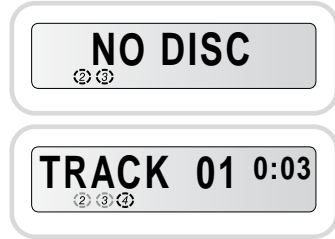

ICE 1480

Each disc is allocated one of the six pre-set buttons (7). To select a specific disc during playback, press the pre-set button that corresponds to the required CD. The display will show the disc selected.

During normal operation, CDs and tracks are automatically selected and played sequentially in ascending order. At the end of the last track on disc six, disc one will be played. If a selected disc is missing, the display shows **NO DISC** and playback continues.

CD Operation

Track selection

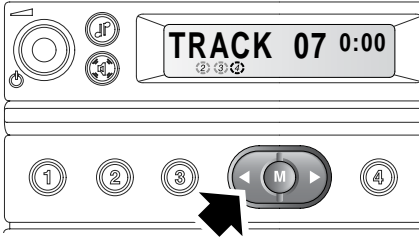

Press the left-hand seek/select button (8) to return to the start of the track being played.

If pressed within 2 seconds of the start of a track, the previous track will be selected. Press repeatedly to select previous tracks on the disc selected.

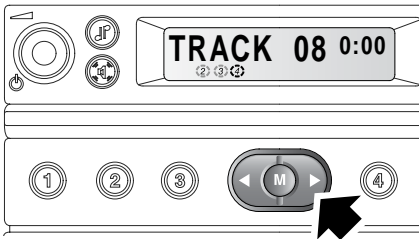

Press the right-hand seek/select button (8) to move forward to the start of the next track. Press repeatedly to select subsequent tracks.

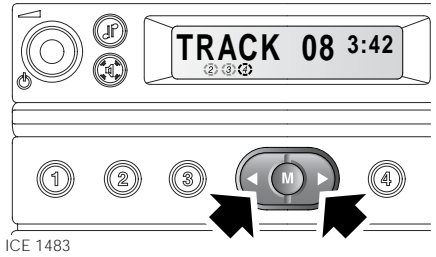

Press and hold the left, or right-hand seek/select buttons (8) to rewind or fast-forward through the current track.

CD Operation

Track Scanning (FL5 only)

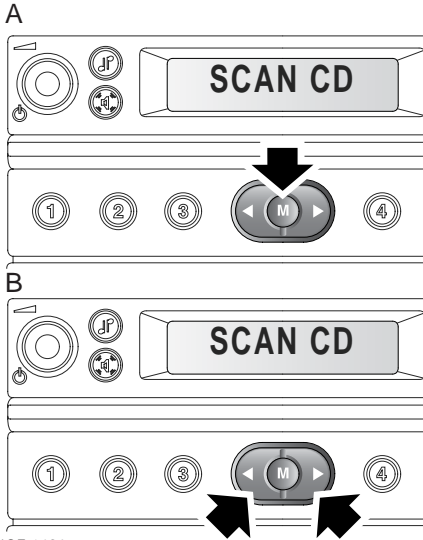

ICE 1486

Using **SCAN** allows you to listen to each track for a few seconds prior to making your choice.

- A.** Press the **M** button (9) repeatedly until the display shows **SCAN CD**.
- B.** Press the left or right-hand buttons (8) to scan up or down through the tracks.

Press the left or right-hand button again to listen to a track that is playing.

Alternatively, refer to the Track Selection information to select a track manually see 'Track selection', page 19.

NOTE: Scan will be cancelled automatically after one complete scan cycle.

Random Playback

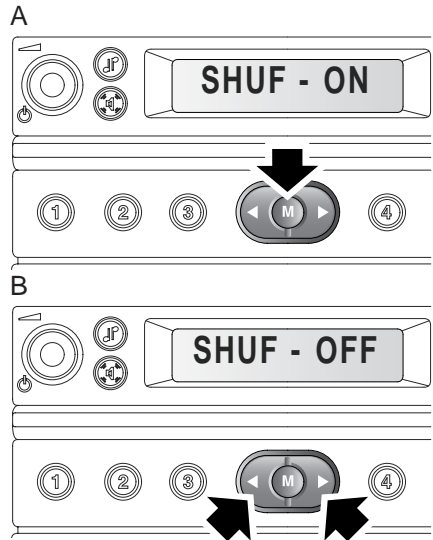

ICE 1484

- A.** Press the **M** button (9) repeatedly until the display shows **SHUF-ON** or **SHUF-OFF**.
- B.** To change the status from on to off, or off to on, press the left or right-hand buttons (8).

When random playback is turned on the display will show **SHUF** at the start of each new track.

NOTE: SHUF is an abbreviation of 'Shuffle' which is sometimes used as an alternative description to 'Random Playback'.

CD Operation

Track Compression (FL5 only)

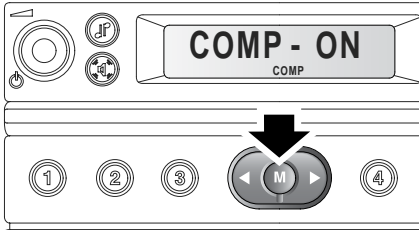

ICE 1485

The Track Compression feature increases the volume for quiet sounds/music, and decreases the volume for loud noises/music within a track. This prevents the need to constantly adjust the volume levels whilst playing tracks that have a wide volume range when recorded.

Press the **M** button (9) repeatedly until the display shows **COMP-ON** or **COMP-OFF**.

To change the status from on to off, or off to on, press the left or right-hand buttons (8).

Ending playback

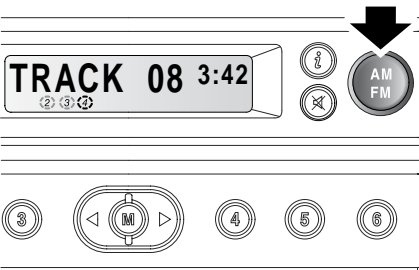

ICE 1487

To end playback without ejecting the disc press the **AM/FM** button (5). If the button is pressed again playback will restart from the point at which it was stopped.

Ejecting a CD (single disc player)

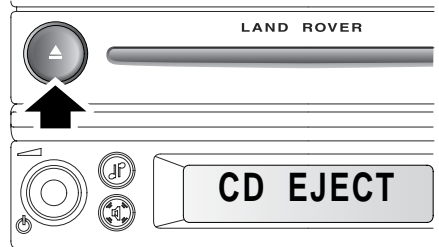

ICE1488

To eject a disc during playback where your vehicle is fitted with a single disc player, press the eject button (15).

CD Operation

Ejecting a single CD (multi disc player)

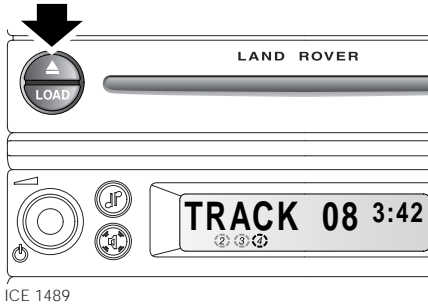

To eject a disc during playback where your vehicle is fitted with a multi disc player, press the eject button (14).

- A. To select and eject a disc from those loaded, first press the **AM/FM** button (5).
- B. Once disc play has stopped, press the eject button (14) and **SELECT CD** will be shown on the display.
- C. Select the disc to be ejected using the numbered radio station preset buttons (7).
- D. **EJECTING** followed by **REMOVE CD** will be displayed.

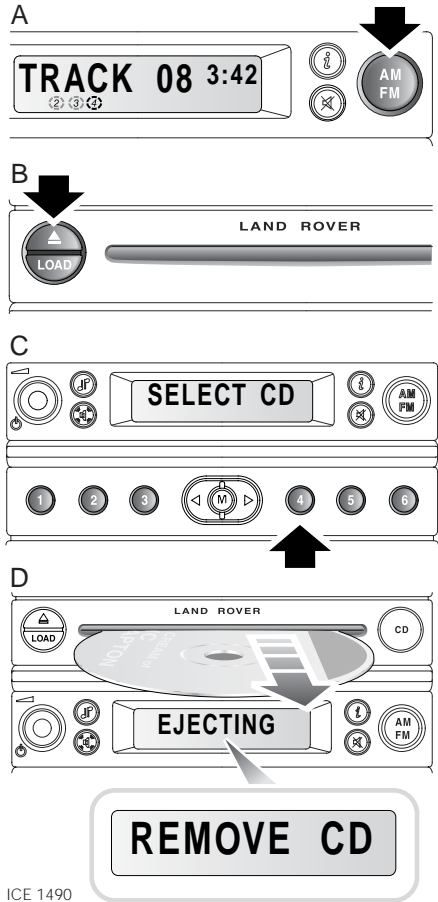

NOTE: If the disc is not removed from the player it will be drawn back in.

CD Operation

Ejecting all discs

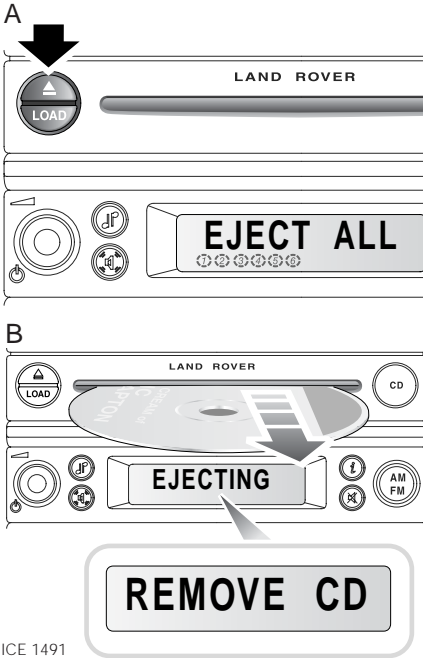

ICE 1491

- A.** To eject all of the discs from the player press and hold the eject button (14) until the display shows **EJECT ALL**. The display will then show **EJECTING** followed by **REMOVE CD** when the disc is presented for removal.
- B.** Once the disc has been removed from the player **EJECTING** will be shown again followed by **REMOVE CD**. This process will be repeated until all the discs have been removed.

Index

A

Adjusting volume	7
Automatic volume control	7
Auto-store	12

B

Balance	8
---------	---

C

Care of compact discs	4
CD data encryption	4
CD faults	4
CD operation	16
CD selection	18
CD sound quality	4
CLIP	8
COMP	21
Compact discs - care of	4
Control panel	5
Copy protected CD's	4

D

Disc eject (multi disc player)	22
Disc eject (single disc player)	21
Disc selection	18
Distortion reduction	8

E

Ejecting a CD	21
Ejecting a disc (multi disc player)	22
Ejecting a disc (single disc player)	21
Ejecting a single CD	
Multi-Disc player	22
Ejecting all CD's	23
Multi-Disc player	23
Ejecting all discs	23
Ending playback	21

F

Fade and balance control	8
--------------------------	---

G

General operation	
adjusting the volume	7
switch on/off	7

L

Loading a CD	
Single CD player	16
Loading a single CD	
Multi CD player	17
Loading multiple CD's	17

M

Multi CD player capacity	18
Multi CD player full	18
Mute	9

N

News bulletins	13
----------------	----

P

Programme type selection	14
Programme Type Selection (PTY)	13
PTY	13, 14

R

Radio controls	5
Radio reception	3
Random playback	20
Reception - radio	3
Remote controls (radio)	6

S

SCAN - CD	20
SCAN - radio	11
Shuffle	20
Steering mounted radio controls	6
Stopping CD	21
Storing stations	12
Switching on/off	7

T

Track compression	21
Track selection	19
Track shuffle	20
Treble and Bass control	8

V

Volume adjustment	7
-------------------	---