

TECHNICAL INFORMATION



No: 86/08/03/NAS
Ref:
Issue: 1
Date: 06/13/03

Driving Light Kit Fuse Installation

AFFECTED VEHICLE RANGE:

Discovery Series II (LT)

All with Secondary Air Injection (SAI)

SITUATION:

COMPONENT INTERFERENCE WHEN INSTALLING LIGHT KIT RELAY

The relay holder for lamp kit STC53196 was designed prior to Discovery Series II having the latest emissions control system. The relay holder is intended to be attached to the rear of the engine fuse box. This area was clear of components at the time of the original design. However, introduction of SAI onto the vehicles places a filter for the Advanced EVAPS system in this corner of the engine bay. The filter interferes with the driving light relay fuse holder as designed.

RESOLUTION:

MODIFY LIGHT KIT FUSE LOCATION TO PERMIT INSTALLATION

Relocation of the fuse for the lamps and bending the Secondary Air Injection filter bracket to provide extra space are required for correct installation of the relay components. A simple adjustment process during the installation of the kit accomplishes the required alteration.

PARTS INFORMATION:

STC53196.....Lamp Kit (MODIFICATION REQUIRED)

WARRANTY CLAIMS:

*Normal warranty policy and procedures apply.
Material allowance is included in labor operation.*

TIB 86/08/03/NAS	CIRCULATE: TO	Service Mgr X	Warranty X	Workshop X	Body Shop X	Parts X
---------------------	------------------	------------------	---------------	---------------	----------------	------------

REPAIR PROCEDURE

REPOSITION FUSE HOLDER

 **NOTE:** Attempts to install the relay and bracket without alternation will result in interference with the SAI filter. (Figure 1)

1. Remove the fuse holder from the relay.
2. Unscrew the self-tapping screw from the fuse holder mounting block. (Figure 2)

 **NOTE:** It is not necessary to drill a hole for the self-tapping screw. The screw will penetrate the plastic without difficulty.

3. Use the removed self-tapping screw to start a hole in the side of the relay bracket. (Figure 2)
4. Position the mounting block at the center of the relay bracket short side.
5. Secure the mounting block to the relay bracket with the self-tapping screw. (Figure 3)
6. Trial mount the relay and bracket as specified in the accessory installation instructions and bend the SAI filter bracket gently aside to ensure an interference-free installation.
7. Mount the fuse holder to the newly relocated mounting block and install the assembly as specified in the accessory instructions.

Figure 1

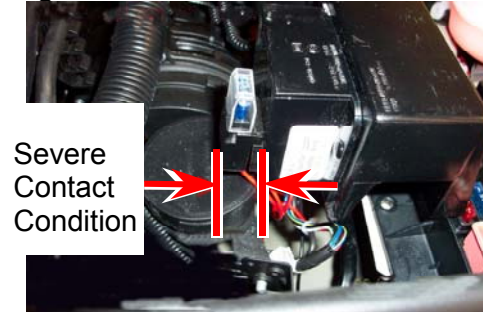

Figure 2

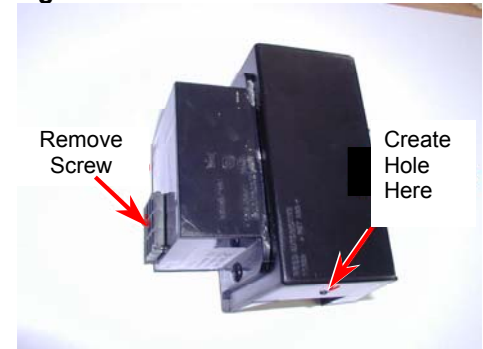

Figure 3

