

CHARGING NETWORK FOR 109 (Part No. 017-067)

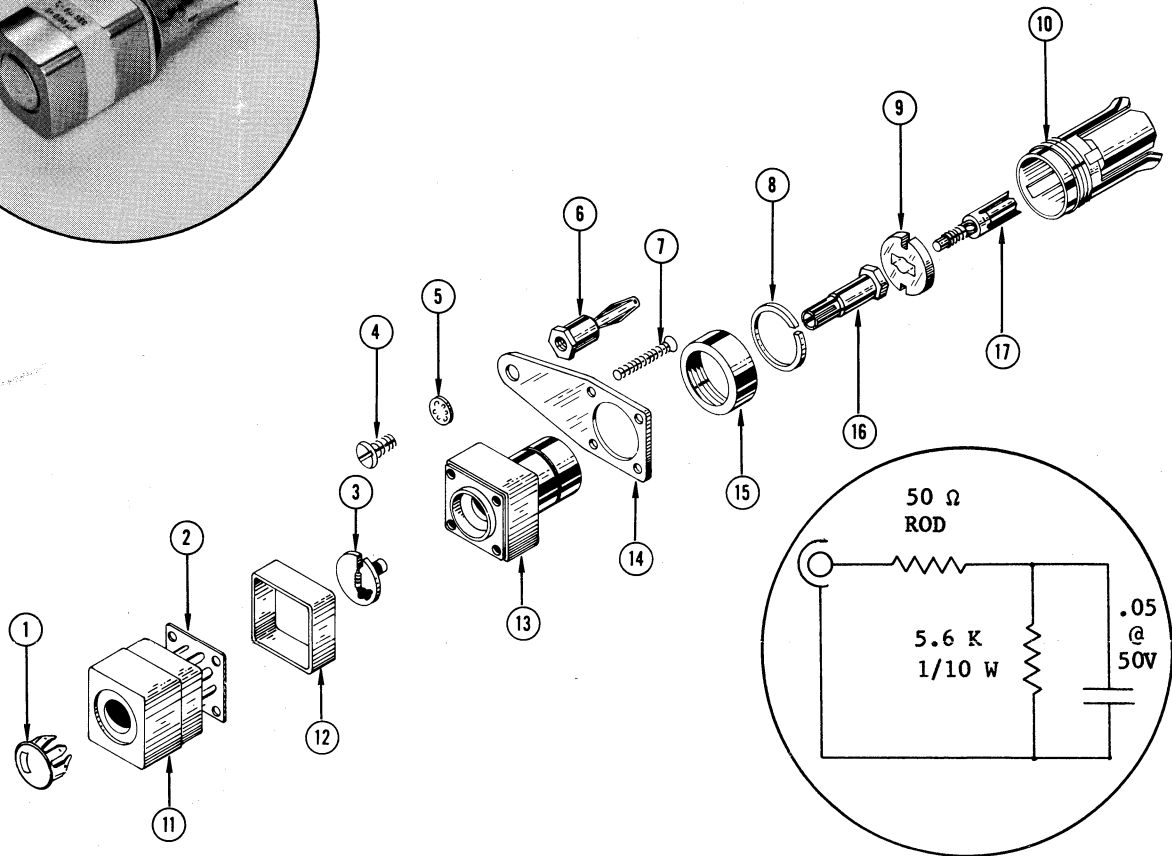
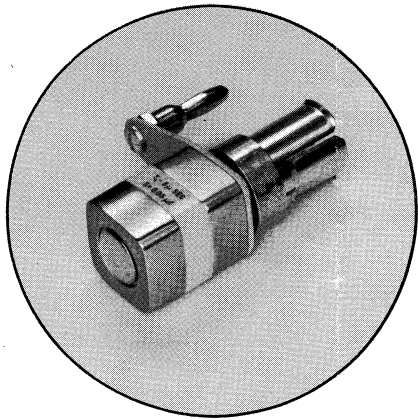

REF. NO.	PART NO.	SERIAL/MODEL NO.		QTY.	DESCRIPTION
		EFF.	DISC.		
1	134-026			1	PLUG, 3/8 inch diameter hole
2	344-056			1	CLIP
3	387-703			1	PLATE, disc
	283-064			1	CAPACITOR, .05 μ f, ceramic, 50 v
	307-079			1	RESISTOR, 50 Ω , carbon on ceramic rod
	317-562			1	RESISTOR, 5.6k, 1/10 w, 5%
4	211-507			1	SCREW, 6-32 x 5/16 inch, BHS
5	210-006			1	LOCKWASHER, #6 internal
6	134-013			1	PLUG, banana
7	211-076			4	SCREW, 2-56 x 5/8 inch, OHS
8	132-007			1	SNAP RING
9	132-028			1	INSULATOR
10	132-002			1	SLEEVE, conductor, outer
11	204-094			1	BODY, female
12	354-182			1	RING, indicator, white
13	204-145			1	BODY, male
14	406-768			1	BRACKET
15	132-001			1	NUT, coupling
16	358-088			1	BUSHING, resistor holding
17	132-029			1	INNER, CONDUCTOR

PUBLICATION NO.
062-105
May 1964
(Revised)

©, 1964, Tektronix, Inc.,
All rights reserved.

0-9-8

K4XL's **BAMA**

This manual is provided **FREE OF CHARGE** from the "BoatAnchor Manual Archive" as a service to the Boatanchor community.

It was uploaded by someone who wanted to help you repair and maintain your equipment.

If you paid anyone other than BAMA for this manual, you paid someone who is making a profit from the free labor of others without asking their permission.

You may pass on copies of this manual to anyone who needs it. But do it without charge.

Thousands of files are available without charge from BAMA. Visit us at <http://bama.sbc.edu>